

Adding Your School Email to an iPhone

1. Locate and click on the **Settings** button.



2. Locate and click on the **Mail** icon.



3. Click on **Accounts**.

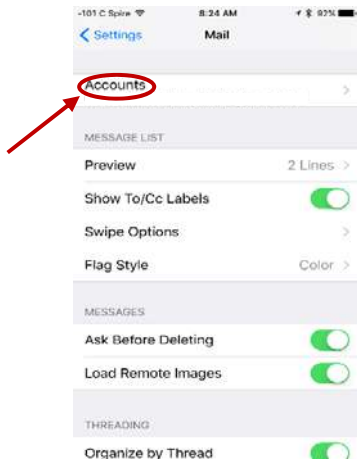

4. Click on **Add Account**.

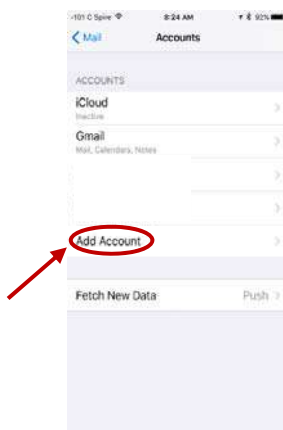

5. From the list of accounts, choose **Google**.

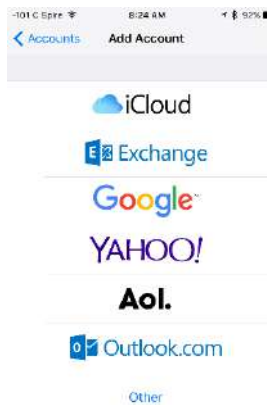

6. After you have keyed in your email address, click **Next**.

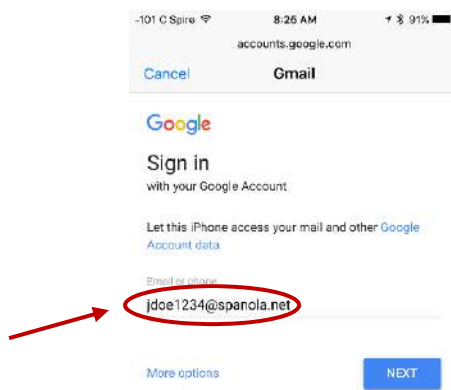

7. After you have entered your password, click **Next**.

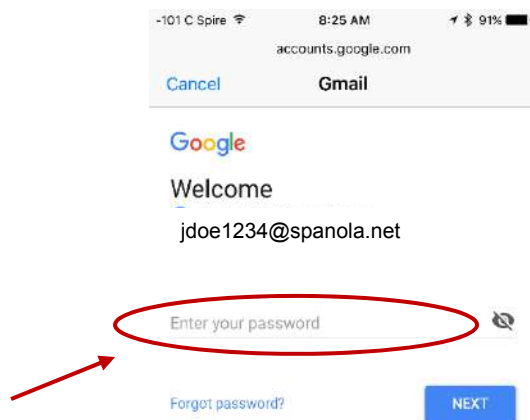

8. Choose to activate any or all of the choices you see on your screen. Then click **SAVE**.

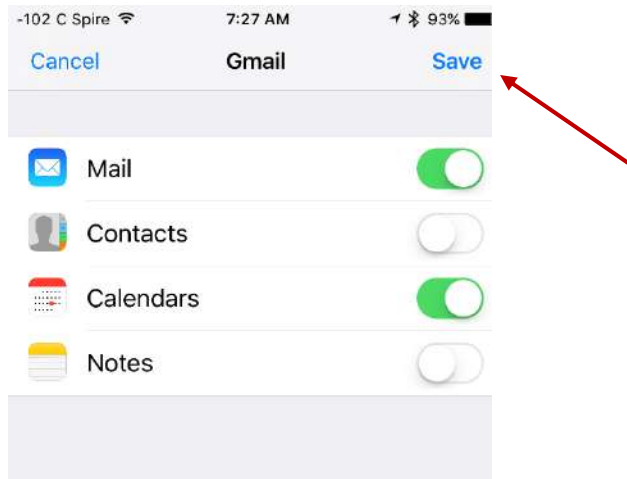

9. You have now successfully added your new email account to your iPhone!