

Franklin School Reopening Plan 2020-2021 Academic Year

RISE UP TOGETHER



Amy Panitch, Principal

Jonathan Olavarria, Vice Principal

Theresa Finkelstein, Vice Principal

Franklin School Reopening Plan

<u>Pandemic Response Team</u>	p. 2
<u>Health and Safety Procedures</u>	p. 3
<u>Visitor Policy</u>	p. 6
<u>Cleaning/Sanitizing</u>	p. 7
<u>Meals & Food Distribution</u>	p. 8
<u>Social Emotional Learning</u>	p. 9
<u>Multi-Tiered Systems of Support</u>	p. 10
<u>Wraparound Supports</u>	p. 11
<u>Leadership and Planning</u>	p. 12
<u>Continuity of Learning</u>	p. 13
<u>Professional Development Considerations</u>	p. 14

Franklin's Remote Learning Plan

Pandemic Response Team

Amy Panitch	Principal	973-268-5251 apanitch@nps.k12.nj.us
Jonathan Olavarria	Vice Principal Safety Team Staff Member	973-350-5074 jolavarria@nps.k12.nj.us
Theresa Finkelstein	Vice Principal SEL Team Staff Member	973-268-5039 trozek@nps.k12.nj.us
Mary Budhi	Nurse	973-268-5253 mbudhi@nps.k12.nj.us
Elisa Parr	Social Worker	973-268-5257 eparr@nps.k12.nj.us
Rozlyn Dreher	Child Study Team	973-350-5072 n1johnson@nps.k12.nj.us
Andrea Hayes	Special Education Teacher	973-268-5250 a1hayes@nps.k12.nj.us
Isabel Abreu	5th Grade Teacher	973-268-5250 iabreu@nps.k12.nj.us
Arlenita Fitzhugh	1st Grade Teacher	973-268-5250 afitzhugh@nps.k12.nj.us
Carmen Madera	Prek Teacher	973-268-5250 cmadera@nps.k12.nj.us
Tracy Blazquez	Teacher Coach	973-268-5250 tblazquez@nps.k12.nj.us
Rosita Gonzalez	Academic Interventionist	973-268-5250 rgonzalez@nps.k12.nj.us
Elizabeth Martinez	Technology	973-268-5323 e1martinez@nps.k12.nj.us
William Collins	Head Custodian	973-268-5255 wcollins@nps.k12.nj.us

Health and Safety Procedures



Facemasks

- Wearing a face mask is **required for everyone** while on school or district grounds and on school buses
- No one will be allowed to enter the building without a mask.
- Students and staff must arrive at school with a mask.
- Face masks may be removed when using the restroom or during meal times **as long as social distancing is maintained.**
- Face masks may be removed if alone and the room is closed.
- Acceptable masks include disposable surgical masks or cloth masks.

Stay Home When Sick or Exposed to COVID-19

- Students and staff should stay home if they have:
 - Tested positive (viral test) for COVID-19
 - COVID-19 symptoms
 - Potential exposure to COVID-19
 - Recent close contact (being within 6 feet for at least 10 minutes) with a person with COVID-19 in the past 14 days.
 - Travelled to an area with high levels of COVID-19 transmission in the past 14 days

Entry Procedures

- Prior to entering any of our facilities or district grounds everyone must wear a mask and undergo a **four step process** which includes the following.
 - Step 1: **Symptoms Screening** – Employees and students will be asked a series of questions regarding their health.
 - Step 2: **Temperature Check** – Employees and students will have their temperature checked using a non contact thermometer. Anyone with a **temperature of 100.4 degrees or higher will not be permitted into the building.**
 - Step 3: **Footwear Sanitizing** – Employees and students will stand in a rubber tub with disinfectant solution to sanitize their shoes. (**Everyone must wear closed shoes.**)
 - Step 4: **Hand Washing/Sanitizing** – Employees and students will be provided foaming hand sanitizer or will wash their hands with soap and water before entering the building.
- Bus students will be screened for symptoms at the school
- Trained staff will be required to arrive early to check and set up testing stations.
- Staff will be screened at the main entrance

Student Flow

-

Arrival	
*staggered times	4th- 6th grade -8:05 (8:15 enter building) 2nd - 3rd grade - 8:15 (8:25 enter building) Prek-1st - 8:30

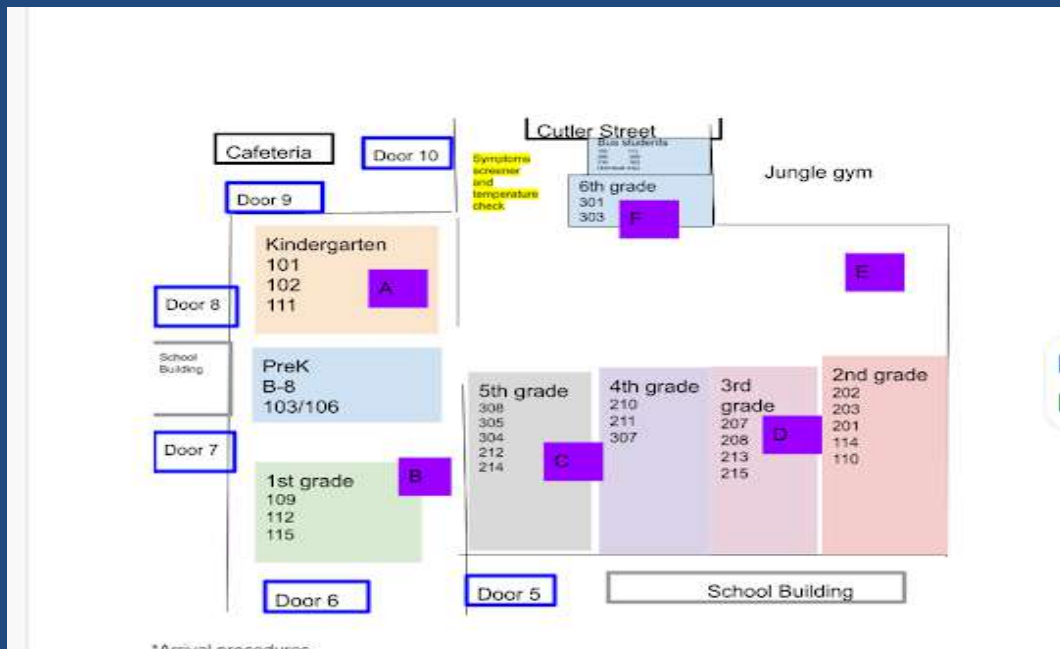

*students will line up by homeroom after symptom and temperature check. There will be markers for them to remain 6 feet apart from each other

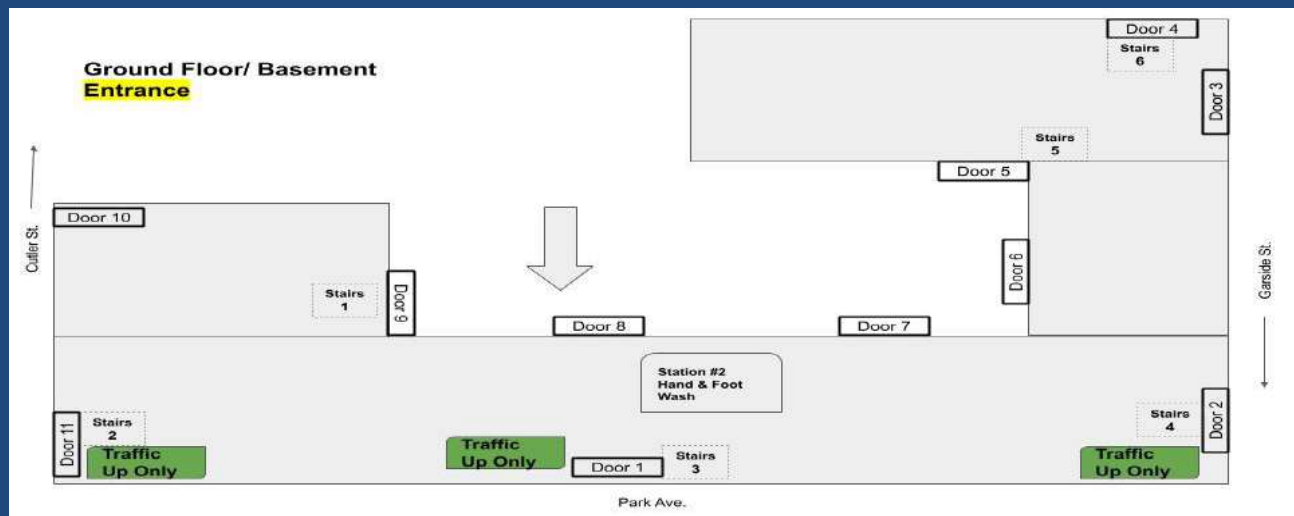

Dismissal	
Staggered times <ul style="list-style-type: none"> • Prek-1st: 1:15 • 2nd-3rd: 1:25 • 4th-6th: 1:30 	<u>Prek -1st - 1:10</u> <ul style="list-style-type: none"> • Prek- Door 7 • Kinder - Door 8 • 1st grade -Door 6 <u>2nd - 3rd grade - 1:20</u> <ul style="list-style-type: none"> • 2nd - Door 9 • 3rd - Door 5 <u>4th - 6th grade - 1:30</u> <ul style="list-style-type: none"> • 4th - Door 7 • 5th - Door 11 • 6th - Door 2

*Dismissed at different doors by grade level

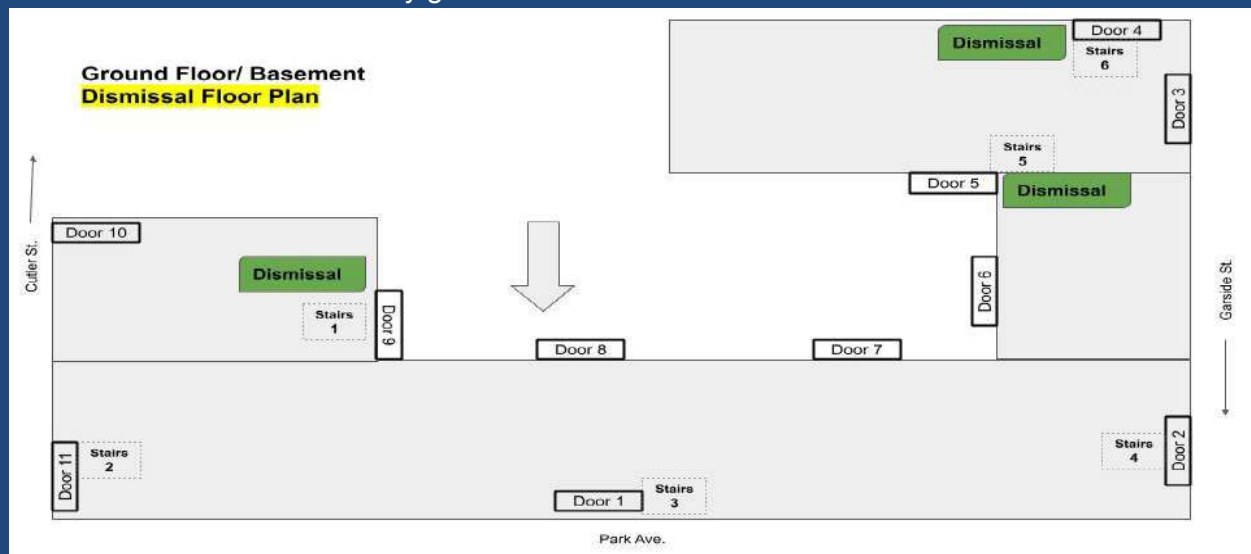

Classroom Guidelines

- Cohorts of students stay together and are with the same teacher throughout the school day
- Cohorts do not intermingle
- There will be a maximum 10 students in each class
- Student desks will all face the same direction and will be 6 ft apart.
- Students will not share any materials
- Desktop dividers on all student desks
- Signage posted throughout the school to promote social distancing and hand sanitizing.

Common Area Protocols (Gym, Cafeteria, Auditorium, etc.)

- These spaces will be used as additional classrooms for social distancing (if necessary)

Student Movement and Hallway Traffic Procedures

- Main stairwell will be used for going upstairs only
- All other stairwells will be used for going downstairs only
- All staff and students will **walk to the right** in every hallway

Response to students arriving to school with symptoms

- Given the serious health concerns, the parent/guardian(s) MUST adhere to a policy of response, availability and pickup of the ill child.
- Contact parent
- Isolation room (room 107)

Response to students displaying symptoms during the school day

- Contact parent
- Isolation room (office adjacent to nurse's office)
 - clear guidelines that dictate the criteria for assignment to an isolation room.
 - Personal protective equipment (PPE) for staff will be provided at all times
 - Siblings in other classes will need to quarantine as well

Visitor Policy



Protocols/Procedure

- **No outside visitors or random parent visits** be permitted within the school confines or classrooms.
- Students may not be picked up early unless it is an emergency.
 - Please schedule medical appointments and other services after instructional time. If, in a rare case, a student needs to be picked up during the day, the **parent will be asked to wait outside of the school and the student will be brought outside.**
- Adults authorized to pick up students ideally should be restricted to one per family.
- Parent-teacher conferences will be conducted online or by phone.

Cleaning/Sanitizing



Protocols

- All classrooms/offices have a hydroxyl air purification system installed
- Increased frequency of cleaning all surfaces, including walls (up to height of students)
- Routinely clean and disinfect surfaces and objects that are frequently touched
- Drinking fountains are turned off
 - Staff and students should bring their own water
- Cleaning/sanitizing checklist will be completed by the personnel responsible for the cleaning
- All areas used by a sick person will be closed and not used again before cleaning and disinfection
- Custodians have been trained in using specialized equipment
- All surfaces will be cleaned with detergent/hydrogen peroxide cleaner
- Electrostatic equipment and misting sprays will be used throughout the building
- Foaming hand sanitizer will be available throughout the building and in every classroom
- **Student supplies will not be shared in the classroom.**
 - Each student will be provided with their own set of necessary supplies
 - Supplies will be kept in individual desks or bags and will not come in contact with other students' supplies.

Meals & Food Distribution



Breakfast

- Students will pick up upon entering the building.
- Buckets will be labeled with bagged items for each class.
- Students will grab and go from their selected bucket upon entry.

Snack

- Students in grades 3-6 will have a 20 minute snack break
- Weather permitting, teachers will bring students to eat outside

Lunch

- Students in grades 3- 6 will grab a bagged lunch as they dismiss at 1:30
- Students in grades Prek-2 will eat in their classrooms.
 - Weather permitting, they will eat outside

Social Emotional Learning



- Morning Meetings prior to the start of each lesson to facilitate opportunities for students to connect and reflect.
- Integrated Social and Emotional classroom lessons through the use of the 2nd Step Curriculum
- Student Support Staff will work with students to address their emotional and academic needs, including Social Workers, School Counselors, Attendance Counselors, etc.
- Refer to Franklin Falcon [SEL Communication Plan](#) to ensure vision and mission of SEL Program is carried out by all constituents.
- Refer to Franklin [Roadmap](#) during SEL leadership team to ensure goals are being met and adjustments are being made to support virtual learning
- Host monthly staff SEL Meetings, monthly SEL Leadership Team meetings and bi-weekly SEL Champ Teacher meetings to ensure the Implementation plan is fluid and meets the immediate needs of staff and students.
- [Virtual Spirit Weeks](#) will occur every week and will be a school-wide collaborative effort in designation of activities and events to keep staff and students engaged and motivated in learning.

Multi-Tiered Systems of Support



- Academic Interventions and Supports
 - K - 6 will be assessed utilizing the district screener, Lexia, and ALEKS data.
 - Small groups have been formed based on assessment data.
 - Designated Intervention time build in schedules for remote and in person instruction.
 - Each grade level has an identified staff member who pulls groups remotely in a virtual classroom.
 - Groups will remain fluid based on student needs formative assessment data and teacher input.
- Student Support and Behavioral Intervention
 - All Staff will be trained on SEL/PBIS practices outlined in the Falcon Handbook.
 - School-wide PBIS Falcon Bucks system has been implemented in school and virtually.
 - Schoolwide PBIS Falcon Buck assembly occurred to review expectations, and procedures for being safe, kind, and respectful in school and virtually.
 - K - 6 Implementation of SAEBRS (Social, Academic, Emotional, Behavior Risk Screener)
 - Survey Results support Tier 2 virtual groups.
 - K - 2 (Ms. Barerra)
 - 3 - 6 (Ms. Parr)
 - 3-6 Implementation of REthink
 - Survey Results support Tier 2 virtual groups with Ms. Parr

Wraparound Supports



- The district will continue to partner with organizations to provide resources to support students and families with wraparound services in the following areas:
 - Mental health supports (Jersey Cares, Greater Life, etc.)
 - Primary Health Care and Dental Care (JPMC, Rutgers Medical, etc.)
 - Family Engagement (ESL for adults, Surveys in multiple languages)
 - Academic Enrichment (Summer Programming, Extended School Day, etc.)
 - Mentoring (Mentor Newark, Leadership Newark, etc.)
 - Quarantine Tutors (free tutoring to support virtual learning)

Leadership and Planning



Schedule

- Sample Schedules

- **Pre - K**

8:45-9:30	Large Group Meeting
9:30 - 10:30	Choice Time
10:30 - 11:00	Read Aloud
11:00-11:30	Lunch
11:30- - 12:00	Gross Motor
12:00 - 12:30	Specials
12:30-1:00	Small Groups
1:00-1:10	Closing Meeting
1:10-1:30	Dismissal

- **Grade K - 2**

8:30-9:00	Morning Meeting/SEL
9:00-10:30	ELA
10:30-11:00	Specials
11:00-12:00	Math
12:00-12:30	Lunch
12:30-1:15	Science/ Intervention
1:15-1:30	Closing Meeting
1:30	Dismissal
2:00-3:00	Specials/ Asynchronous Work

○ **Grades 3-6**

8:30-8:45	Morning Meeting
8:45-10:30	ELA Block
10:30-12:15	Math/Science Block
12:15-12:30	Snack
12:30-1:00	Special
1:00-1:30	Closing Meeting
1:30	Dismissal
2:00-3:00	Specials/ Asynchronous Work

School Options

Plan A- Hybrid In Person

*depends on number of students returning to in-person instruction

- **2 days of in person instruction (Monday & Tuesday OR Thursday and Friday)**
- social distancing of 10 students per class
- Staggered arrival and dismissal times

Plan B- All Virtual

- Students will continue to attend school remotely
- Must follow attendance policy

****all in person students may need to go remote at anytime***

Continuity of Learning



Technology and Connectivity

- Every student will receive a chromebook
- Internet access will be provided as needed to students
- Parent/student responsibilities.
- Provide contact information for reporting technology issues.
 - Elizabeth Martinez
 - e1martinez@nps.k12.nj.us

Professional Development Considerations

- Professional development for staff, students and families.
 - Provide comprehensive professional development to staff in the areas of:
 - Health and Safety
 - Screening protocols
 - Contact tracing
 - Newly developed entry/exit patterns
 - New technology
 - Livestreaming synchronous lessons
 - Curriculum development
 - Assessing student learning gaps and designing interventions in the hybrid/virtual model
 - The Distance Learning Playbook
 - Themes of Visible Learning - Connection between Visible Learning and Distance Learning
 - Taking Care of Yourself
 - Classroom Management/Culture and Set up in face to face r vs.Virtual
 - Planning
 - Student Engagement
 - Distance Learning
 - SEL
 - Teacher Resilience series I & 2
 - Optimistic Thinking series I & 2
 - Mindfulness series I & 2
- Provide comprehensive training to students and families in the areas of:
 - Health and safety
 - Screening protocols
 - Contact tracing
 - Newly developed entry/exit patterns
 - New technology
 - Supporting students in a hybrid instruction model
 - Material distribution
 - Special education students and hybrid learning
 - English language learners and hybrid learning
 - Establishment of School-wide expectations, norms, and protocols both in school and virtual.
 - Establishment of School-wide morning meetings and check ins.
 - 2nd Step Lessons in school and virtual
 - Lesson from Falcon SEL Handbooks
 - **Families**
 - bi-monthly SEL workshops designed around parent interest surveys

- **Topics for August and September.**
 - Staff SEL
 - “Why” Drives Everything [Video](#)
 - The First Days of School
 - Reviewing Procedures and Protocols for in person and virtual instruction
 - Setting the Bar
 - Acceleration over Remediation
 - Building Teacher/Student Relationships
 - Norms, Protocols, Procedures, and Class Agreements
 - Learning Intentions/Success Criteria
 - Reviewing Priority
 - Achieve the Core: [Instructional Considerations for 2020](#)
 - Learning Environment - Face to Face Vs. Virtual
 - Expectations
 - Must Haves
 - Digital Platforms
 - Google Classroom
 - Webex
 - Screencastify
- **Format for all professional development (virtual).**
 - Webex

