

ESHS Policies and Procedures for Hybrid Learning April 2021

As per Superintendent Leon, hybrid learning will begin on April 12, 2021. Students and families will receive a survey from Newark Public Schools and from East Side High School to indicate whether they would like to opt their child in for hybrid learning. Students and families can also choose to continue learning remotely from home Monday through Friday. Starting April 12, 2021, East Side will follow a [Hybrid Learning Schedule](#).

East Side High School will have one cohort of students who will participate in a hybrid setting. Currently, there are 350 students who have chosen to learn in-person at East Side. All students participating in the Hybrid Cohort will report to East Side on Monday, Tuesday, Thursday and Friday. All staff and students will work & learn remotely on Wednesdays while the building is cleaned and disinfected.

Please be guided by the following protocols and procedures for hybrid learning at East Side High School:

Ingress/Egress Procedures:

- East Side will adhere to CDC Guidelines. Upon entrance, students will receive a temperature check, and will be required to sanitize hands and shoes. If students show a temperature of **100.4** or greater, they will be directed to Isolation Room 106 via Door #22. Parents/guardians will be called and notified to pick up their child.
- All faculty and staff will also have their temperature taken upon entrance, sanitize hands and shoes, and complete a [COVID-19 questionnaire](#). All faculty and staff must submit a negative COVID-19 test prior to their April 12th return.
- Each grade level will have a designated entrance and exit, and will be assigned to a specific section of the building. Students can begin entering through their assigned door at 8:00 am. Doors will close at 8:30 am, at which time students will be redirected to learn remotely from home that day.
- [This is a breakdown of grade-level locations and designated hybrid classrooms.](#)
 - **Ninth Grade students** will enter through Door #27 on Nichols Street and proceed to their assigned hybrid pod in the A building. They will also exit from Door #27.
 - **Tenth Grade students** will enter through Door #29 on Nichols Street and proceed to their assigned hybrid pod in the C Building, 2nd Floor. They will also exit from Door #29.
 - **Eleventh Grade students** will enter through Door #22 on Pulaski Street and proceed to their assigned hybrid pod in the C Building, 4th Floor. They will also exit through Door #22.
 - **Twelfth Grade students** will enter through Door #12 on Pulaski Street and proceed to their assigned hybrid pod in the B Building. They will also exit through Door #12.

Policies and Procedures to ensure student and staff safety during hybrid learning:

- **Students and staff will maintain 6 feet of distance** from others when inside the building. Classrooms are arranged according to CDC guidelines, with no more than ten students per room. Desks have been equipped with partitions, and are arranged 6-feet apart.
- All students participating in hybrid learning will receive a clear backpack, an ESHS face mask, an ESHS water bottle, and a set of headphones with mic. The clear backpack is to be used in order to make the

entrance procedure as smooth and quick as possible. Students will be required to bring their Chromebook and headphones each day.

- Students will remain in their assigned **hybrid pod** location from 8:00 am-1:30 pm. Students will attend all classes virtually (in Webex via Chromebook) from their hybrid pod location.
- **Students and staff will be required to wear a facemask AT ALL TIMES** while inside East Side High School. This means students will be required to wear a facemask upon entry at 8:00 am, until they leave the building at 1:30 pm.

Breakfast and Lunch Distribution:

- Students will pick up a bagged breakfast upon entering school and proceed to their assigned hybrid pod.
 - Cafeteria Staff will begin distributing bagged breakfasts to each entrance at 7:30 am.
 - Entrance doors will open to students at 8:00 am.
 - Security will assist with breakfast distribution at each entrance.
- Students will be dismissed by grade level from assigned ingress/egress doors and will be provided with a bagged lunch.
 - Cafeteria Staff will distribute bagged lunches to each exit by 1:00pm.
 - Students will pick up bagged lunch when exiting the school at 1:30 pm.
 - Security will assist with lunch distribution at each exit.

Contingency Plans:

- **In all matters** related to positive COVID-19 cases, report to ESHS Pandemic Response Team (Dr. Santos, Mr. Rodriguez, ESHS nurses). Further instruction then comes from the district.
- If students show a temperature of 100.4 or greater, they will be directed to Isolation Room 106 via Door #22. Parents/guardians will be called and notified to pick up their child.
- If a student or staff member becomes ill or experiences COVID-like symptoms during the day, contact security and they will assist the student in reporting immediately to Isolation Room 106.
- [Fire Drill/Alarm Procedures](#)

Ingress/Egress Maps:

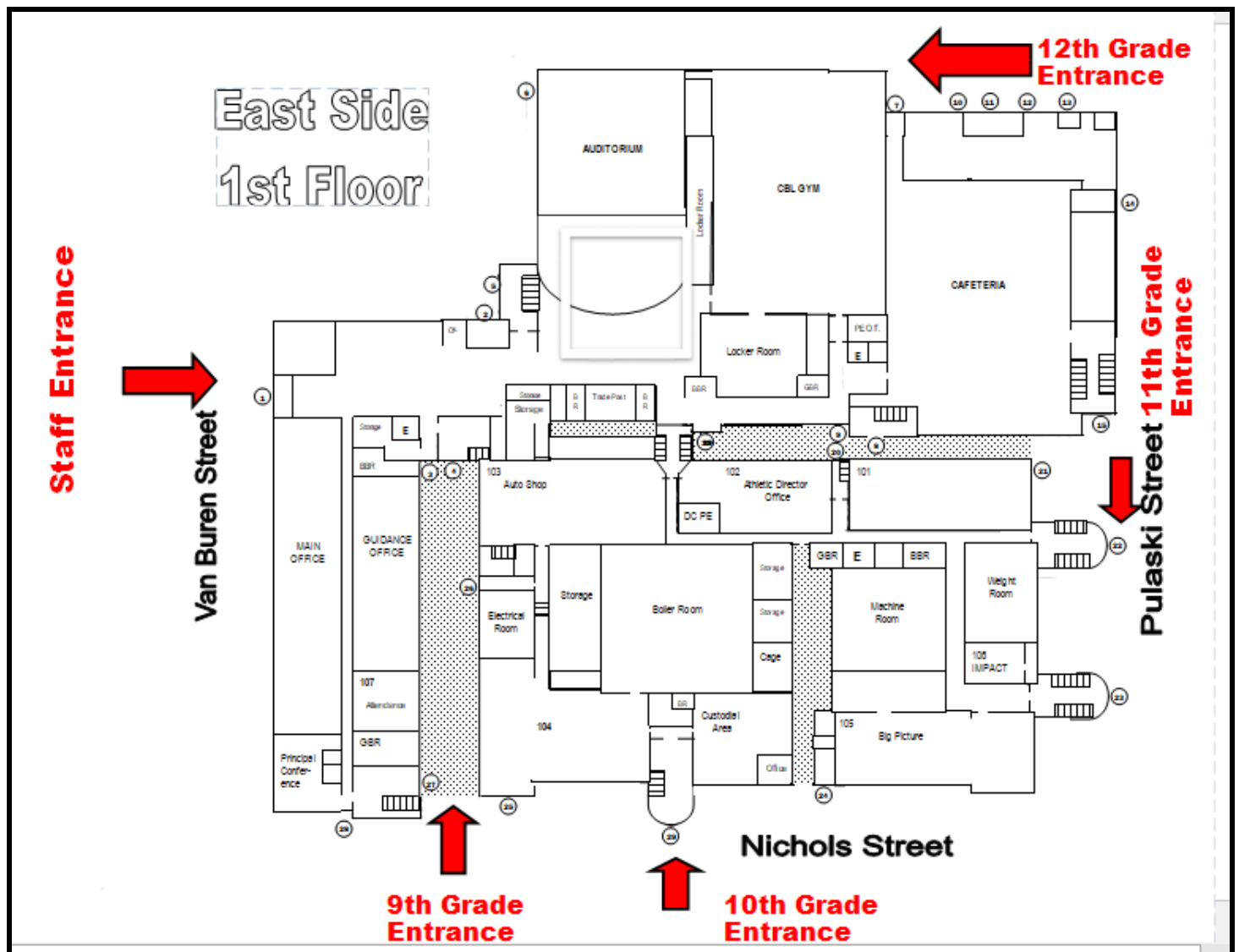

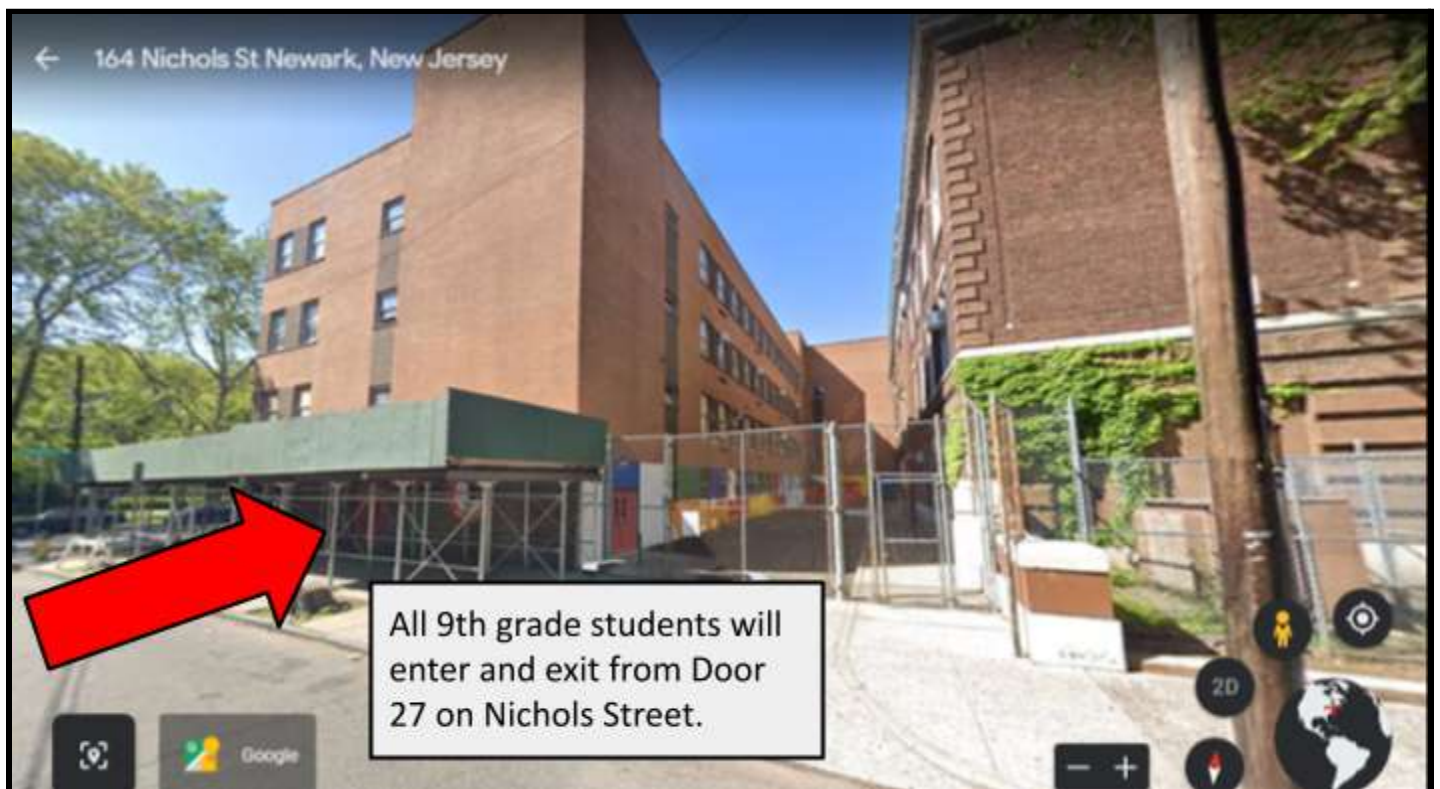

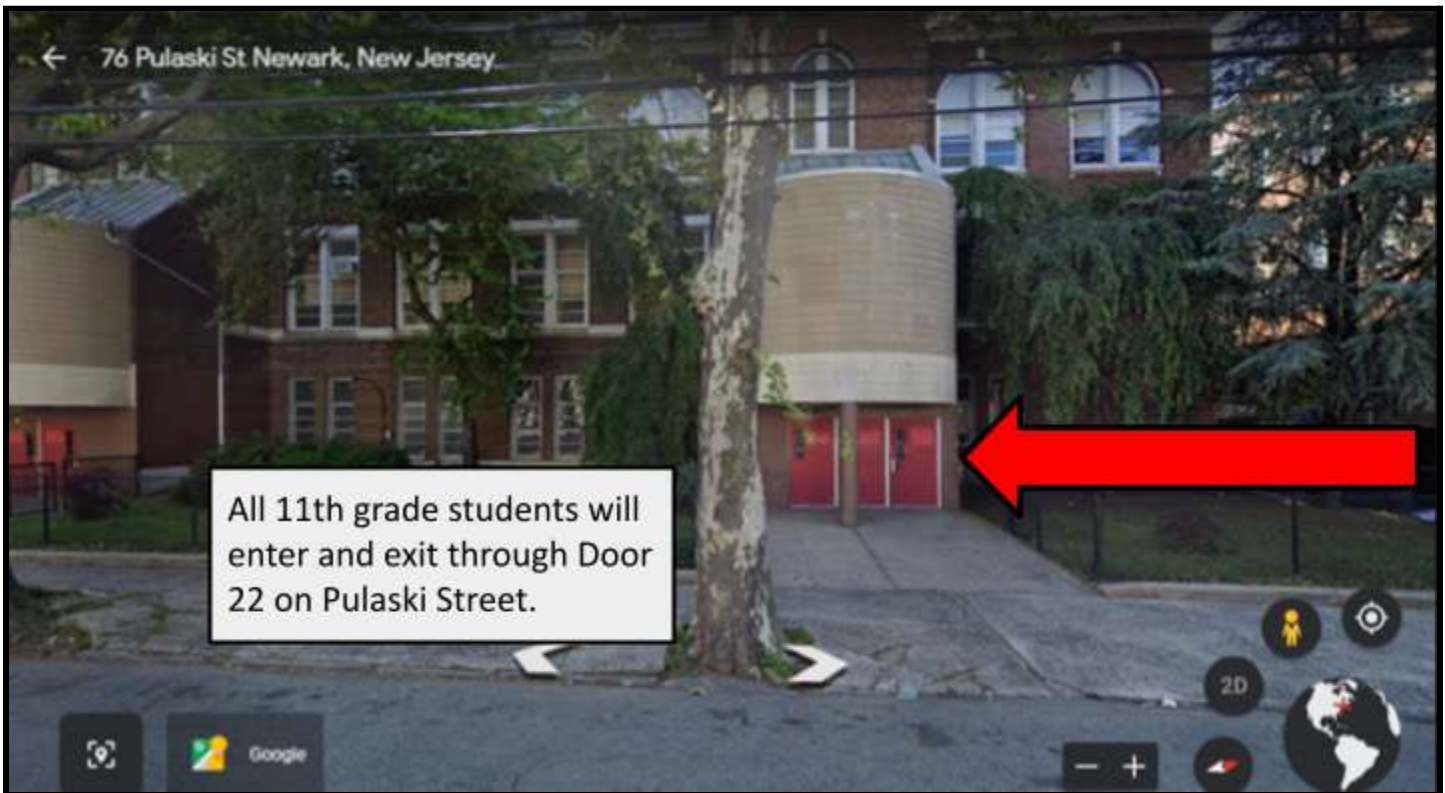



ESHS HYBRID SCHEDULE starting April 12, 2021

A Day						ALW			B Day				
	Start	End	Class	Passing		*All staff and students will be remote for cleaning & disinfecting			Start	End	Class	Passing	
HR	8:15	8:55	40	5				HR	8:15	8:55	40	5	
1	9:00	9:50	50	5				5	9:00	9:50	50	5	
2	9:55	10:45	50	5		ALW schedule will still be followed		6	9:55	10:45	50	5	
3	10:50	11:40	50	5				7	10:50	11:40	50	5	
4	11:45	12:35	50	5				8	11:45	12:35	50	5	
WELL	12:40	1:30	50					9	12:40	1:30	50	5	
Lunch /Prep	1:30	2:30	60					Lunch/ Prep	1:30	2:30	60		
Office Hours	2:30	2:50	20					Office Hours	2:30	2:50	20		