

Educational Foundation Donor Recognition Wall Located in New London-Spicer Performing Arts Center

It is our mission to enhance the quality of education in the New London-Spicer School District by helping to fund programs that benefit all students.

Since the establishment of the Foundation in 2006, we have awarded grants for programs and projects that engage students and enhance the STEAM curriculum. On average, we annually fund \$10,000 in teacher grants and an additional \$2,500 in the form of Merit Scholarships. For this initiative, we have set a goal to grow the endowment to \$890,000. Paired with annual giving, we could substantially increase our education-enhancing grants and scholarships! Join us in promoting innovative lessons & activities that shape our children's minds. To view previously funded grants, please visit: www.nls.k12.mn.us/educationalfoundation

Donor Wall Tiers	Rate
PLATINUM TIERED DONORS	\$50,000.00
GOLD TIER DONORS	\$25,000.00
SILVER TIER DONORS	\$15,000.00
BRONZE TIER DONORS	\$5,000.00
TITANIUM TIER DONORS	\$1,000.00
Seat Dedication (650)	\$250.00 per seat
Recognition installments will remain as permanent fixtures within the Performing Arts Center. Pledging options available for donors wishing to spread out their contributions over several years.	

Please make checks payable to the **New London-Spicer Educational Foundation** and return to the address below.



New London-Spicer Educational Foundation

P.O. BOX 58 New London, MN 56273

Please return the attached donation form with your payment.

Deepest thanks to all the community organizations, corporations, school employees, parents, and other generous individuals who have supported the Educational Foundation.

New London-Spicer Educational Foundation is a 501(c)(3)

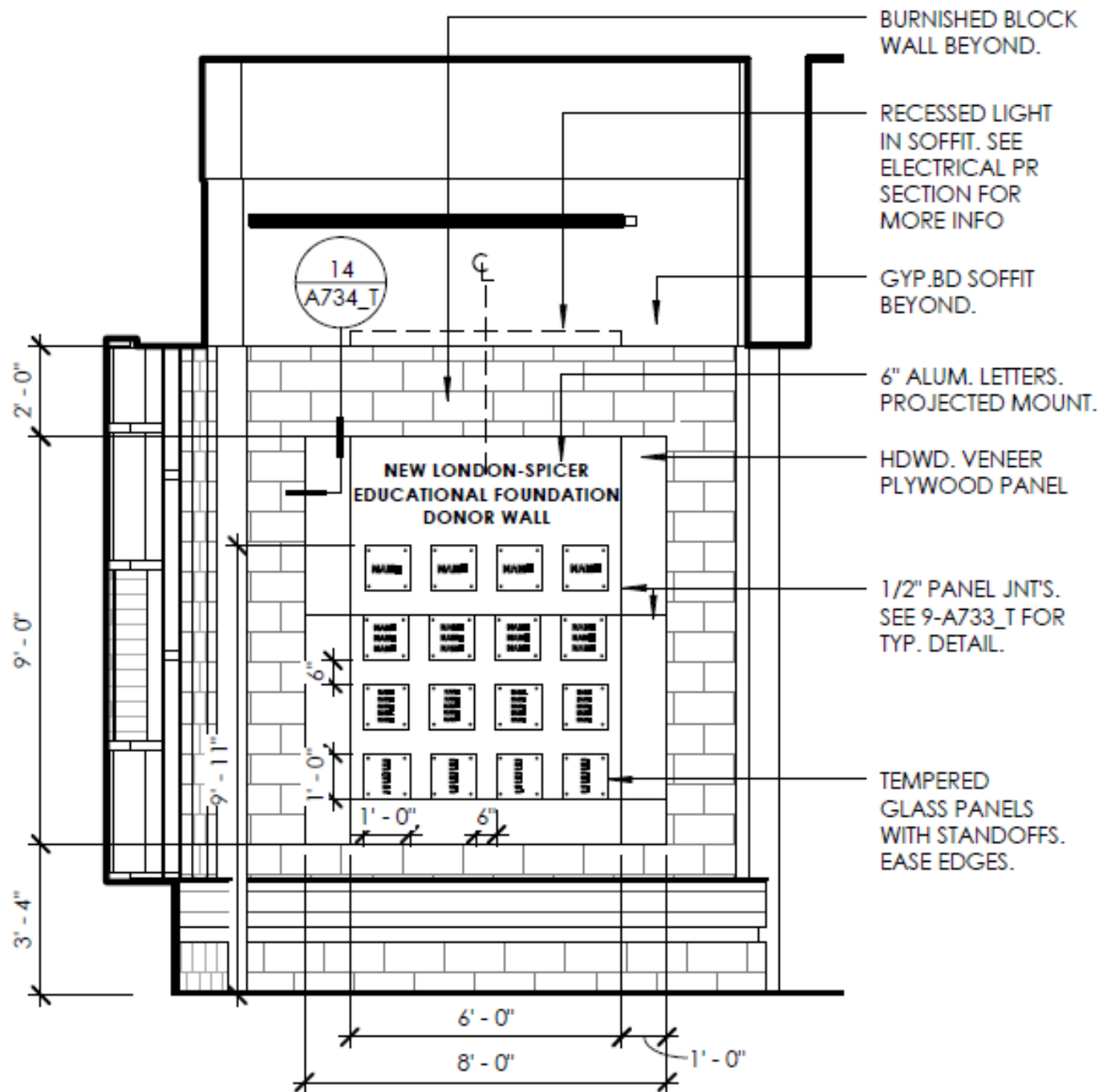

New London-Spicer Educational Foundation is a 501(c)(3)

New London-Spicer Educational Foundation Endowment Donor Recognition Wall Form:

Contact Name

Company Name, if Applicable

Name to be Displayed

☐ Yes, I will email our logo to nlsedfoundation@isd345.org to be used in materials where donors are listed.

☐ \$50,000 ☐ \$25,000 ☐ \$15,000 ☐ \$5,000 ☐ \$1,000 ☐ Send Pledge info

Mailing Address

City, State, Zip

Email Address

Phone Number

Make Checks Payable to:
New London-Spicer Educational
Foundation

Mail Checks and Enrollment Form to:
PO BOX 58 | New London, MN 56273

To Pay by Credit Card:
<https://www.nls.k12.mn.us/Page/358>

Follow Prompts, if you have questions
request Online Pay Step by Step
Instructions from the Foundation.



Questions? Contact:

Megan Norgren, Executive Director | New London-Spicer Educational
Foundation NorgrenM@isd345.org | 320.354.2252 Ext. 2422

New London-Spicer Educational Foundation is a 501(c)(3)