

Abbreviations

A/C	AIR CONDITIONING	MEP	MECHANICAL, ELECTRICAL & PLUMBING
ACP	ACOUSTICAL PANEL	MEZZ.	MEZZANINE
ACT.	ACOUSTICAL TILE	M.H.	MAN-HOLE
A.D.	AREA DRAIN	MIN.	MINIMUM
A.D.A.	AMERICANS WITH DISABILITIES ACT (2010)	MISC.	MISCELLANEOUS
ADJ.	ADJUSTIBLE	M.O.	MASONRY OPENING
A.F.F.	ABOVE FINISH FLOOR	MOD.	MODULE
A.F.G.	ABOVE FINISH GRADE	MTL.	METAL
ALUM	ALUMINUM	M.T.P.	METAL TOILET PARTITIONS
ALT.	ALTERNATE	N.D.	NAPKIN DISPOSAL
Z.	ANGLE	N.I.C.	NOT IN CONTRACT
ASPH.	ASPHALT	NO.	NUMBER
		N.T.S.	NOT TO SCALE
		N.V.	NAPKIN VENDOR
BD.	BOARD		
BLDG.	BUILDING	O.C.	ON CENTER
BLK.	BLOCK	O.D.	OUTSIDE DIAMETER
BM.	BEAM	O.F.C.I.	OWNER FURNISHED, CONTR. INSTALLED
B.U.R.	BUILT-UP ROOF	OH.	OPPOSITE HAND
		OPNG.	OPENING
C	CHANNEL	OPP.	OPPOSITE
CAB, CABT	CABINET		
CFMF	COLD FORMED METAL FRAMING		
C.J.	CONTROL JOINT	PEMB	PRE-ENGINEERED METAL BUILDING
C	CENTER LINE	P.C.	PRECAST
CLG.	CEILING	P.H.	PAPER HOLDER
C.M.U.	CONCRETE MASONRY UNIT	PL.	PLATE
COL.	COLUMN	P.L.	PROPERTY LINE
COMP.	COMPRESSIBLE	PLAS.LAM.	PLASTIC LAMINATE
CONC.	CONCRETE	PLUMB.	PLUMBING
COND.	CONDITION	PLWD.	PLYWOOD
CONT.	CONTINUOUS	POL.	POLISHED
CORR.	CORRIDOR	P.P.	POWER POLE
CPT	CARPET	PR.	PAIR
CT	CERAMIC TILE	PT.	POINT
CTSK.	COUNTERSINK	PTD.	PAINTED
C.W.	COLD WATER	P.W.B.	PREFINISHED WALL BOARD
		QT	QUARRY TILE
		R	RADIUS
D.F.	DRINKING FOUNTAIN	RD	ROOF DRAIN
DIA.	DIAMETER	RE	REFERENCE
DIM.	DIMENSION	RECP.	RECEPTACLE
D.P.	DAMP PROOFING	REINF.	REINFORCE
DTL	DETAIL	RES.	RESILIENT
D.S.	DOWNSPOUT	RTT	RESILIENT TERRAZZO TILE
DWG.	DRAWING	REQ., REOD.	REQUIRED
		REV.	REVISED
EA.	EACH	RF	RECREATIONAL RESILIENT FLOORING
EDF	ELECTRIC DRINKING FOUNTAIN	RPG	RELOCATABLE PAINTED GYPSUM BOARD
EL.	ELEVATION (HEIGHT)	R.S.S.	ROD STOCK AND SEALANT
ELEC., ELECT.	ELECTRICAL		
ELEV.	ELEVATION (DRAWING)		
E.J.	EXPANSION JOINT	SC	SEALED CONCRETE
EQ.	EQUAL	SCH., SCHED.	SCHEDULE(D)
EQUIP	EQUIPMENT	SCPL	SOLID CORE PLASTIC LAMINATE
EXIST.	EXISTING	S.D.	SOAP DISPENSER
EXP.	EXPANSION	SEC.	SECTION
EXT.	EXTERIOR	SHT.	SHEET
		SIM.	SIMILAR
FB	FACE BRICK	SPC	SPECIAL COATING SYSTEM
FD	FLOOR DRAIN	SPEC., SPECS.	SPECIFICATIONS
F.E.	FIRE EXTINGUISHER	SQ.	SQUARE
F.E.C.	FIRE EXTINGUISHER CAB.	S.S.	SOUND STRIP
F.H.C.	FIRE HOSE CAB.	SS, ST. STL.	STAINLESS STEEL
FIN.	FINISH	STL.	STEEL
FKT.	FIXTURE	STR., STRUCT.	STRUCTURAL
FLR.	FLOOR	SUSP.	SUSPENDED
FLSHG.	FLASHING	SVF	SHEET VINYL FLOORING
FLUOR	FLUORESCENT	SVDF	SHEET VINYL DANCE FLOORING
GA.	GAUGE		
CALV.	GALVANIZED	T.B.	TACK BOARD
G.B.	GRAB BAR	T.D.R.	TOWEL DISPENSER AND RECEPTACLE
GCMU	GLAZED CONCRETE MASONRY UNIT(S)	TEL.	TELEPHONE
GEN.	GENERAL	TERR.	TERRAZZO
GFRC.	GLASS FIBER REINFORCED CONCRETE	THK.	THICK
G.I.	GALVANIZED IRON	T.O.	TOP OF
GL.	GLASS	T.O.B.	TOP OF WOOD BLOCKING
GR.	GRADE	T.O.M.	TOP OF MASONRY
GTP	GLAZED TILE PAVER(S)	T.O.S.	TOP OF STEEL
GYP.	GYPSUM	T.T.D.	TOILET TISSUE DISPENSER
		TYP.	TYPICAL
HC	HANDICAPPED ACCESSIBLE		
HGT.	HEIGHT	UL	UNDERWRITERS LABORATORIES
HM	HOLLOW METAL	U.N.O.	UNLESS NOTED OTHERWISE
HORIZ.	HORIZONTAL	UR.	URINAL
H.W.	HOT WATER		
		V	VENT
I.D.	INSIDE DIAMETER	V.C.T.	VINYL COMPOSITION TILE
INSUL.	INSULATION	VENT.	VENTILATING
INT.	INTERIOR	VER.	VERIFY
I.P.S.	IRON PIPE SIZE	VERT.	VERTICAL
		VGB	VERTICAL PREFINISHED VINYL CLAD GYP. BD.
JT.	JOINT		— RELOCATABLE WALL PANEL
		V.I.F.	VERIFY IN FIELD
LAM.	LAMINATE	VWC	VINYL WALL COVERING
LAV.	LAVATORY		
L.P.	LIGHTPOLE	W/	WITH
LT	LIGHT	W.C.	WATER CLOSET
LT. WT.	LIGHT WEIGHT	WD.	WOOD
		WDW.	WINDOW
MANUF., MFR.	MANUFACTURER	W.P.	WATERPROOFING
MAS.	MASONRY	W.S.	WEATHERSTRIP
MATL.	MATERIAL	WT.	WEIGHT
MAX.	MAXIMUM	W.W.	WATER WELL
MB	MARKER BOARD	W.W.F.	WELDED WIRE FABRIC
MECH.	MECHANICAL		
MEM. W.P.	MEMBRANE WATERPROOFING		

Drawing Index

SHEET NO.	PRODUCTION DOCUMENTS
GENERAL	
G0.01	COVER DRAWING INDEX LOCATION MAP
ARCHITECTURE	
A1.00	ARCHITECTURAL SITE PLAN
CIVIL	
C1.00	DEMOLITION PLAN
C3.00	GRADING PLAN

CROCKETT EARLY CHILDHOOD CENTER PHASE II

ENNIS INDEPENDENT SCHOOL DISTRICT

ARCHITECT
PBK ARCHITECTS, INC.
14001 DALLAS PKWY, SUITE 400
DALLAS, TEXAS 75240
(972) 233-1323

CIVIL ENGINEER
HART GAUGLER
12801 N CENTRAL EXPY #1400,
DALLAS, TX 75243
T (972) 239-5111

KEY PLAN

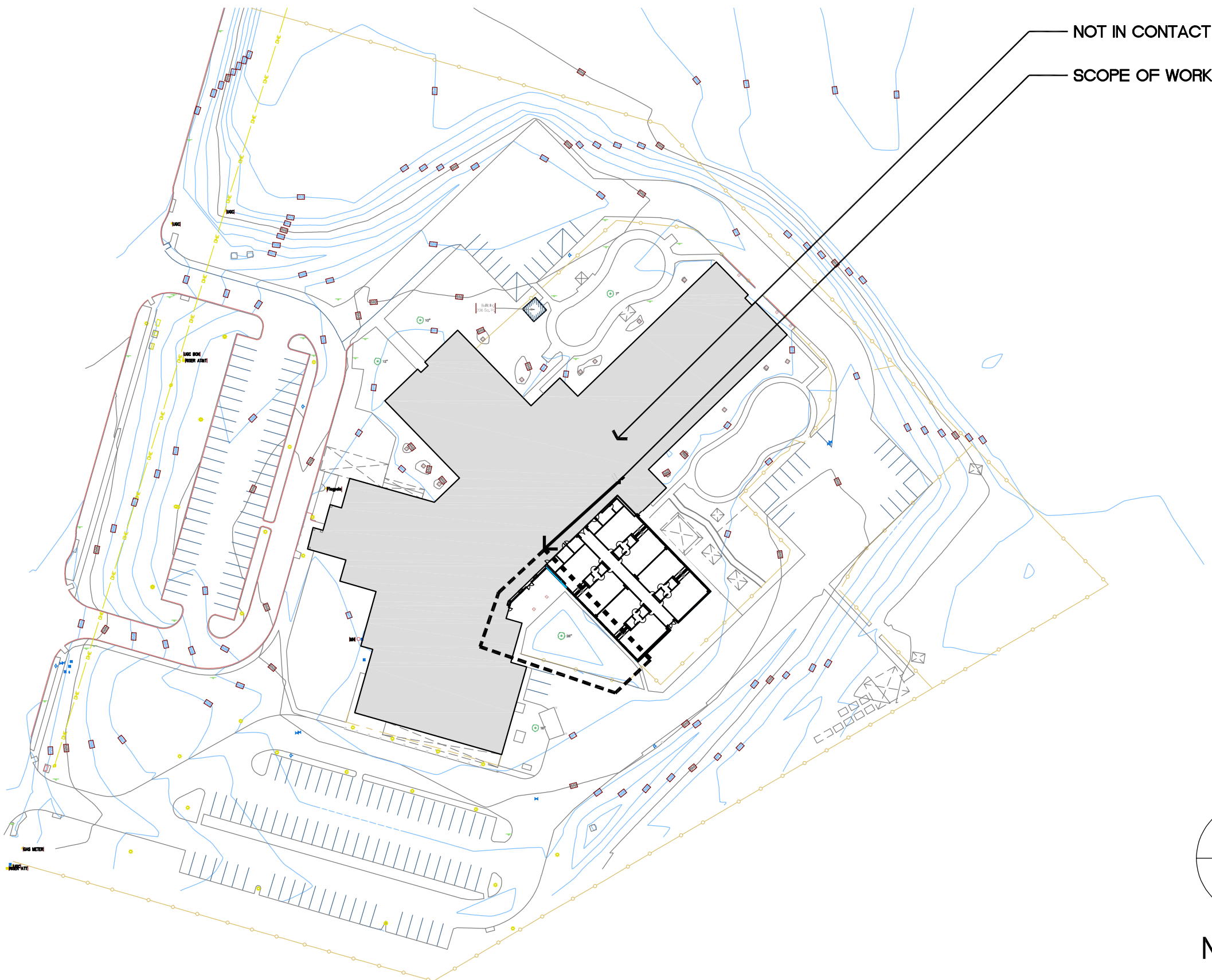

LOCATION MAP

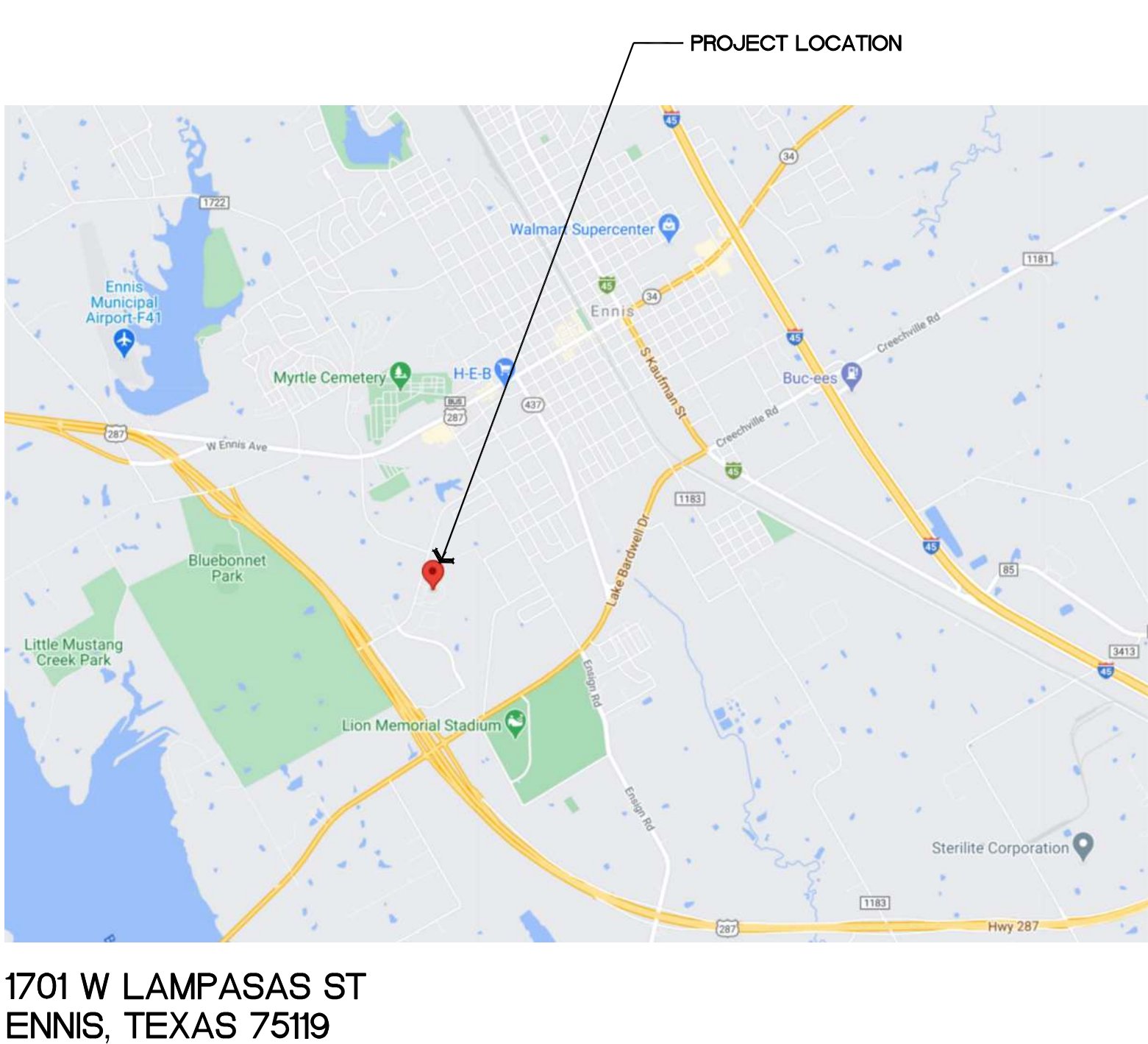

1701 W LAMPASAS ST
ENNIS, TEXAS 75119

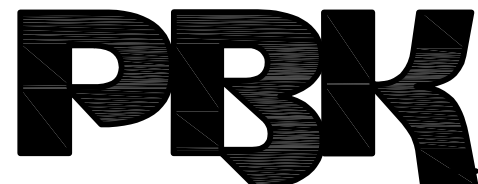

14001 Dallas Parkway
Suite 400
Dallas, TX 75240
972-233-1323 P
972-233-1373 F
TX Firm: F-3709
PBK.com



CROCKETT EARLY
CHILDHOOD CENTER
PHASE II
ENNIS INDEPENDENT SCHOOL DISTRICT
ENNIS, TEXAS



CLIENT: ENNIS INDEPENDENT SCHOOL DISTRICT		
PBK PROJECT NUMBER: P2100900AR		
DATE: 01/29/2021		
DRAWN BY: FM		
CHECKED BY: RL		
REVISIONS		
No.	Description	Date
FOR REVIEW		
COVER DRAWING INDEX LOCATION MAP		
G0.01		



14001 Dallas Parkway
Suite 400
Dallas, TX 75240
972-233-1323 P
972-233-1373 F
TX Firm: F-3709
PBK.com



CROCKETT EARLY
CHILDHOOD CENTER
PHASE II
ENNIS INDEPENDENT SCHOOL DISTRICT
ENNIS, TEXAS

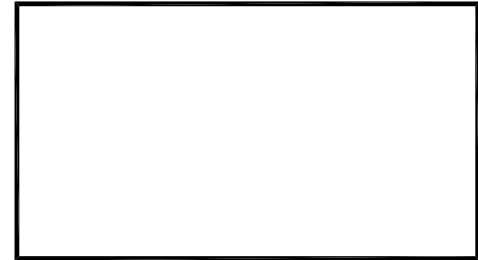

01/29/2021

CLIENT: ENNIS INDEPENDENT SCHOOL DISTRICT	
PBK PROJECT NUMBER: P2100600AR	
DATE: 01/29/2021	
DRAWN BY: FM	
CHECKED BY: RL	

REVISIONS		
No.	Description	Date

FOR REVIEW

ARCHITECTURAL
SITE PLAN

A1.00

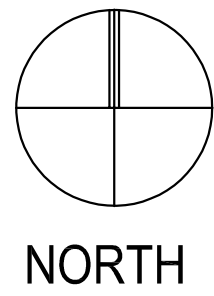

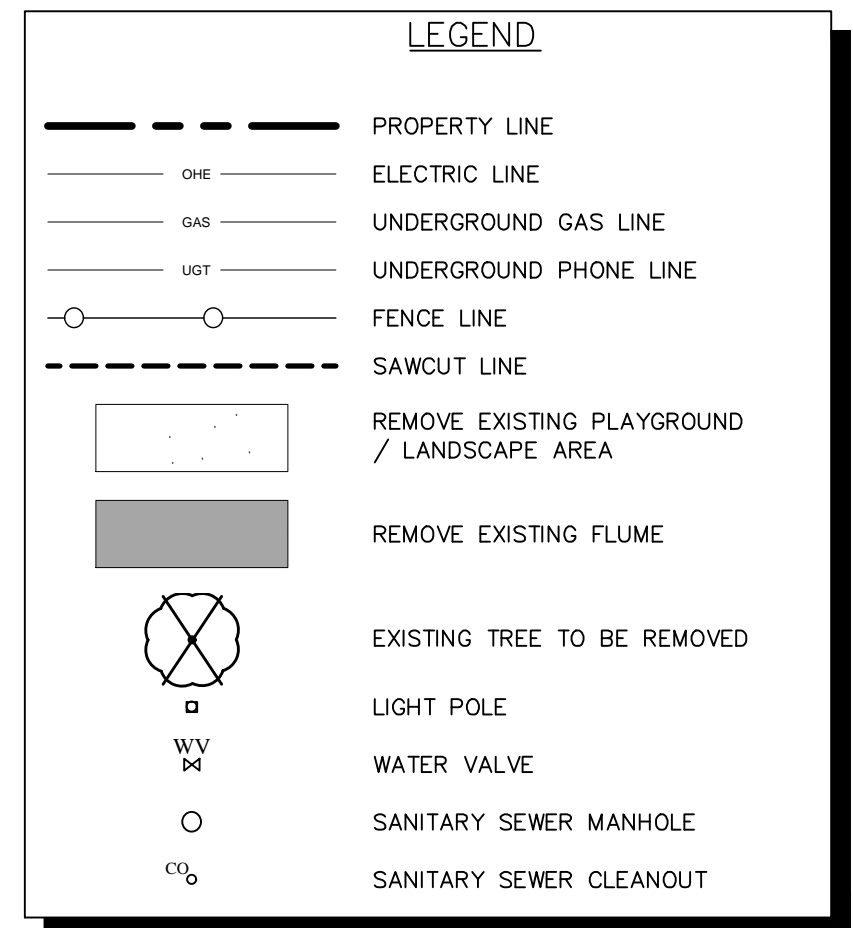
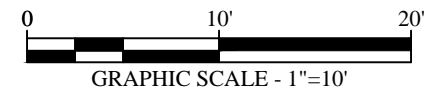
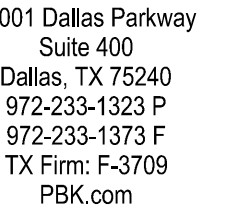

- NOTES:
1. ALL EXISTING TREES SHALL HAVE ADEQUATE TREE PROTECTION THROUGHOUT DEMOLITION AND CONSTRUCTION. ALL UTILITY TRENCHES (FOR UTILITIES TO BE REMOVED OR ABANDONED) SHALL BE BACKFILLED AND RECOMPACTED IN COMPLIANCE WITH THE RECOMMENDATIONS NOTED IN THE GEOTECHNICAL REPORT.
 2. ALL TREES SHOWN ON THE TREES WITH A TRUNK DIAMETER OF SIX (6) INCHES OR GREATER. CONTRACTOR IS RESPONSIBLE FOR REMOVING TREES SMALLER THAN 6" IF REQUIRED FOR THE DEVELOPMENT, EVEN IF NOT SHOWN ON PLAN.
 3. ADJUST EXISTING WATER VALVES TO PROPOSED GRADES AS NECESSARY.
 4. CONTRACTOR SHALL INSTALL AND MAINTAIN TRAFFIC CONTROL DEVICES AS NEEDED TO ACCOMMODATE ALL CONSTRUCTION ACTIVITIES.
 5. DAMAGED IRRIGATION SYSTEMS ON SITE OR CITY PROPERTY SHALL BE REPAIRED.

CAUTION
GAS MAIN IN VICINITY

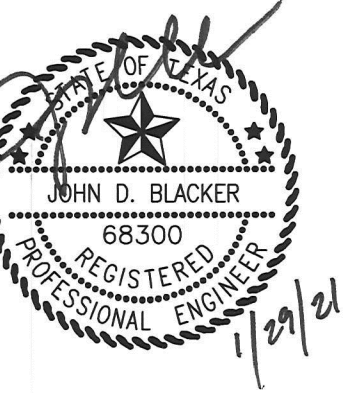

CLIENT: ENNIS INDEPENDENT SCHOOL DISTRICT

BK PROJECT NUMBER: P2100600AR

DATE: 01/29/2021

DRAWN BY: HGA

CHECKED BY: HGA

REVISIONS

[illegible]

PEER REVIEW

DEMOLITION PLAN

C1.00

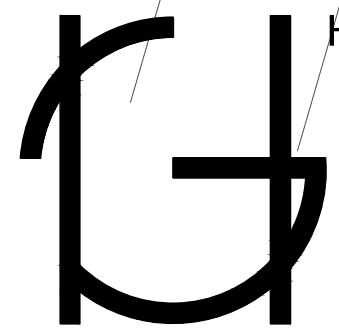

HART GAUGLER + ASSOCIATES
Structural + Civil Engineering Services
12801 N. Central Expwy. Suite 1400
Dallas, Texas 75243
972.239.5111 / 972.239.5055 fax
www.hartgaugler.com
Texas Registered Engineering Firm #F-5053
CONTACT: JOHN D. BLACKER
JBLACKER@HARTGAUGLER.COM

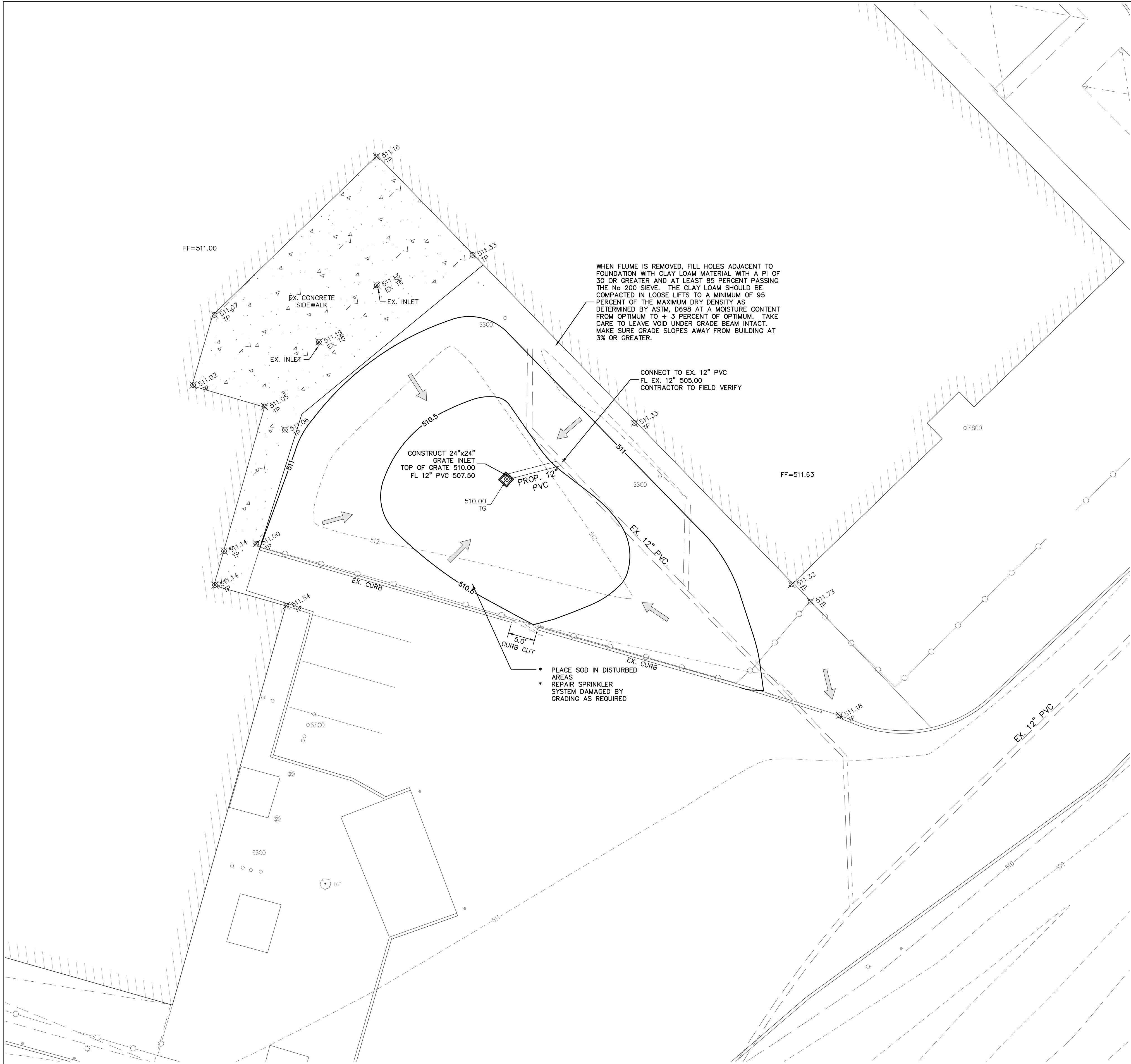

GRADING NOTES

1. A GRADING PERMIT IS REQUIRED FROM THE CITY PRIOR TO STARTING CONSTRUCTION. THE CONTRACTOR IS RESPONSIBLE FOR OBTAINING THIS PERMIT AND PAYING ALL ASSOCIATED FEES.
2. CONTRACTOR SHALL FIELD VERIFY HORIZONTAL AND VERTICAL LOCATION OF ALL EXISTING UTILITIES PRIOR TO CONSTRUCTION. CONTRACTOR IS RESPONSIBLE FOR PROTECTING EXISTING UTILITIES (SHOWN OR NOT SHOWN) WITHIN SCOPE OF CONSTRUCTION. IF ANY EXISTING UTILITIES ARE DAMAGED, THE CONTRACTOR SHALL REPLACE THEM AT THEIR OWN EXPENSE.
3. ALL SPOT ELEVATIONS SHOWN ARE TO TOP OF PAVING SURFACE OR FINISHED EARTH GRADE UNLESS NOTED OTHERWISE. ADD 6-INCHES TO SPOT GRADES SHOWN, FOR TOP OF CURB ELEVATIONS.
4. THE CONTRACTOR TO ENSURE POSITIVE DRAINAGE FROM THE PROPOSED BUILDINGS AND NO PONDING IN PAVED AREAS. CONTRACTOR FIELD ADJUSTMENTS TO SPOT GRADES TO MAINTAIN POSITIVE DRAINAGE ARE ALLOWED WITH THE PRIOR APPROVAL OF THE ENGINEER. CONTRACTOR SHALL CONTACT THE ENGINEER PRIOR TO PAVING IF ANY AREAS OF POOR DRAINAGE ARE ENCOUNTERED.
5. THE CONTRACTOR SHALL PROTECT ALL MANHOLE COVERS, VALVE COVERS, VAULT LIDS, FIRE HYDRANTS, POWER POLES, GUY WIRES, AND TELEPHONE BOXES WHICH ARE TO REMAIN IN PLACE AND UNDISTURBED DURING CONSTRUCTION.
6. ALL EXISTING CONCRETE PAVING, CHANNEL IMPROVEMENTS, SIDEWALK, STRUCTURES AND CURB DEMOLITION SHALL BE REMOVED IN THEIR ENTIRETY AND DISPOSED OF BY THE CONTRACTOR, OFFSITE UNLESS OTHERWISE DIRECTED BY THE OWNER OR ENGINEER.
7. THE GRADING CONTRACTOR SHALL COORDINATE WITH THE FRANCHISE UTILITY COMPANIES FOR ANY REQUIRED UTILITY ADJUSTMENTS AND/OR RELOCATIONS.
8. THE CONTRACTOR SHALL CALCULATE THEIR OWN EARTHWORK QUANTITIES TO DETERMINE THEIR BID. ANY DEVIATION FROM A BALANCED CUT AND FILL SHALL BE IMMEDIATELY BROUGHT TO THE ATTENTION OF THE CIVIL ENGINEER AND ANY VARIANCE SHALL BE SPECIFICALLY ITEMIZED ON THE BID.
9. BEFORE ANY EARTHWORK IS DONE, THE CONTRACTOR SHALL STAKE OUT AND MARK THE LIMITS OF CONSTRUCTION AND OTHER ITEMS ESTABLISHED BY THE PLANS. THE CONTRACTOR SHALL PROTECT AND PRESERVE CONTROL POINTS AT ALL TIMES DURING THE COURSE OF THE PROJECT. THE GRADING CONTRACTOR SHALL PROVIDE ALL NECESSARY ENGINEERING AND SURVEYING FOR LINE AND GRADE CONTROL POINTS RELATED TO EARTHWORK.

STORM SEWER NOTES

1. CONTRACTOR SHALL FIELD VERIFY THE VERTICAL AND HORIZONTAL LOCATIONS OF ALL EXISTING UTILITIES PRIOR TO START OF CONSTRUCTION. THE CONTRACTOR SHALL NOTIFY THE ENGINEER AND CONSTRUCTION MANAGER IMMEDIATELY IF A CONFLICT IS DISCOVERED.
2. CONTRACTOR SHALL VERIFY AND COORDINATE ALL DIMENSIONS SHOWN, INCLUDING THE HORIZONTAL AND VERTICAL LOCATION OF CURB INLETS, GRATE INLETS, AND ALL UTILITIES CROSSING THE STORM SEWER. FLOW LINES AND RIMS OF PROPOSED INLETS SHALL BE VERIFIED WITH THE PROPOSED GRADE PRIOR TO CONSTRUCTION.
3. THE END OF ALL STORM SEWER LATERALS THAT CONNECT TO WORK BY THE PLUMBER SHALL BE TIGHTLY PLUGGED OR CAPPED AND MARKED 5.0 FEET OUTSIDE THE BUILDING UNTIL FINAL CONNECTIONS ARE MADE BY THE PLUMBING CONTRACTOR.
4. THE CONTRACTOR SHALL PROVIDE ALL MATERIALS AND APPURTENANCES NECESSARY FOR COMPLETE INSTALLATION OF THE STORM SEWER.
5. CONTRACTOR IS RESPONSIBLE FOR OBTAINING ALL CONSTRUCTION PERMITS.
6. THE GENERAL CONTRACTOR AND ALL SUBCONTRACTORS SHALL VERIFY THE SUITABILITY OF ALL EXISTING AND PROPOSED SITE CONDITIONS INCLUDING GRADES AND DIMENSIONS BEFORE COMMENCEMENT OF CONSTRUCTION. THE ENGINEER SHALL BE NOTIFIED IMMEDIATELY OF ANY DISCREPANCIES.
7. REFERENCE THE CITY'S DESIGN STANDARDS FOR NEW STORM SEWER SYSTEMS.
8. THE CONTRACTOR SHALL BE RESPONSIBLE FOR PREPARING AND IMPLEMENTING A TRENCH PROTECTION PLAN FOR ALL OPEN TRENCH EXCAVATION.
9. EXISTING MANHOLE TOPS AND ALL OTHER DRAINAGE FACILITIES SHALL BE ADJUSTED AS REQUIRED TO MATCH FINAL GRADES AS SHOWN ON GRADING PLAN. NO SEPARATE PAY ITEM.
10. ALL RCP STORM SEWER PIPE INDICATED ON PLANS SHALL BE CLASS III RCP, OR AS SHOWN BELOW.
DEPTH OF COVER
LESS THAN 3 FEET - CLASS IV
BETWEEN 3 AND 10 FEET - CLASS III
BETWEEN 10 AND 15 FEET - CLASS IV
GREATER THAN 15 FEET - CLASS V
11. ALL HDPE STORM SEWER PIPE INDICATED ON PLANS SHALL BE A.D.S. N-12 (HDPE) SMOOTH INTERIOR PIPE OR APPROVED EQUAL.

LEGEND

- PROPERTY LINE
- FLOW DIRECTION
- 600--- EXISTING CONTOURS
- 601--- EXISTING CONTOURS
- 600--- PROPOSED CONTOURS
- 601--- PROPOSED CONTOURS
- R --- R --- HIGH POINT
- x 621.42 TP TOP OF PAVEMENT OR PROPOSED GRADE
- x 622.19 TS TOP OF SIDEWALK
- x 622.19 ME MATCH EXISTING ELEVATION

- NOTES:
1. CONTRACTOR TO ENSURE SIDEWALKS DRAIN AWAY FROM BUILDING.
 2. SIDEWALK TO HAVE A MAX. 5% GRADE AND 2% CROSS SLOPE.
 3. THE CONTRACTOR MUST REFER TO CITY OF CITY NAME ENGINEERING DEPARTMENT SUPPLEMENTAL DESIGN STANDARDS.
 4. PROPOSED GRADES SHALL MATCH EXISTING GRADES AT PROPERTY LINE.
 5. THE MAXIMUM SLOPE MUST BE 4:1.
 6. CONTRACTOR MUST COORDINATE WITH ARCHITECTURAL, MEP, LANDSCAPE, AND IRRIGATION PLANS.

STORM SEWER DISCHARGE AUTHORIZATION

1. A NOTICE OF INTENT (N.O.I.) SHALL BE SUBMITTED BY THE CONTRACTOR TO THE TCEQ NO LESS THAN 48 HOURS PRIOR TO COMMENCEMENT OF CONSTRUCTION ACTIVITIES.
2. ALL CONTRACTORS AND SUBCONTRACTORS PROVIDING SERVICES RELATED TO THE SWPPP SHALL SIGN A CONTRACTOR CERTIFICATION STATEMENT ACKNOWLEDGING THEIR RESPONSIBILITIES AS SPECIFIED IN THE SWPPP.
3. A COPY OF THE SWPPP, INCLUDING CONTRACTOR CERTIFICATIONS AND ANY REVISIONS, SHALL BE SUBMITTED TO THE CITY AND FILED WITH THE CONSTRUCTION PLANS, AND SHALL BE RETAINED ON-SITE DURING CONSTRUCTION.
4. A NOTICE OF TERMINATION (N.O.T.) SHALL BE SUBMITTED TO THE TCEQ BY THE CONTRACTOR WHEN THE SITE HAS 100% OF THE DISTURBED AREAS STABILIZED AND THE SITE NO LONGER HAS STORM WATER DISCHARGES ASSOCIATED WITH INDUSTRIAL ACTIVITIES (CONSTRUCTION), OR THE N.O.T. PERMITTEE OR CO-PERMITTEE NO LONGER HOLDS OPERATIONAL CONTROL OF THE CONSTRUCTION.

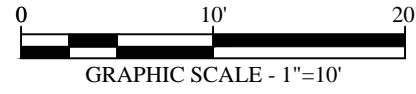
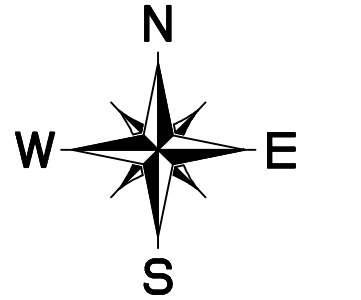

14001 Dallas Parkway
Suite 400
Dallas, TX 75240
972-233-1323 P
972-233-1373 F
TX Firm: F-3709
PBK.com



CROCKETT EARLY
CHILDHOOD CENTER
PHASE II
ENNIS INDEPENDENT SCHOOL DISTRICT
ENNIS, TEXAS

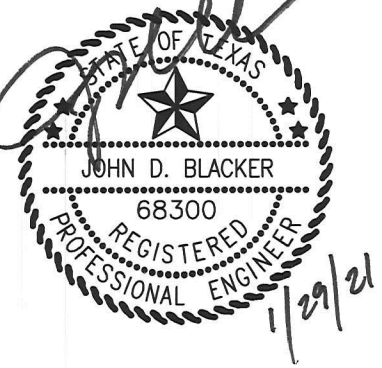

CLIENT: ENNIS INDEPENDENT SCHOOL DISTRICT
PBK PROJECT NUMBER: P2100000AR
DATE: 01/29/2021
DRAWN BY: HGA
CHECKED BY: HGA

REVISIONS		
No.	Description	Date.

FOR REVIEW

GRADING
PLAN

C3.00



HART GAUGLER + ASSOCIATES
Structural + Civil Engineering Services
12801 N. Central Expwy, Suite 1400
Dallas, Texas 75243
972-239.5111 / 972-239.5055 fax
www.hartgaugler.com
Texas Registered Engineering Firm #F-5053
CONTACT: JOHN D. BLACKER
JBLACKER@HARTGAUGLER.COM