

January 9th 2018

RIGHT NOW

Please get out a pencil/pen your notebook, folder, and any signed forms.

Before class begins write down what the focus of our work time today is as well as your homework.

OPENING: GPS Georgia Stories: “The Women of World War II”

http://www.gpb.org/georgiastories/stories/women_of_world_war_two

Three I heard that Statements

WT:

1. Notes

Closing:

Tuskegee Airmen Brain Pop

HOMEWORK: Review

Warm Up:

How did WWII impact Georgia?

In what ways did WWII change the political and social norms in the US and Georgia?

Learning Target:

I can explain the causes of WWII as well as the impact that industry, military bases, and political leaders had on Georgia during and after the War that were integral to Georgia’s growth and economic development.

EQs:

What role did the United States play at the beginning of WWII and what brought the United States into the war?

How did WWII impact Georgia specifically?

Important People

**PRESIDENT
ROOSEVELT**



**RICHARD
RUSSELL**



**CARL
VINSON**



HOW DID THESE MEN HELP THE ECONOMY OF GEORGIA?



RICHARD RUSSELL

CARL VINSON

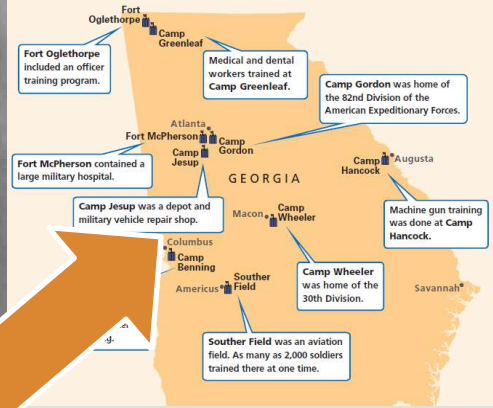

**PRESIDENT
ROOSEVELT**



- Lived in Warm Springs, Georgia
- New Deal rural electrification Program
- Helped bring Bell Aircraft plant to Marietta

**RICHARD
RUSSELL**



- Georgia Governor and US Senator
- Brought military bases to Georgia
- Research facilities like the CDC (Center for Disease Control)
- National School Lunch Program

**CARL
VINSON**



- "father of the two-ocean navy"
- US Representative
- Savannah and Brunswick shipyards

HOW DID THESE MEN HELP THE ECONOMY OF GEORGIA?

Lockheed

HOW DID THE

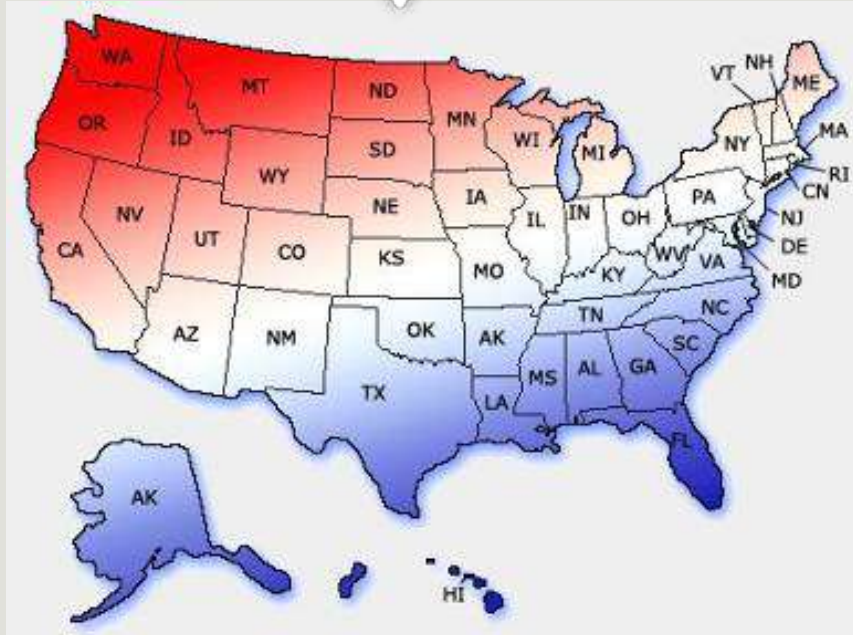

GET

INVOLVED IN



LEND
LEASE
ACT



Lended Bases
& sent supplies to
Allies



PEARL
HARBOR



Dec 7, 1941
* Considered civilian
Attack
1 day to live in
Infamy



US
WORLD
WAR II





FDR

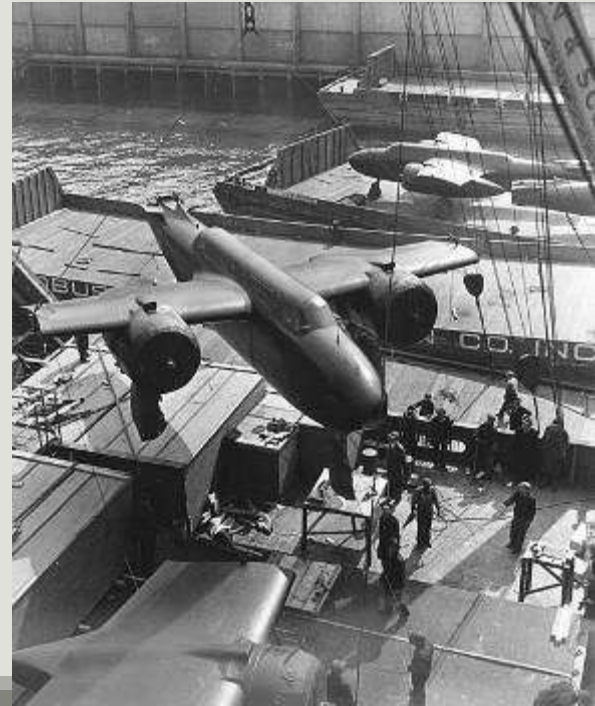

FLOW OF LEND-LEASE

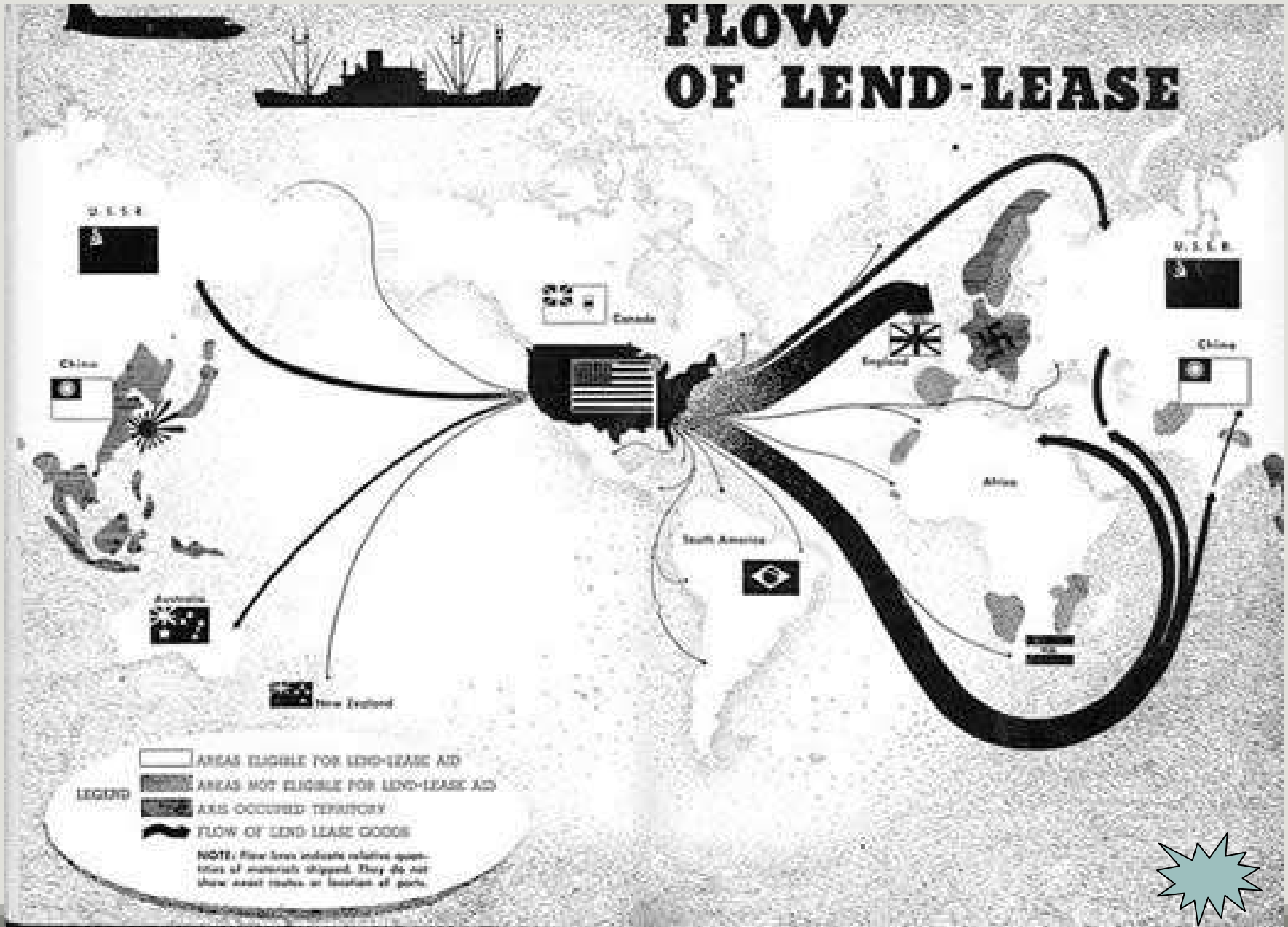









Photo # 80-G-19949 USS Maryland and capsized USS Oklahoma, 7 December 1941







WHY DOES
THIS DAY
LIVE IN
INFAMY?

- What was it? Attack on the U.S. Military forces in Hawaii. Happened on U.S. soil
- When was it? December 7, 1941
- What was its purpose? Japan wanted to cripple the U.S. military (Navy) in the Pacific Ocean, so that Japan could take over more land in the Pacific.
- Was the plan effective? Short-term it was effective (U.S. lost over 150 ships) Long-term it was not effective, because the U.S. declared war on Japan and got involved in WWII.
- How was it an influence on U.S. entry into WWII? It was the direct reason why the U.S. became involved in the war. After Pearl Harbor more people supported the war.

A DAY THAT WILL LIVE IN INFAMY!

December 7, 1941 – Attack on Pearl Harbor

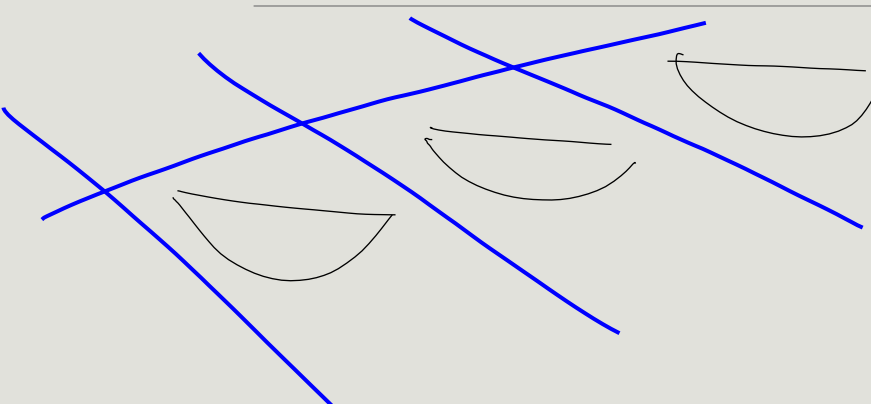

Pearl Harbor Anchorage

7:55 A.M. Dec. 7, 1941



©1997 MAGELLAN Geographix(805) 685-3100 www.maps.com





USS Arizona, Pearl Harbor Memorial, Hawaii, 9/8/2001

Photo: Anders Brownworth - <http://www.anders.com/>

Georgia in WWII

BELL AIRCRAFT

Marietta, GA



Lockheed

Martin AFB

B-29 bomber, America's most technologically advanced bomber in the war

Produced 650 bombers before the end of the war

Biggest impact – 30,000 people were employed by the largest plant to have ever been built in the Deep South

Closed after the war – **Reopened in 1951 as Lockheed Martin**

GEORGIA'S LAND & MILITARY BASES

During WWI - More military facilities in GA than any other state

Bases grew during WWII

Important role in training and supplying the military

Fort Benning (Columbus, GA) largest and viewed as best infantry facility during the war

Today bases provide 1000's of jobs for Georgians and pump millions into the economy

January 10th 2018

RIGHT NOW

Please get out a pencil/pen your notebook, folder, and any signed forms.

Before class begins write down what the focus of our work time today is as well as your homework.

OPENING:

Georgia Stories

http://www.gpb.org/georgiastories/stories/carl_vinson

Three I heard that Statements

WT:

1. Notes WWII

Closing:

Brain Pop the Holocaust

HOMEWORK: Review

Warm Up:

How did WWII impact Georgia?

In what ways did WWII change the political and social norms in the US and Georgia?

I will be able to:

I will be able to explain the causes of WWII as well as the impact that industry, military bases, and political leaders had on Georgia during and after the War that were integral to Georgia's growth and economic development.

EQs:

What role did the United States play at the beginning of WWII and what brought the United States into the war?

How did WWII impact Georgia specifically?

**BELL
AIRCRAFT
B-29 BOMBER
MARIETTA, GA**

**BELL AIRCRAFT
PLANT IS NOW
LOCKHEED MARTIN**



Georgia's Military Training Facilities, 1918

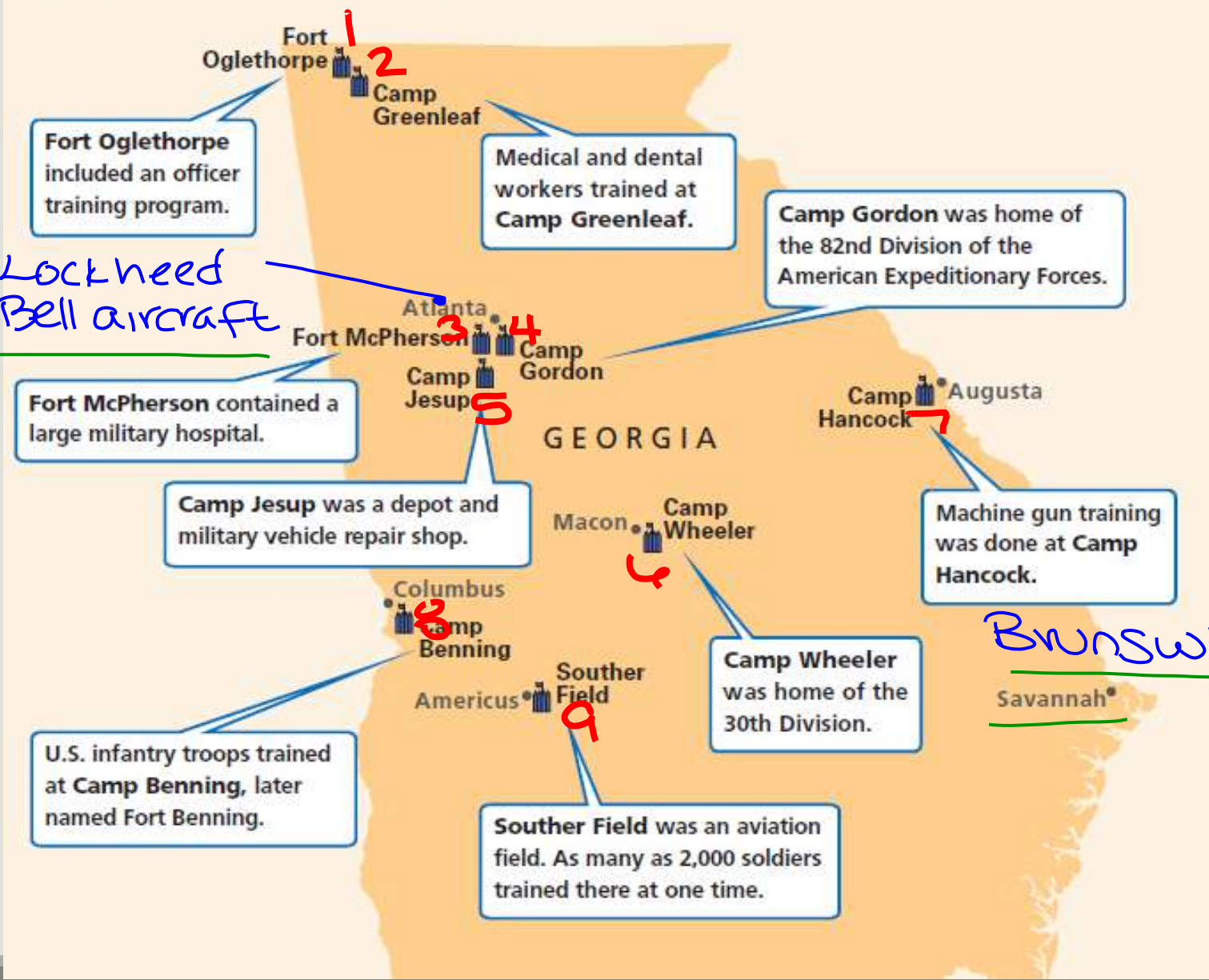

Big Bombers Lockheed Bell aircraft

Brunswick Built Ships

FORT BENNING, GEORGIA

THEN **AND** **NOW**



DOBBINS AIR FORCE BASE



SAVANNAH & BRUNSWICK SHIPYARDS

Major contribution during the war

Large number of civilians (mainly women) working on the “liberty ships”

Used to transport troops and supplies to both the European and Pacific fronts

187 ships used during the war were built in these two shipyards.

“LIBERTY SHIP” BEING CONSTRUCTED.

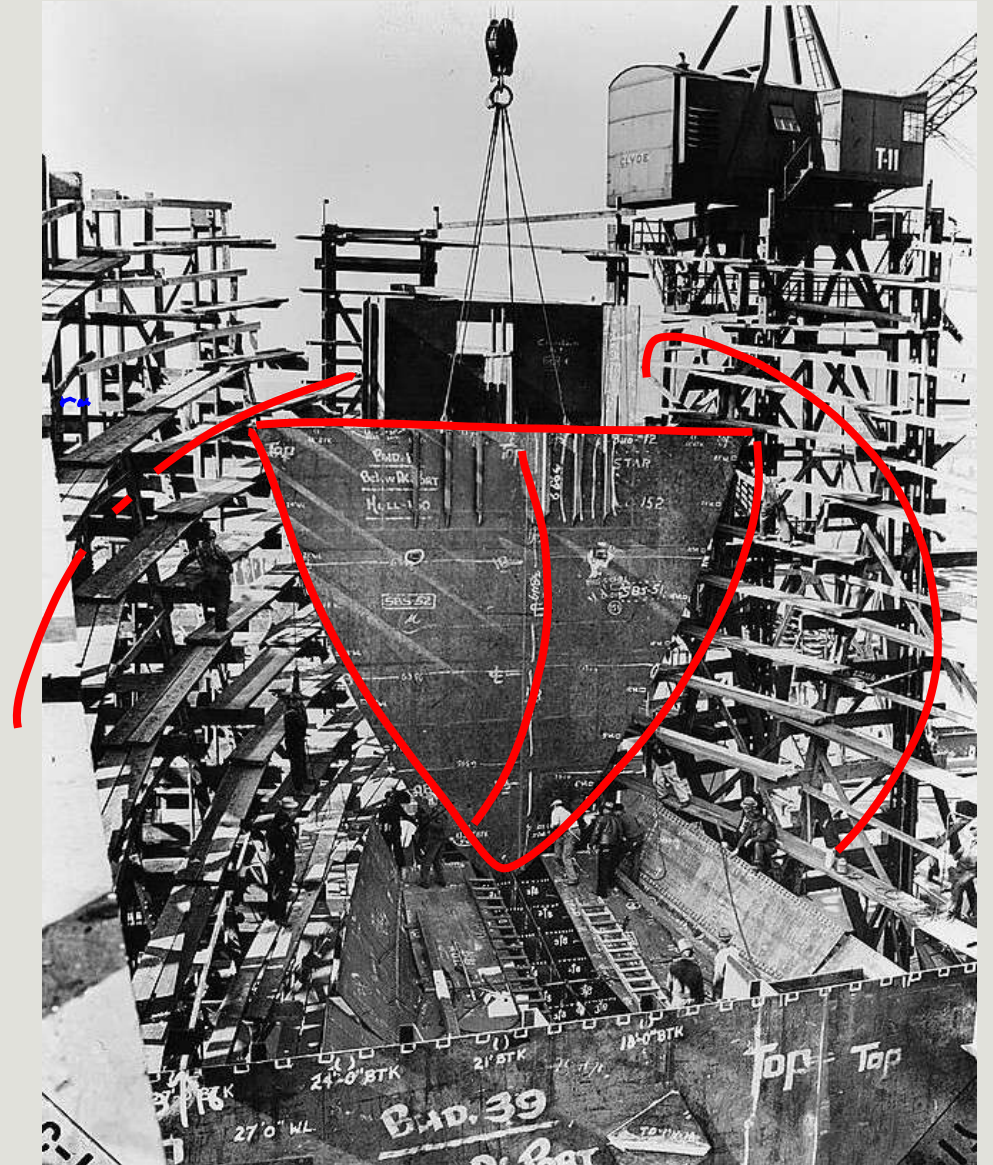

SAVANNAH and BRUNSWICK SHIPYARDS

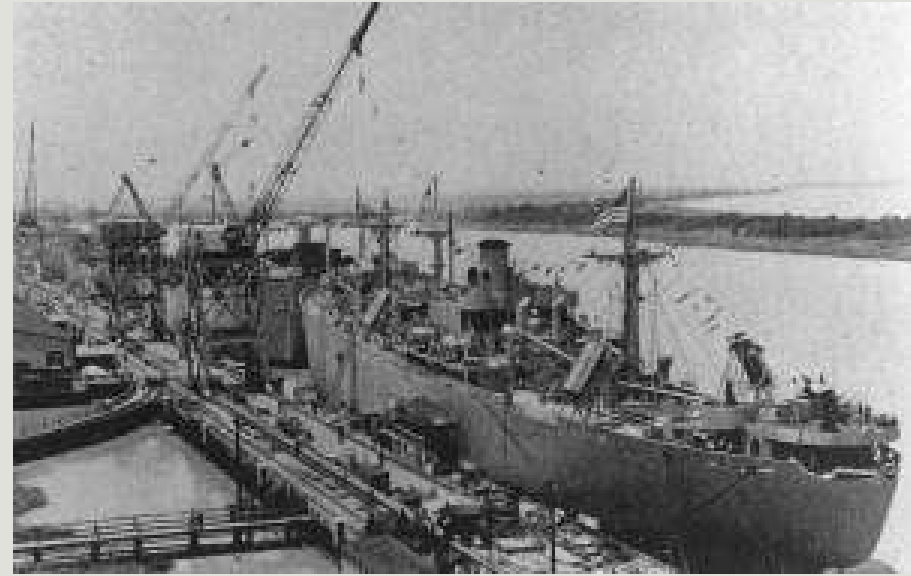

How did Roosevelt's visits to Warm Springs impact the state of Georgia?

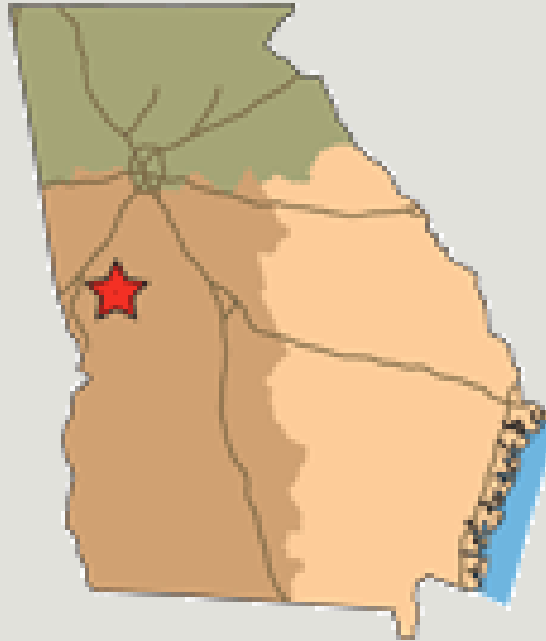

FDR

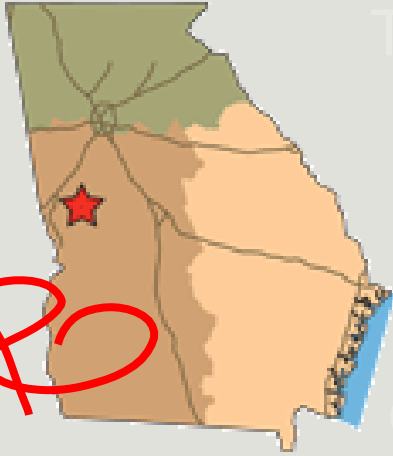

The Little
White
House
Warm
Springs
Georgia



Franklin Delano Roosevelt built the Little White House in 1932 while governor of New York, prior to being inaugurated as president in 1933. He first came to Warm Springs in 1924 hoping to find a cure for polio that had struck him in 1921. Swimming in the 88-degree, buoyant spring waters brought him no miracle cure, but it did bring improvement. During FDR's presidency and the Great Depression, he developed many New Deal Programs (such as the Rural Electrification Administration) based upon his experiences in this small town.



WHAT IS THE IMPACT OF THE HOLOCAUST ON GEORGIANS?

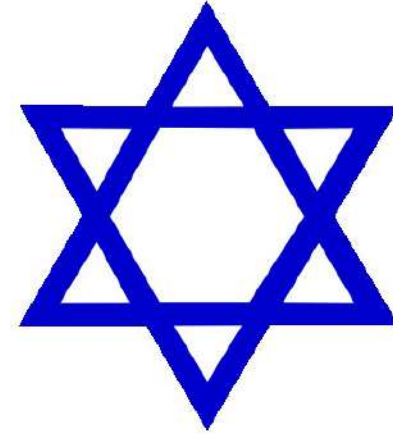
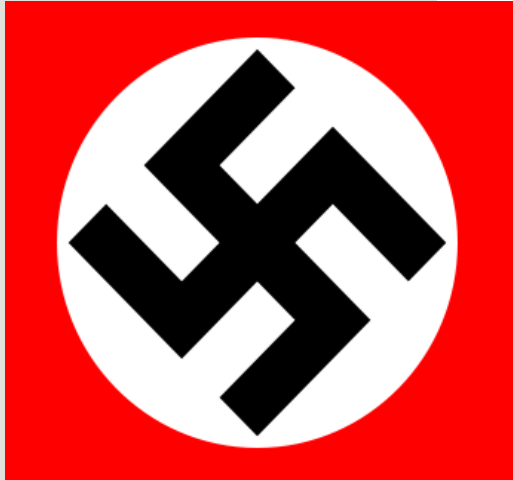

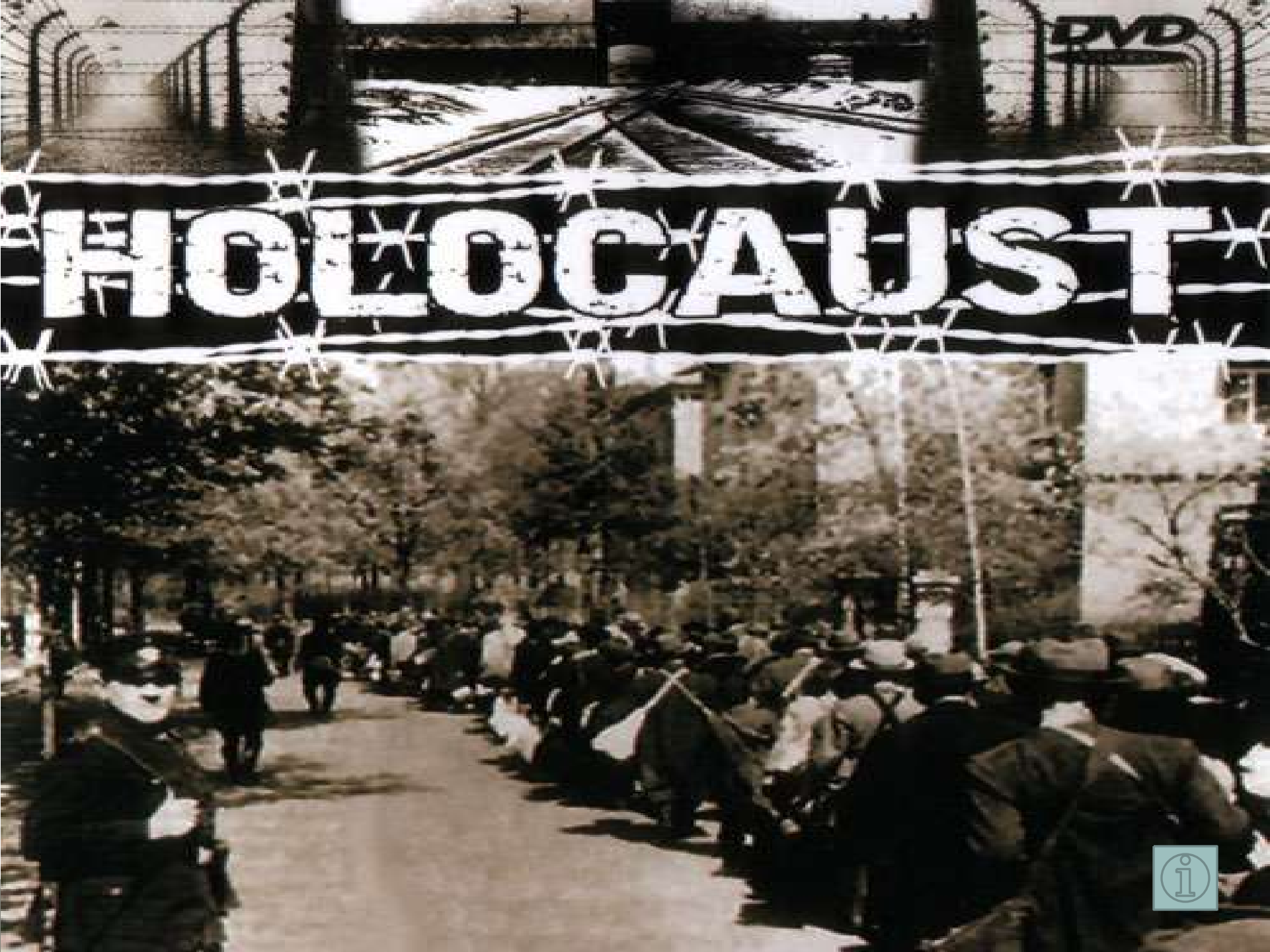

WHAT IS THE IMPACT OF THE HOLOCAUST ON GEORGIANS?

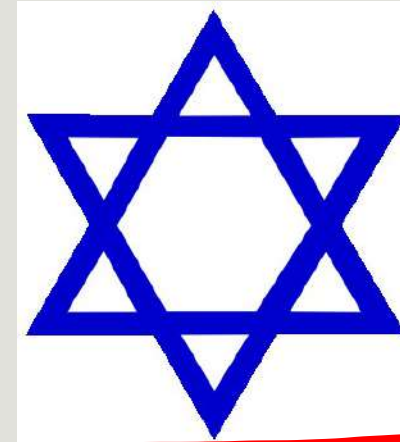
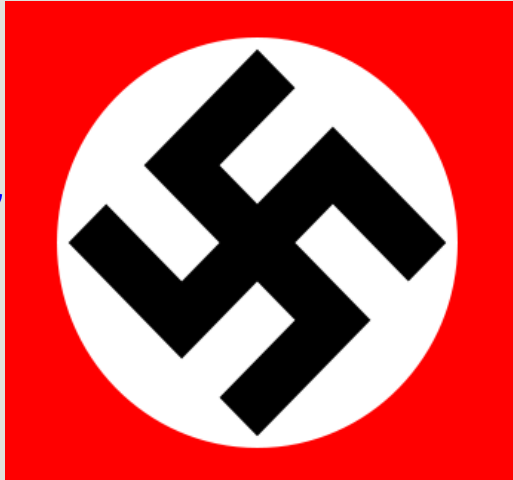

- OVER 6 MILLION JEWS DIED
- MANY JEWS LIVE IN ATLANTA
- JEWS SUPPORTED THE CREATION OF ISRAEL AFTER WWII
- “GEORGIA COMMISSION ON THE HOLOCAUST” WAS CREATED TO HELP FIGHT BIGOTRY AND RACISM

Middle East Today

Anti-Semitic

12 million Total

The Holocaust was the systematic mass murder of over 6 million Jews in Europe. The Nazis used Concentration Camps to imprison, work, and execute Jews, gypsies, homosexuals, and political dissidents. The Holocaust had an impact on the state. Many Holocaust survivors moved to Georgia after the war. Their stories about the horrible events in Europe touched the lives of many Georgians. The Holocaust also made some Georgians rethink their treatment of minorities in the state. Though it took more than a decade for the modern civil rights movement to gain momentum in Georgia and the rest of the South, the horror of what happened in Europe made Georgians “look in the mirror” and re-examine their racial practices. In addition, former Governor Joe Frank Harris, established the Georgia Commission on the Holocaust to educate people about the Holocaust therefore creating an awareness of the events.

For more information about the impact of the Holocaust on Georgians and to hear the stories of Holocaust survivors who immigrated to Georgia see:

The Breman Jewish Heritage and Holocaust Museum: “New Lives: Coming to America”

<http://www.thebreman.org/exhibitions/online/newlives/start.php>

The Georgia Commission on the Holocaust: <http://www.holocaust.georgia.gov>

What happened to
move Georgia toward
having a more
industrial based
economy?

The Transformation of Agricultures

- Several factors caused Georgia's population to shift from rural to urban areas.
 - Destruction of cotton crop by the boll weevil and the drought
 - Migration of African-Americans to northern cities
 - Movement of blacks and whites to Georgia's industrial centers and factories during both World Wars
 - AAA paying farmers to stop growing crops

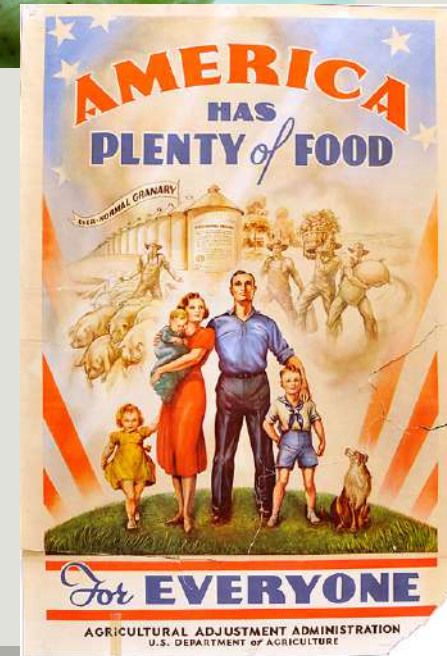

The Transformation of Agriculture

- Another factor impacting agriculture in Georgia after World War II was the technological change in agricultural equipment.
 - Tractors, reapers, and other machinery
 - Better fertilizers
 - Made it easier to grow and process crops
- Lessened need for large numbers of agricultural workers



The Transformation of Agricultures

- Though the rural population in Georgia has decreased from almost 85% in 1900 to less than 25% today, farming is still important to Georgia's economy, bringing in \$56 billion a year to the state (approx. 16% of total)



January 11th 2018

RIGHT NOW

Please get out a pencil/pen your notebook, folder, and any signed forms.

Before class begins write down what the focus of our work time today is as well as your homework.

OPENING:

Georgia Stories “William B. Hartsfield”

<http://www.georgiaencyclopedia.org/nge/Article.jsp?id=h-599&hl=y>

Three I heard that Statements

WT:

1. Notes WWII

Closing:

Student led discussion popcorn style: Did WWII positively or negatively impact Georgia? WHY?

HOMEWORK: Review

Warm Up:

How did Georgia develop in the 1950's?

I will be able to:

I will be able to explain the causes of WWII as well as the impact that industry, military bases, and political leaders had on Georgia during and after the War that were integral to Georgia's growth and economic development.

EQs:

What role did the United States play at the beginning of WWII and what brought the United States into the war?

How did WWII impact Georgia specifically?

What does the name
William Hartsfield make
you think of?



William Hartsfield

Atlanta City Council- 1922

- Helped in opening Atlanta's first airport

Atlanta Mayor- 1937-1941; 1942-1961

- Longest serving mayor
 - Helped city make it through depression- talked president of Coca Cola into paying payroll one month
 - Helped keep city calm during integration
 - Known for starting statement that Atlanta was "The City too Busy to Hate"
 - Tripled Atlanta's size, oversaw building of many of Atlanta's parks, expanded Atlanta's expressway system.



Ivan Allen Jr.



- Mayor of Atlanta- 1962-1970
 - Fought for Civil Rights
 - On his first day as mayor, he had all the white and colored signs removed from city hall and desegregated the building's cafeteria.
 - Worked with Martin Luther King Jr. and Atlanta's business leaders to help the city transition smoothly into desegregation
- Helped improve Atlanta's transportation
 - Interstate 285
 - M.A.R.T.A.



Ivan Allen Jr.

- Best known for helping bring major league sports to the city.
- He convinced Atlantans to financially support the construction of stadiums and brokered deals to bring the Braves and Hawks to Atlanta
- Persuaded NFL to start new franchise in the city

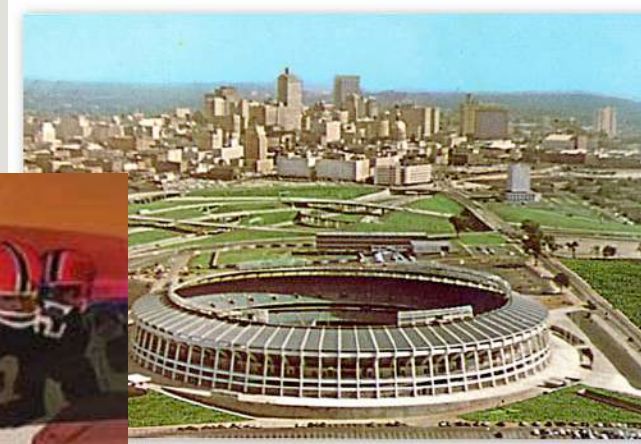

Which one of Atlanta's major league sports teams have won a national championship title?

Why would having
a major league
team be
important?

Major League Sports

- Atlanta's sports teams have brought thousands of jobs to the state and millions of dollars into the economy.
- Their facilities helped bring the 1996 Olympic games to the state of Georgia.
- The first team to come to Atlanta was the Atlanta Braves in 1966. Followed by the Falcons the same year and the Hawks in 1968.



The Braves are often considered to be the oldest professional sports team in the United States.

Which cities and teams did they belong to before moving to Atlanta?

Atlanta Braves

- They trace their origins back to the 1869 Cincinnati Red Stockings that moved to Boston in 1871 and then to Atlanta.
- The Braves were one of the most successful teams in the 1990s. Unfortunately, they were also the second team in Major League Baseball history to lose 10,000 games.



Major League Sports

- Atlanta is also home to other professional sports teams including men and women's soccer and women's basketball.
- Atlanta is also the only city to lose two National Hockey League teams: The Atlanta Flames and the Atlanta Thrashers



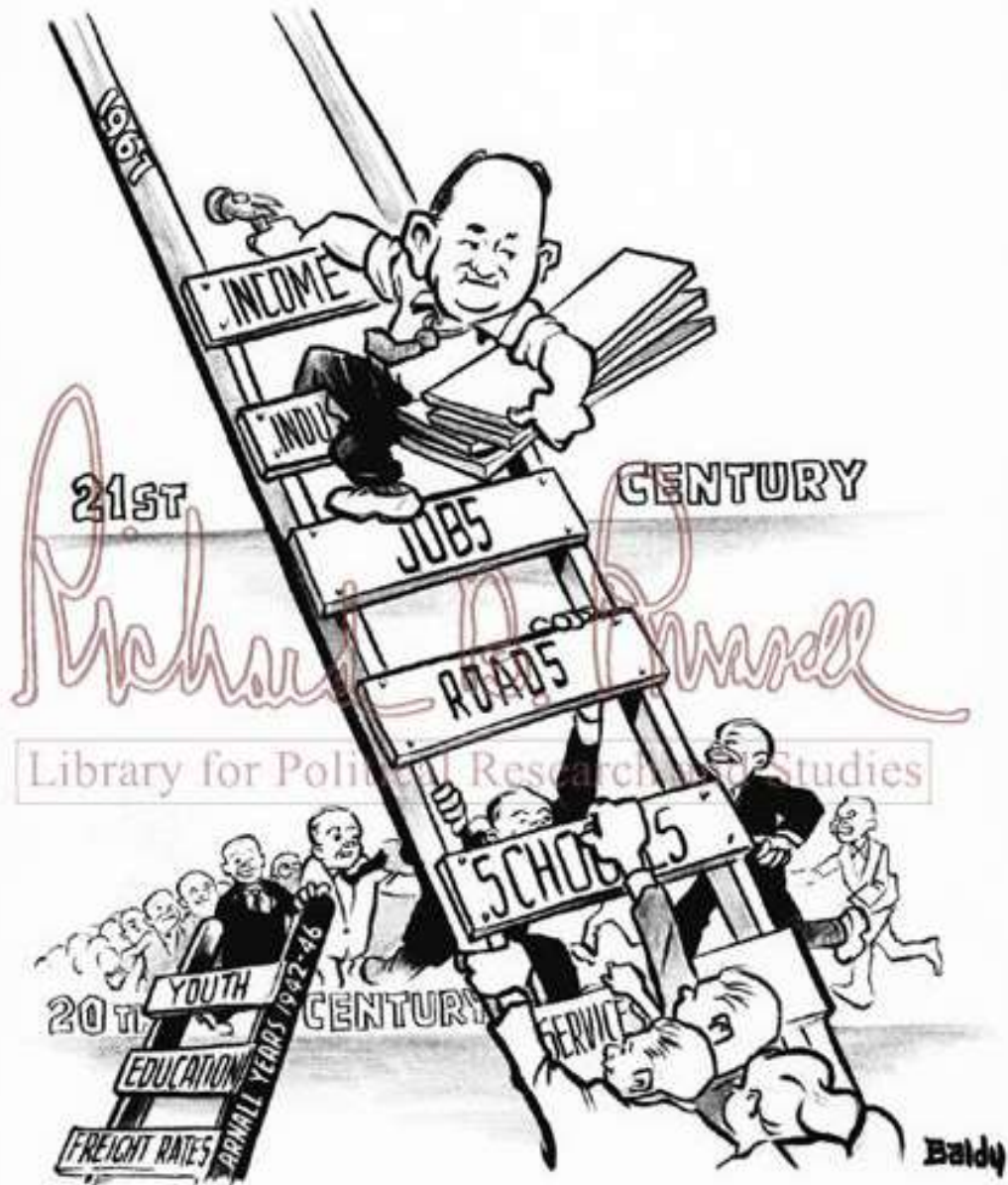

"...IT'S Moving Time Again!"

Ellis Arnall

Ellis Arnall

- 1932- Georgia General Assembly
- 1938- Georgia Attorney General- At age 31, he was the youngest attorney general in the United States.
- 1942- Governor- Defeated Eugene Talmadge largely due to the state's university system losing its accreditation because of Talmadge's interference.
- As governor, he is credited with
 - Restoring accreditation to the state's colleges
 - Abolishing the poll tax
 - Lowering the voting age
 - Establishing a teacher's retirement system



With all the positive things that Arnall did, why was he unpopular with Georgia voters during this time period?

Ellis Arnall

- Lost support in the state based on his support of law and rulings that supported Civil Rights for African Americans
 - Example- He accepted the Supreme Court ruling against the white primary.
- Due to Georgia law, he could not run for re-election in 1947. He played a key role in the “three governor’s controversy (coming soon) by refusing to give up the governor’s office until the issue was worked out.
- He ran for Governor again in 1966, but lost in the primary to segregationist Lester Maddox. He never ran for office again.



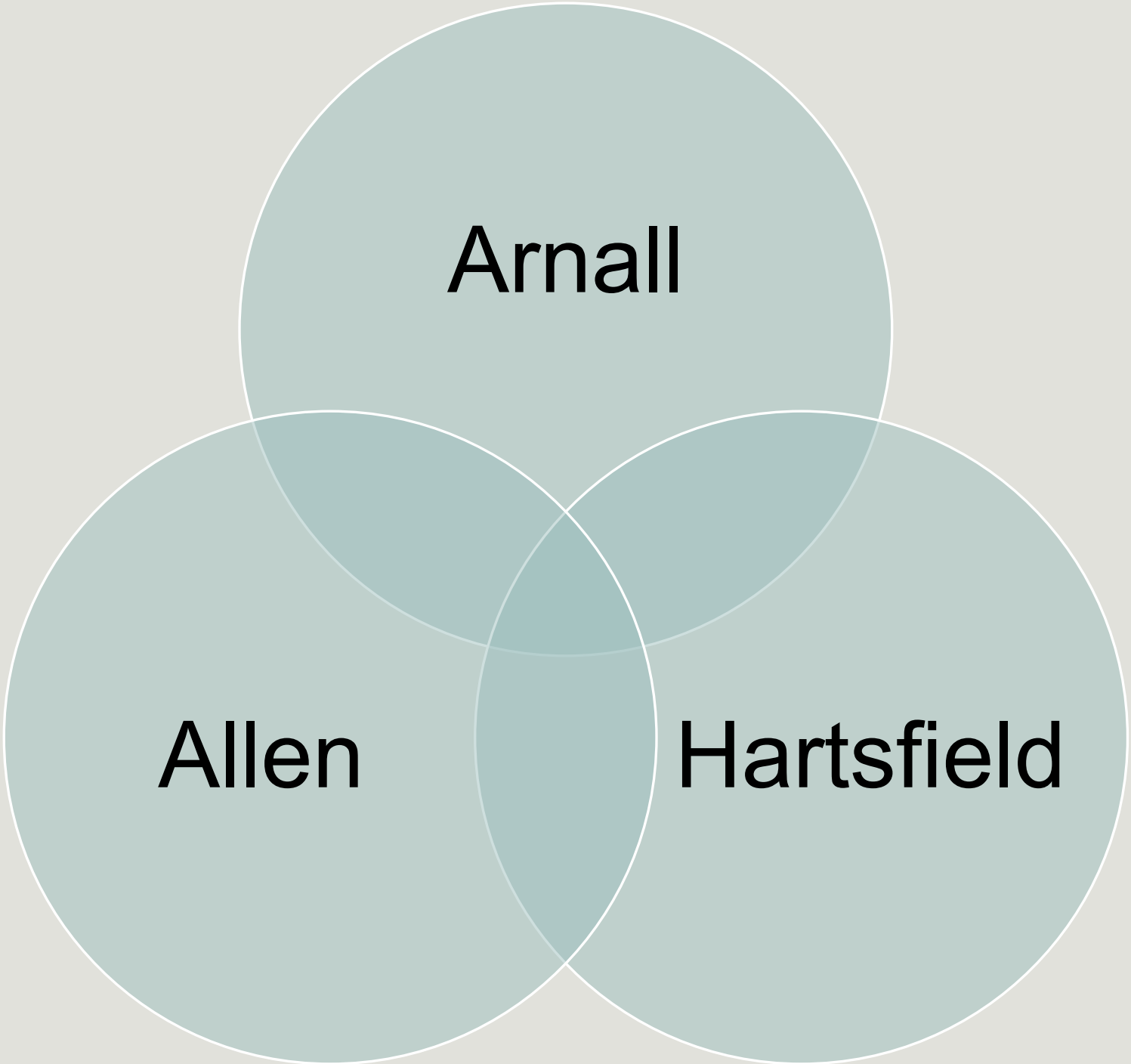

Arnall

Allen

Hartsfield

January 12th 2018

RIGHT NOW

Please get out a pencil/pen your notebook, folder, and any signed forms.

Before class begins write down what the focus of our work time today is as well as your homework.

OPENING: Prepare to TEST

WT:

1. TEST

Closing:

What did you learn this unit?

HOMEWORK: Review

I will be able to:

I can demonstrate my understanding the causes of WWII as well as the impact that industry, military bases, and political leaders had on Georgia during and after the War that were integral to Georgia's growth and economic development through a summative exam.

EQs:

What role did the United States play at the beginning of WWII and what brought the United States into the war?

How did WWII impact Georgia specifically?

Name

January 12

Ms. Aiken

WWII Summative

Quiet

Please

Testing in
Progress



SILENCE IS GOLDEN