



chromebook

Computer Log-in & Connecting to Wireless Internet



STEP 1 - Open Chromebook, hit power button (if it is off)

STEP 2 - Once on and open you will see a sign into your Chromebook window, ignore that for now, move mouse to lower right corner and click on wireless internet network icon.

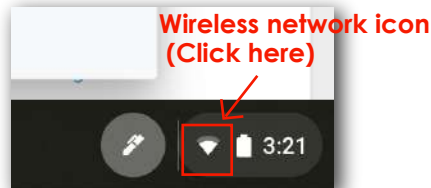

STEP 3 - Connect to your home wireless internet by clicking on your wireless internet name (this is known as the network/Wi-Fi name). **NOTE:** If after opening the chromebook, you see a wireless network list pop-up, you will click on your wireless internet name to connect to your wireless internet.

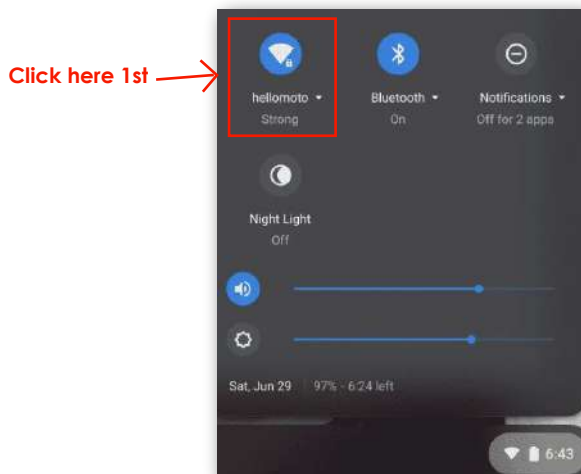

This will appear
then click on
your internet name.

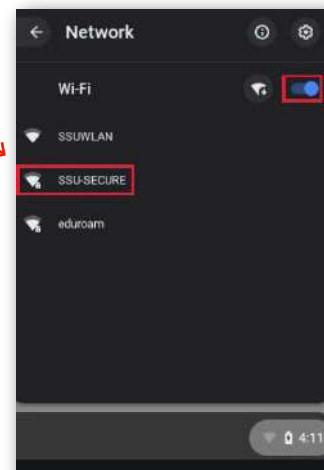

STEP 4 - A "Join Wi-Fi Network" Pop-up box will appear, type in your home wireless password (Wi-Fi password), then click Connect.

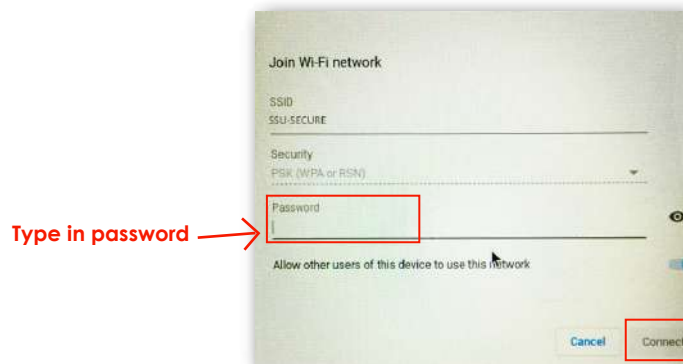



chromebook

Computer Log-in & Connecting to Wireless Internet



STEP 5 - A "Sign Into Your Chromebook" pop-up will appear. Here you will type in your Student's ID/Lunch # (ex. 12345), then click Next.

STEP 6 - A pop-up asking for a password will appear. You will type in: stu (lowercase) and then your Student's ID/Lunch #

STEP 7 - You may see a "Welcome Agreement" pop up, scroll down (using the touch pad or down arrow key), click accept.

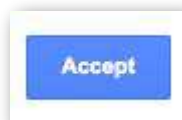

← Click ACCEPT

STEP 8 - Congratulations, you're in!!!