

MONTEZUMA-CORTEZ MIDDLE SCHOOL

STUDENT HANDBOOK

2021-22



Home of the Panthers

“We believe optimal student achievement (academic and behavior) can be attained by utilizing a proactive systems approach for creating and maintaining a safe and effective learning environment.”

WELCOME TO M-CMS

Considerable effort has been spent in developing an educational setting at M-CMS that both nurtures and challenges students to achieve at a high level. Much of what each student needs to know and do is contained within the student handbook. Consequently, each student is **required** to sign and return the form acknowledging the contents of the handbook.

PBIS Behavioral Expectations

P R I D E

	P erseverane	R easonable	I ntegrity	D ependable	E mpathy
Learning Spaces	Set goals Give your best effort Focus your attention Ask for help Don't give up Wear a mask	Encourage others Listen to understand Respond appropriately Make learning a priority Maintain a safe physical distance	Do what is right Keep your word Own your mistakes Give credit where it's due	Arrive on time and prepared Participate in class activities Let others learn Wash hands frequently	Listen First Work to understand others' perspectives Treat others with respect Support others & yourself
Transition Spaces	Stay focused Maintain self control Keep moving Be orderly Wear a mask	Respond appropriately Practice politeness Move with awareness Keep your hands to yourself Maintain a safe physical distance	Do what is right Be safe Get there on time	Be where you're supposed to be Use appropriate volume Collect the materials you need Wash hands frequently	Be understanding Treat others with respect
Social Spaces	Give your best effort Be hopeful Have fun Find a solution Wear a mask	Treat others with respect Listen to understand Be fair Maintain a safe physical distance	Do what is right Respect others' space Clean up after yourself Use space appropriately	Keep your word Own your behavior Be where you're supposed to be Take the most direct route Wash hands frequently	Consider others' work Work to understand others' perspectives Treat others with respect Make others feel safe and welcome

<p>Performance Spaces</p>	<p>Practice patience Maintain self control Focus attention on the performance Wear a mask</p>	<p>Look for learning opportunities Match actions to expectations Respond appropriately Maintain a safe physical distance</p>	<p>Do what is right Respect others Own your behavior Be safe</p>	<p>Use appropriate volume Be where you're supposed to be Participate in activities Wash hands frequently</p>	<p>Support those performing Be positive Celebrate the success of others Encourage your peers</p>
<p>Digital Spaces</p>	<p>Focus attention on the task Troubleshoot difficulties Ask for help Wear a mask</p>	<p>Look for learning opportunities Match actions to expectations Know your audience Maintain a safe physical distance</p>	<p>Do what is right Use digital tools appropriately Give credit where it's due</p>	<p>Own your behavior Be where you're supposed to be Charge your chromebook</p>	<p>Work to understand others' perspectives Treat others with respect Be kind to yourself</p>
<p>Community Spaces</p>	<p>Practice patience Maintain self control Support a positive environment Wear a mask</p>	<p>Respond appropriately Listen to understand Be Fair Maintain a safe physical distance</p>	<p>Do what is right Respect others' space Clean up after yourself Use space appropriately</p>	<p>Keep your word Own your behavior Be where you're supposed to be Wash hands frequently</p>	<p>Consider others' work Work to understand others' perspectives Treat others with respect</p>

MONTEZUMA-CORTEZ MIDDLE SCHOOL CORE BELIEFS

BOARD OF EDUCATION MISSION STATEMENT AND BELIEFS

The mission of the Montezuma-Cortez School District is to prepare and motivate students to discover their abilities and become self-directed, responsible, thinking, contributing members of our modern multicultural society. The Board of Education believes that: (1) All students can learn and succeed, (2) Success breeds success, (3) Schools control the conditions for success, (4) The role of the school, along with parents and the community is to establish a commitment of excellence in education for our children.

ACCOUNTABILITY OF STUDENT PERFORMANCE FOR PROMOTION

M-CMS students are expected to apply themselves in their educational experiences as part of the process of becoming successful and competent citizens in our multicultural society. M-CMS staff closely monitors student performance and makes recommendations for summer school and academic placement based on what is best for each student.

STUDENT RESPONSIBILITIES

Students must come to class prepared to learn and to participate in the day's activities in order to perform at their best and to minimize class disruptions. This means that each student shall:

- Bring books, notebooks, tools/equipment needed for class.
- Pay lab fees and library fines on time.
- Complete and bring assigned work to every class.
- Use restroom facilities between classes.
- Bring his/her planner to each class.
- Understand and meet school expectations.

POSITIVE BEHAVIOR INTERVENTION SUPPORT (PBIS): M-CMS CORE

The core of any successful organization comes from the positive outlook of all participants. Here at M-CMS, we believe that celebrating the positive is much better than focusing on poor choices. Look at page 2 of the handbook for M-CMS' Behavioral Expectations. These expectations let our students know what is necessary for ultimate success. Take a moment to learn our expectations. It will be required for every student and staff member to know these by heart. We also have a reward point system that staff use to explicitly reward positive behaviors. These points may be used to purchase items from the PBIS Rewards Store as well as admit entry into special school functions such as assemblies and dances.

Social Emotional Learning (SEL)/Use of Restorative Practices-

M-CMS is guided by the **Second Step** curriculum principles of Social Emotional Learning. **Restorative Practices** assists in strengthening relationships between individuals as well as social connections within communities. We utilize Restorative Practices both proactively to build community and reactively to repair harm and wrong doing. SEL schools teach character education and use these practices in real situations at school and in the community. We will encourage students to use these "Action Steps" when working through a situation:

1. **Analyze** the situation.
2. **Brainstorm** options.
3. **Consider** each option.
4. **Decide** and **Do** the best option. (What might happen if I do this? Is it safe? How might people feel about it? Is it ethical?)
5. **Evaluate** if it works.
6. If necessary: **Figure** out another way.

Montezuma-Cortez Middle School is committed to developing the “whole child” emotionally as well as academically.

DISTRICT AND STATE STANDARDS – WHAT DRIVES OUR DIRECTION

READING AND WRITING

1. Students read and understand a variety of materials.
2. Students write and speak for a variety of purposes and audiences.
3. Students write and speak using conventional grammar, usage, sentence structure, punctuation, capitalization, and spelling.
4. Students apply thinking skills to their reading, writing, speaking, listening, and viewing.
5. Students read to locate, select, and make use of relevant information from a variety of media, reference, and technological sources.
6. Students read and recognize literature as a record of human experience.

MATHEMATICS

1. Students develop number sense and use numbers and number relationships in problem-solving situations and communicate the reasoning used in solving these problems.
2. Students use algebraic methods to explore, model, and describe patterns and functions involving numbers, shapes, data, and graphs in problem-solving situations and communicate the reasoning used in solving these problems.
3. Students use data collection and analysis, statistics, and probability in problem-solving situations and communicate the reasoning used in solving these problems.
4. Students use geometric concepts, properties, and relationships in problem-solving situations and communicate the reasoning used in solving these problems.
5. Students use a variety of tools and techniques to measure, apply the results in problem-solving situations, and communicate the reasoning used in solving these problems.
6. Students link concepts and procedures as they develop and use computational techniques, including estimation, mental arithmetic, paper-and-pencil, calculators, and computers, in problem-solving situations and communicate the reasoning used in solving these problems.

SCIENCE

1. Students understand the processes of scientific investigation and design, conduct, communicate about, and evaluate such investigations.
2. Physical Science: Students know and understand common properties, forms, and changes in matter and energy.
3. Life Science: Students know and understand the characteristics and structure of living things, the processes of life, and how living things interact with each other and their environment.
4. Earth and Space Science: Students know and understand the processes and interactions of Earth's systems and the structure and dynamics of Earth and other objects in space.
5. Students know and understand interrelationships among science, technology, and human activity and how they can affect the world.

HISTORY

1. Students understand the chronological organization of history and know how to organize events and people into major eras to identify and explain historical relationships.
2. Students know how to use the processes and resources of historical inquiry*.
3. Students understand that societies* are diverse* and have changed over time.

4. Students understand how science, technology, and economic activity have developed, changed, and affected societies throughout history.
5. Students understand political institutions and theories that have developed and changed over time.
6. Students know that religious and philosophical ideas have been powerful forces throughout history.

GEOGRAPHY

1. Students know how to use and construct maps, globes, and other geographic tools to locate and derive information about people, places, and environments.
2. Students know the physical and human characteristics of places, and use this knowledge to define and study regions and their patterns of change.
3. Students understand how physical processes shape Earth's surface patterns and systems.
4. Students understand how economic, political, cultural, and social processes interact to shape patterns of human populations, interdependence, cooperation, and conflict.
5. Students understand the effects of interactions between human and physical systems and the changes in meaning, use, distribution, and importance of resources.
6. Students apply knowledge of people, places, and environments to understand the past and present and to plan for the future.

M-CMS' STUDENT ATTENDANCE STANDARDS

M-CMS' ATTENDANCE BELIEFS

Continuity in the learning process, performing well on assessments and social adaptation are disrupted by excessive absences in both in-person and online learning platforms. Excused absences that are excessive jeopardize a student's status and may lead to administrative intervention. In most situations the work missed cannot be made up adequately. Students having good attendance generally achieve higher grades, enjoy school more and tend to be more successful as they continue their education.

****NOTE**:** If a student is absent during the school day, attendance, as a spectator, at extracurricular activities is not permitted without prior consent of an administrator.

ATTENDANCE COMPULSORY LAW

Parents must ensure that every child under their care and supervision, when of compulsory attendance age, receives adequate educational training and attends school regularly.

...“Every child who has attained the age of six years on or before August 1 of each year and is under the age of seventeen years, shall attend public school”... C.R.S. 22-33-104

Unexcused absences and trancies are counted toward the four (4) and ten (10) day absence rules as defined in C.R.S. 2233104 and C.R.S. 2233.107. A “habitually truant student” is any student of compulsory attendance age with four (4) unexcused absences in any one (1) month or ten (10) unexcused absences in any school year. Absence due to suspension is not counted toward this total.

ABSENCES

Parents need to verify a student's absence by telephone the day the student is absent. If that is not possible, the absence must be verified *within 24 hours* of the student's return to school or the

absence will be considered unexcused.

Parent notification will be made nightly for any unverified absences. Along with the nightly communication, parents will be notified of excessive unexcused absences via mail:

- Upon the 4th unexcused absence, a letter will be mailed to parents/guardians informing them that the student has four unexcused absences in one or more classes and asking them to arrange a meeting with the school administration to set up a plan of remediation. Please contact the office and set up this meeting.
- Upon the 6th unexcused absence, the parent/guardian will be notified in writing of the violation of the mandatory attendance law. Parents/guardians must meet with the Attendance Officer and set up a contract detailing what will be different and how this will affect the student's attendance.
- Upon the 10th unexcused absence, parent notification, and confirmation that the student is under the age of 17, the administration will recommend that the student be placed into the court system for non-compliance with Colorado state attendance laws. In this event, the District may petition the court and request the parent and student be made responsible for court costs and legal fees.

CHECK-OUT PROCEDURES

To keep everyone in the building safe, M-CMS is a single point entry school during regular school operating hours. When checking students out, you must come to the school in person with a photo ID and use the doors at the Rotunda Entrance. Only those individuals whose names are listed in PowerSchool will be allowed to check your child out of school. Students are not allowed off campus without an adult between the hours of 8:40 - 4:15 pm.

ABSENCES - EXCESSIVE EXCUSED

Colorado state attendance law requires that students of school age attend school to receive their education. It is known that students must be in the educational setting in order to acquire the knowledge that is necessary to be educationally competent; however, the Montezuma-Cortez RE-1 School District recognizes that there are situations that arise when the student must be absent, more specifically *Illness, Death in the Immediate Family, Emergency Professional Appointment, and Religious Ceremonies*.

The importance of attendance is shown through its use as a factor in a student's promotion to the next grade. A student having an exceedingly high number of excused absences should provide written verification as to any reason these absences would reasonably interfere with his/her ability to attend school (within 24 hours of the absence). Examples might include a doctor's excuse, professional appointment excuse, or death in the immediate family. All assignments missed due to excused absences must be made up at the rate of one day for each day missed. ***Absences for other reasons may be recorded as unexcused.***

Student success at M-CMS is taken seriously and our staff utilizes every means necessary to ensure students attend school. This may include telephone calls, home visits, and use of the courts. We realize that each case is different. Appeals may be submitted to a principal requesting permission for absences to be excused; whenever possible, this request needs to be done before the absence(s) occur. The administration's decision takes into account attendance, grades, and general performance at M-CMS.

M-CMS' STUDENT BEHAVIOR STANDARDS

STUDENT BEHAVIOR BELIEFS

Montezuma-Cortez Middle School beliefs originate with the idea that our entire staff is here to support our students. In doing so we ensure that we are providing a safe learning environment for all of our students. We make this happen through teaching and modeling the behaviors we expect our students to reflect. This approach creates a positive proactive environment identifying areas needing more support and focuses resources to provide all students with the best chance of academic and social growth. At M-CMS we have high academic and behavioral expectations for our students and by helping them develop more self-control we then see success in both areas. Expectations and consequences are clearly outlined in this handbook. Behavior is the responsibility of everyone in our building because when our students exhibit good behaviors, quality learning can take place. Therefore, our students are always expected to conduct themselves with regard to both their personal goals and with concern for others.

BEHAVIOR ON OR OFF SCHOOL GROUNDS

To insure the safety, welfare and morale of students and school personnel, student behavior both on and off campus will follow the disciplinary standards stated in this handbook or Colorado school law. Students who threaten the safety of staff members, students, and the security of the school will be subject to disciplinary action and may include referral to the proper authorities and/or to the superintendent for possible expulsion.

BEHAVIOR AT EXTRACURRICULAR ACTIVITIES

Students should attend and enjoy extracurricular activities such as games/concerts/plays, etc. and are expected to be in the event area watching or participating in the activity (not in the hallways and bathrooms). Being outside during events leaves students unsupervised so students should be in the building when events are happening. If this is not happening, students may be asked to leave the school grounds and if misconduct becomes habitual, the students will not be allowed to attend extracurricular activities for the remainder of the school year.

BEHAVIORAL REWARD ACTIVITIES

Students are continuously encouraged to demonstrate positive behavior at M-CMS and reward activities are scheduled periodically to recognize students who show this behavior consistently. Students who show positive behavior will have the opportunity to participate in special school activities, assemblies, reward days or dances. Positive school culture is not only developed through large group activities, but also with many positive supports that will celebrate individual student success.

DEFINITIONS OF CONSEQUENCES/BEHAVIORAL OUTCOMES

Out of Class Detention (OCD): Parents/guardians will be notified. Teachers shall be notified of a student receiving Out of Class Detention and will have one day's notice to prepare and collect materials to be completed by the student. A student assigned to Out of Class Detention shall report to the office at 8:40am with all necessary materials and textbooks for the day. He/She shall be assigned a designated location and will be expected to stay on task and complete all assignments provided by the teachers and administration. Throughout the day, students may be expected to complete restorative community/school service projects which enhance student growth and strengthen the school's climate. Note: A minimum of one day of OCD **may** be assigned with each OSS

Out-of-School Suspension (OSS): Parents/guardians will be notified. A student serving an Out-of-School Suspension shall be barred from the school grounds or attendance at any sponsored activity at Montezuma-Cortez Middle School. The student may be allowed to make-up any missed class work. It is the student's responsibility to complete all class work missed during the suspension. Teachers shall be notified of a student receiving Out-of-School Suspension and shall have one day's notice to prepare any materials to be completed by the student. The principal may assign Out-of-School Suspension from one to five days for violation of specific expectations. A re-entry meeting with administration, parent/guardian and student **may** be required before the student is allowed back in school. Each suspension will be followed by one day in the support room completing a restorative project in addition to classwork to ensure successful reintegration. This policy is not all encompassing and the administration will contact each students' parents if a suspension is required.

EXPULSION INTERVENTION MEETING:

When a student reaches three (3) total suspensions, an Expulsion Intervention Meeting (EIM) will be scheduled with the school principal. This is a meeting held at M-CMS with parents, student, and school/district administration. The purpose of this meeting is to inform the parent and student that a Discipline Review Hearing (DRH) may be scheduled if another suspension occurs as per the Habitually Disruptive Student Law and to review and implement interventions to help support the student in being successful behaviorally at M-CMS. A comprehensive behavior plan and contract will be put in place at this time.

HABITUALLY DISRUPTIVE STUDENTS

Colorado State Law defines a "Habitually Disruptive Student" as a student who is suspended three (3) times during a school year. The law requires that notice of each suspension is counted toward defining the student as "habitually disruptive" and a notice is given to the student's parent or legal guardian. The school is required, in cooperation with the student's parent or legal guardian, to develop a remedial discipline plan for a student after the first suspension and to review and modify the plan after the second suspension. (H.B. 961203).

Students suspended three (3) times for causing a material and substantial disruption in the classroom, on school grounds, in school vehicles, or at school activities or events during the school year, in violation of their individual remedial discipline plans, shall be declared habitually disruptive students. A disciplinary review hearing with the Review Board is mandatory for habitually disruptive students (File: JK Montezuma-Cortez School District Policy).

OUTCOMES FOR SPECIFIC VIOLATIONS OF EXPECTED BEHAVIOR

ABUSIVE/OBSCENE LANGUAGE, GESTURES OR MATERIAL

Possession of obscene materials, name-calling, or derogatory and/or obscene statements addressed to any person that may precipitate a disruption of the educational process or incite violence is not tolerated. Depending on the severity of the statement and how it disrupted students' ability to learn, consequences are determined by administration following school guidelines and communicated to parents.

ACADEMIC DISHONESTY OR PLAGIARISM

Dishonesty and plagiarism are shown through students not doing the appropriate level of work through stealing others' work, cheating on tests, or gaining an unfair advantage to the students' peers. Consequences for this offense are at the teacher's discretion and will include parent contact as well as loss of credit for the assignment. Administrative involvement may take place.

COMPUTER DAMAGE

Students are responsible for appropriate care and use of school computers. If damage occurs to a student's computer, repair or replacement will be the responsibility of the student and/or guardians. MCMS tech department will assess the damage and an invoice will be created.

DANGEROUS WEAPONS

A dangerous weapon is any object readily capable of causing injury or death. This definition includes items designed to represent or imitate an object or substance perceived by a reasonable person to be capable of causing injury or death, given the manner in which it is possessed, controlled, or used. Violation of the District's policy on dangerous weapons in the schools may result in OSS and/or recommendation for expulsion. Weapons will be confiscated.

DEADLY WEAPONS

In accordance with Colorado State Law, expulsion will be mandatory for carrying, bringing, using and/or possessing a deadly weapon without the authorization of the school or school district.

DIRECT/INDIRECT THREAT

Any threat made directly or indirectly to or about a staff member or another student will be investigated by administration. If a threat is confirmed, at the minimum, a Threat Assessment Screening conducted by the TA team, consequences will be determined on a case by case basis and will be communicated to parents by administration.

]

DRESS CODE: (per District Policy JICA)

THE FOLLOWING WILL NOT BE ACCEPTED:

- ✓ Anything deemed as inappropriate by the Principal
- ✓ Hats/Hoods worn in the building (Hats should be placed in a backpack at the beginning of the school day. They may be taken out for recess only but should not be worn in the building at any time).
- ✓ Sleeping attire, i.e. pajamas, blankets
- ✓ Trench coats of any style
- ✓ Sheer, tight, or short clothing, that is, skirts, shorts and dresses shorter than mid-thigh (no shorter than three inches above knee)
- ✓ Leggings need to be worn with a shirt or dress extended beyond the length of your finger tips.
- ✓ Halter tops, tube tops, fishnet clothing, muscle shirts and tank tops with a width of less than two inches
- ✓ Sunglasses, bandanas, headwear and heavy coats in the building (backpacks, headwear, heavy coats and jackets, and outerwear must be left in lockers during class time)
- ✓ Flip-Flops, bedroom slippers, or spiked heels (due to safety concerns when students use our many stairs)
- ✓ Clothing that exposes private parts of the body (i.e., stomach, buttocks, back, or breasts)
- ✓ Clothes worn in a "sagging/baggy" manner that poses a safety or security hazard or show underwear or skin. Pants are to be worn at waist level, belts must be worn in belt loops, and the waist and crotch of pants must fit
- ✓ Earbuds or headphones worn around the neck (These items are to be placed a backpack at the beginning of the school day)
- ✓ Any clothing, jewelry, or accessories that are sexually suggestive, obscene, disruptive, or that promote drugs, alcohol, tobacco, or violence

- ✓ Any clothing or jewelry worn for the purpose of making a social statement which causes a disruption
- ✓ Bandanas, chains or spiked accessories; any gang attire or grooming*

*See Gangs and Gang Activity for specific guidelines in this area.

The primary reason for the dress code is for safety; however, we wish to minimize disruptions to the educational process.

Students in violation of the dress code will be sent to the office. A parent will be contacted to bring appropriate replacement clothing. **The student is not allowed to return to class until he/she has fixed the dress code infraction.** Other clothing may be available if the parent is unable to bring clothing to school.

EARBUDS (personal wireless or with wires): Personal earbuds are to be placed in a backpack at the beginning of the school day. If they are seen, the policy on electronic devices will be followed as listed below. The school has earphones that can be borrowed in each class.

ELECTRONIC DEVICES: Students are allowed to bring electronic devices to school (cell phones, audio/video players) but **THEY MUST NOT BE A DISTRACTION TO THE LEARNING ENVIRONMENT. FOR THAT REASON, CELL PHONES WILL BE PLACED IN THEIR BACKPACK FOR THE ENTIRETY OF THE DAY. CELL PHONES ARE NOT PERMITTED AT ANY TIME IN CLASSROOMS, RESTROOMS OR HALLWAYS. IF THEY ARE SEEN, THEY WILL BE CONFISCATED AND A PARENT PICKUP REQUIRED.** ELECTRONIC DEVICES WILL BE ALLOWED DURING LUNCH/RECESS ONLY. SPEAKERS WILL NOT BE ALLOWED.

M-CMS is not responsible for any lost or stolen devices.

Level 1 (1st Offense) – Item is confiscated; item must be picked up in the office by the parent

Level 2 (2nd Offense) – Item is confiscated; item must be picked up in the office by the parent.

Parent/student contract required.

Level 3 (3rd Offense)– Item is confiscated; item must be picked up in the office by the parent. Item must be left in the office for the entirety of the school day

Students’ privacy and safety is vital to the culture we are developing at M-CMS, so we will do whatever it takes to make sure this happens. **Teachers may, at their discretion, require the use of electronic devices in their individual classrooms to meet specific district and state academic standards.**

****Note**** IF A STUDENT IS SENT OUT OF THE CLASSROOM FOR ANY BEHAVIORAL REASON, THE STUDENT WILL COME IMMEDIATELY TO THE OFFICE AND BE REQUIRED TO TURN OFF ANY ELECTRONIC DEVICE THEY MAY BE CARRYING AND PLACE IN THE POCKET HOLDER IN THE OFFICE TO BE HELD UNTIL THE STUDENT CAN SUCCESSFULLY RETURN TO CLASS OR PICKED UP BY PARENT. THIS EXPECTATION WILL ALSO BE IN EFFECT DURING OCD.

Laser pointers - because of the danger surrounding these devices, laser pointers will be confiscated and will **not be returned. This will be considered a Level 1 infraction; any additional infractions will result in an immediate consequence.*

EXTORTION, COERCION, OR BLACKMAIL

These are defined as obtaining money (or other objects of value) from an unwilling person through the use of force or intimidation. Parents are notified, as well as the proper authorities, and the student will receive an appropriate consequence.

FALSE ALARM/DIALING 911

Students willfully setting off a fire alarm, creating an emergency situation, or falsely calling “911”, are not only disciplined at school, but are also reported to the proper authorities. In all cases, parents are notified and assigned one day of OSS and time in the Support Room to complete a Restorative Project.

FALSE INFORMATION

Any student giving false identification or misinformation to any school personnel is assigned a consequence as determined by the administration.

FIGHTING

Physical violence (fighting) is an extremely severe act. It destroys an atmosphere of safety and security. M-CMS believes that there are many ways, outside of violence, to solve problems. We expect students to utilize them. A proactive approach is stressed and our staff works very hard to keep our students safe.

First Offense – Results in one (1) day OCD in the Support Room to complete a tier 1 Restorative Project. Once the project and classwork are adequately completed, the student may be released to return to class. Administration will notify parents. A RtI referral will be made to the Child Study Team (CST).

Second Offense – Results in one (1) day of Out-of-School Suspension (OSS) and one (1) day OCD in the Support Room to complete a tier 2 Restorative Project. Once the project and classwork are adequately completed, the student may be released to return to class. Administration will notify parents. A Remedial Discipline Plan and a Weekly Behavior Point Sheet will be created and signed by both parent and student.

Third Offense – Results in a two (2) day OSS and one (1) day OCD in the Support Room to complete a tier 3 Restorative Project. Once the project and classwork are adequately completed, the student may be released to return to class. Administration will notify parents and an Expulsion Intervention Meeting will be scheduled with the Principal, student, and parents. A comprehensive RtI Behavior Plan will be created and signed by all parties.

Next Offense- a request for a Disciplinary Review Hearing (DRH) in front of the District Hearing Officer will be scheduled. Suspension may be given until the hearing can be scheduled.

FIRECRACKERS AND EXPLOSIVE OR INCENDIARY DEVICES

Students possessing, distributing, selling, or discharging fireworks are subject to disciplinary action including detention, suspension, or recommendation for expulsion. Restitution for damages is sought when appropriate and the student may be referred to the authorities along with school wide consequences.

First Offense – Results in one (1) day OCD in the Support Room to complete a tier 1 Restorative Project. Once the project and classwork are adequately completed, the student may be released to return to class. Administration will notify parents. A RtI referral will be made to the Child Study Team (CST).

Second Offense – Results in one (1) day of Out-of-School Suspension (OSS) and one (1) day OCD in the Support Room to complete a tier 2 Restorative Project. Once the project and classwork are adequately completed, the student may be released to return to class. Administration will notify parents. A Remedial Discipline Plan and a Weekly Behavior Point Sheet will be created and signed by both parent and student.

Third Offense – Results in a two (2) day OSS and one (1) day OCD in the Support Room to

complete a tier 3 Restorative Project. Once the project and classwork are adequately completed, the student may be released to return to class. Administration will notify parents and an Expulsion Intervention Meeting will be scheduled with the Principal, student, and parents. A comprehensive RtI Behavior Plan will be created and signed by all parties.

Next Offense- a request for a Disciplinary Review Hearing (DRH) in front of the District Hearing Officer will be scheduled. Suspension may be given until the hearing can be scheduled.

For obvious safety reasons, matches and lighters are also prohibited, consequences may apply.

FOOD DELIVERIES TO STUDENTS

No food or drinks other than water are allowed on the pod or in the cafeteria. If you wish to supply a fast food/restaurant lunch for your child, we ask that you take them out to eat with you as these types of lunches will not be allowed in the cafeteria. This meets health/safety regulations of the county health department.

GAMBLING

Gambling in any form is not allowed on school grounds at any time. Students will be assigned at least a Restorative Project for the first offense; each subsequent time the severity of the consequence will get more severe.

GANGS AND GANG ACTIVITY

Definition: For the purpose of this policy a “gang” is any group of two or more persons whose purpose includes the commission of illegal acts or acts in violation of disciplinary rules of the Montezuma-Cortez Middle School.

Prohibitions: No student on school property or at any school-sponsored activity shall:

1. Wear, possess, use, distribute, display, or sell any clothing, jewelry, emblem, badge, symbol, sign or other items that evidence or reflect membership in, or affiliation with any gang and/or is representative of any gang.
2. Engage in any act, either verbal or nonverbal, including gestures or handshakes, showing membership or affiliation in any gang and/or is representative of any gang.
3. Engage in any act in furtherance of the interests of any gang or gang activity, including, but not limited to:
 - a. Soliciting membership in, or affiliation with any gang.
 - b. Soliciting any person to pay for “protection,” or threatening any person, explicitly or implicitly, with violence or with any other illegal or prohibited act.
 - c. Painting, writing, or otherwise inscribing gang-related graffiti, messages, symbols, or signs on school grounds. This may also include wearing of clothing and accessories that promote groups that have gang affiliation.
 - d. Engaging in violence, extortion, or any other illegal act or violation of school policy.
 - e. Soliciting any person to engage in physical violence against any other person.

Violation of Policy: Students who violate this policy shall be subject to the full range of school disciplinary measures in addition to applicable criminal and civil penalties.

HARASSMENT/HAZING/BULLYING/INTIMIDATING

This offense is defined as any willful act causing another student to be distressed (mentally or physically) while on or off school grounds. (Types of harassment are outlined below.)

Any student who feels that he/she is a victim of any harassment should immediately report the incident to any teacher or administrator of M-CMS. Allegations of harassment are investigated and appropriate measures are taken for both the victim and the offender. It will never be tolerated for a M-CMS student to be bullied or harassed.

THE STAFF CAN DO NOTHING IF THEY DON'T KNOW!!

****Safe2Tell is an anonymous hotline that students can call with information on behavior that is unsafe/harmful. The number is: 1-877-542-7233 or email: safe2tellco.org There is also an App on Apple Store/Google Play**

Sexual harassment: Any unwelcome verbal or physical conduct of a sexual nature, requests for sexual favors, or other unwelcome sexual advances is considered sexual harassment. Sexual harassment can be as blatant as rape, as obvious as telling dirty jokes or using vulgar language, or as subtle as a look. It can occur with opposite or same sex persons. It can occur from adult to student, student to student, or student to adult.

Bullying: When intentionally cruel verbal, social, or physical abuse happens from one student to another student or to an adult it is considered bullying. Bullying usually consists of repeated offenses but can also consist of one incident.

Physical bullying: Includes hitting, pinching, or kicking the victim. It can also involve taking or damaging the victim's property.

Verbal bullying: Includes using words to hurt or humiliate another. It can involve name-calling, insulting, making social comments or constant teasing.

Cyber bullying: Includes the use of social media sites, email and texting to threaten, intimidate or humiliate another student or group of students. Videotaping fights is also another form of this type of bullying. If these incidents happen off campus or after hours but directly impact the educational environment in any way, M-CMS administration has the ability to investigate and assign disciplinary consequences. If proven, cell phone privileges will be suspended for the remainder of the year as well as the standard harassment consequence.

Relational bullying: Includes excluding or rejecting another from social activities or connections, and purposely leaving others out at the encouragement of another student.

Reactive victims: Includes those who intentionally encourage a bully to harass them so as to provoke the bully into action, fight back, and claim self-defense.

Intimidation: Bullying or any action from another that causes the student to feel threatened or fearful; physical or verbal abuse is intimidation.

Abuse: Any physical or verbal action, from another that causes emotional or physical pain is considered abuse. Behavior can be blatantly cruel or subtly unkind.

Hazing: Any participation in the persecution of others by rough practical jokes, forced or demeaning acts or tasks, physical or verbal abuse for the entertainment of others will be considered hazing.

The Montezuma-Cortez Middle School takes a strong stand on the issue of bullying. Students who are found to be engaging in this behavior shall be assigned the following consequences.

Actions taken:

First Offense – Results in one (1) day OCD in the Support Room to complete a tier 1 Restorative Project. Once the project and classwork are adequately completed, the student may be released to return to class. Administration will notify parents. A RtI referral will be made to the Child Study

Team (CST).

Second Offense – Results in one (1) day of Out-of-School Suspension (OSS) and one (1) day OCD in the Support Room to complete a tier 2 Restorative Project. Once the project and classwork are adequately completed, the student may be released to return to class. Administration will notify parents. A Remedial Discipline Plan and a Weekly Behavior Point Sheet will be created and signed by both parent and student.

Third Offense – Results in a two (2) day OSS and one (1) day OCD in the Support Room to complete a tier 3 Restorative Project. Once the project and classwork are adequately completed, the student may be released to return to class. Administration will notify parents and an Expulsion Intervention Meeting will be scheduled with the Principal, student, and parents. A comprehensive RtI Behavior Plan will be created and signed by all parties.

Next Offense- a request for a Disciplinary Review Hearing (DRH) in front of the District Hearing Officer will be scheduled. Suspension may be given until the hearing can be scheduled.

INSUBORDINATION/ DISRESPECT/NON-COMPLIANCE

Students who willfully fail to respond to reasonable requests made by any adult employed in the school are considered insubordinate. These students will be sent to the principal immediately. Direct disrespect will result in an immediate and reasonable consequence.

Actions Taken:

First Offense – Results in one (1) day OCD in the Support Room to complete a tier 1 Restorative Project. Once the project and classwork are adequately completed, the student may be released to return to class. Administration will notify parents. A RtI referral will be made to the Child Study Team (CST).

Second Offense – Results in one (1) day of Out-of-School Suspension (OSS) and one (1) day OCD in the Support Room to complete a tier 2 Restorative Project. Once the project and classwork are adequately completed, the student may be released to return to class. Administration will notify parents. A Remedial Discipline Plan and a Weekly Behavior Point Sheet will be created and signed by both parent and student.

Third Offense – Results in a two (2) day OSS and one (1) day OCD in the Support Room to complete a tier 3 Restorative Project. Once the project and classwork are adequately completed, the student may be released to return to class. Administration will notify parents and an Expulsion Intervention Meeting will be scheduled with the Principal, student, and parents. A comprehensive RtI Behavior Plan will be created and signed by all parties.

Next Offense- a request for a Disciplinary Review Hearing (DRH) in front of the District Hearing Officer will be scheduled. Suspension may be given until the hearing can be scheduled.

PHYSICAL AGGRESSION

Any behavior done with the intent to harm or with a malicious intent will be considered physical aggression.

Actions Taken:

First Offense – Results in one (1) day OCD in the Support Room to complete a tier 1 Restorative Project. Once the project and classwork are adequately completed, the student may be released to return to class. Administration will notify parents. A RtI referral will be made to the Child Study Team (CST).

Second Offense – Results in one (1) day of Out-of-School Suspension (OSS) and one (1) day OCD

in the Support Room to complete a tier 2 Restorative Project. Once the project and classwork are adequately completed, the student may be released to return to class. Administration will notify parents. A Remedial Discipline Plan and a Weekly Behavior Point Sheet will be created and signed by both parent and student.

Third Offense – Results in a two (2) day OSS and one (1) day OCD in the Support Room to complete a tier 3 Restorative Project. Once the project and classwork are adequately completed, the student may be released to return to class. Administration will notify parents and an Expulsion Intervention Meeting will be scheduled with the Principal, student, and parents. A comprehensive RtI Behavior Plan will be created and signed by all parties.

Next Offense- a request for a Disciplinary Review Hearing (DRH) in front of the District Hearing Officer will be scheduled. Suspension may be given until the hearing can be scheduled.

PUBLIC DISPLAY OF AFFECTION

Students are not to hold hands, kiss, passionately embrace, or display any other inappropriate physical contact with one another at school or on school grounds. As this behavior is not appropriate in the educational setting, we insist that students please keep all interaction appropriate and respectful.

ROUGH PLAY, INCLUDING SHOVING, SLAPPING, KICKING

Students need to understand that when they play around in a rough manner, it can do nothing but cause difficulty for all participants. This behavior easily can turn into more than students playing around. Our goal would be for students to play in ways where there is no physical contact; we encourage students to have fun and treat each other with respect and dignity. If a student does choose to play rough (without malicious intent) he/she will have consequences.

Actions Taken:

First Offense – Results in one (1) day OCD in the Support Room to complete a tier 1 Restorative Project. Once the project and classwork are adequately completed, the student may be released to return to class. Administration will notify parents. A RtI referral will be made to the Child Study Team (CST).

Second Offense – Results in one (1) day of Out-of-School Suspension (OSS) and one (1) day OCD in the Support Room to complete a tier 2 Restorative Project. Once the project and classwork are adequately completed, the student may be released to return to class. Administration will notify parents. A Remedial Discipline Plan and a Weekly Behavior Point Sheet will be created and signed by both parent and student.

Third Offense – Results in a two (2) day OSS and one (1) day OCD in the Support Room to complete a tier 3 Restorative Project. Once the project and classwork are adequately completed, the student may be released to return to class. Administration will notify parents and an Expulsion Intervention Meeting will be scheduled with the Principal, student, and parents. A comprehensive RtI Behavior Plan will be created and signed by all parties.

Next Offense- a request for a Disciplinary Review Hearing (DRH) in front of the District Hearing Officer will be scheduled. Suspension may be given until the hearing can be scheduled.

STEALING/THEFT

Theft of personal or school property will not be tolerated. Students will be assigned at least a Restorative Project for the first offense to be completed along with missing class assignments in the Support Room; each subsequent time the severity of the consequence will get more severe and can be referred to law enforcement if necessary.

SUBSTANCE ABUSE

Expulsion is mandatory for the distribution of drugs or controlled substances in accordance with state law. Montezuma-Cortez School District RE-1 shall promote a healthy environment for students by providing education, support, and decision making skills, in regard to alcohol, drugs and other controlled substances and their abuse. In order to accomplish this goal, a cooperative effort must be made among the schools, parents, community and its agencies. It shall be a violation of Board policy and considered to be behavior that is detrimental to the welfare, safety, or morals of other students or school personnel for any student to possess, use, sell, distribute, procure, or to be under the influence of alcohol, drugs or other controlled substances. For purposes of this policy, controlled substances include, but are not limited to: narcotic drugs, hallucinogenic or mind-altering drugs or other substances, amphetamines, barbiturates, stimulants, depressants, marijuana, anabolic steroids, any other controlled substances as defined by law, or any prescription or nonprescription drug, medicine, vitamins or other chemical substances not taken in accordance with Board policy and regulations on administering medicines to students. ***This policy also includes substances that are represented by or to the student to be any such controlled substance or what the student believes to be any such substances.*** This policy shall apply to any student who is on school property, in attendance at school, in a school vehicle, or taking part in any school sponsored or sanctioned activity, or whose conduct at any time or place interferes with the operations of the district or the safety or welfare of students or employees.

Students violating this policy shall be subject to disciplinary sanctions including suspension and/or expulsion from school. In all cases the student is referred to law enforcement. Situations in which a student seeks counseling or information from a professional staff member for the purpose of overcoming substance abuse shall be handled on an individual basis depending upon the nature and specifics of the case. When appropriate, parents are involved and every effort is made to direct the substance abuser to sources of help.

It is recommended that students who have difficulties with possible substance abuse be evaluated, at the parents' expense, by a qualified individual to determine the best intervention moving forward. The following are entities that may help: Cortez Addiction Recovery Service (CARS), 970-565-4109, and TOWAOC Treatment Services, 970-564-5701.

Actions Taken: (In all cases of possession of a controlled substance or paraphernalia, a referral to Law Enforcement will be made)

First Offense – Results in one (1) day OCD in the Support Room to complete a tier 1 Restorative Project. Once the project and classwork are adequately completed, the student may be released to return to class. Administration will notify parents. A RtI referral will be made to the Child Study Team (CST).

Second Offense – Results in one (1) day of Out-of-School Suspension (OSS) and one (1) day OCD in the Support Room to complete a tier 2 Restorative Project. Once the project and classwork are adequately completed, the student may be released to return to class. Administration will notify parents. A Remedial Discipline Plan and a Weekly Behavior Point Sheet will be created and signed by both parent and student.

Third Offense – Results in a two (2) day OSS and one (1) day OCD in the Support Room to complete a tier 3 Restorative Project. Once the project and classwork are adequately completed, the

student may be released to return to class. Administration will notify parents and an Expulsion Intervention Meeting will be scheduled with the Principal, student, and parents. A comprehensive RtI Behavior Plan will be created and signed by all parties.

Next Offense- a request for a Disciplinary Review Hearing (DRH) in front of the District Hearing Officer will be scheduled. Suspension may be given until the hearing can be scheduled.

TOBACCO VIOLATION

When a student is found using, possessing, or distributing any tobacco product (this includes vape pens), Students will be assigned at least a Restorative Project for the first offense to be completed along with missing class assignments in the Support Room; each subsequent time the severity of the consequence will get more severe.

TRUANCY

Truancy is defined as being absent from class. In order for learning to take place students need to be in class. If a student misses class or is late more than **5 minutes** into a class period, they will be considered truant. Truancy is very serious and is handled with that level of importance. The school and parents have expectations of the student's whereabouts and when a student endangers themselves by not being in school or class it must be handled accordingly. Consequences for off-campus truancy will start at step three. On campus truancy will be handled as stated below:

Actions Taken:

First Offense – Results in one (1) day OCD in the Support Room to complete a tier 1 Restorative Project. Once the project and classwork are adequately completed, the student may be released to return to class. Administration will notify parents. A RtI referral will be made to the Child Study Team (CST).

Second Offense – Results in one (1) day of Out-of-School Suspension (OSS) and one (1) day OCD in the Support Room to complete a tier 2 Restorative Project. Once the project and classwork are adequately completed, the student may be released to return to class. Administration will notify parents. A Remedial Discipline Plan and a Weekly Behavior Point Sheet will be created and signed by both parent and student.

Third Offense – Results in a two (2) day OSS and one (1) day OCD in the Support Room to complete a tier 3 Restorative Project. Once the project and classwork are adequately completed, the student may be released to return to class. Administration will notify parents and an Expulsion Intervention Meeting will be scheduled with the Principal, student, and parents. A comprehensive RtI Behavior Plan will be created and signed by all parties.

Next Offense- a request for a Disciplinary Review Hearing (DRH) in front of the District Hearing Officer will be scheduled. Suspension may be given until the hearing can be scheduled.

TARDIES

Tardiness is defined as the appearance of a student without a proper excuse after the scheduled time that a class/home-room begins. *STUDENTS ARE TARDY IF THEY ARE NOT IN THEIR SEATS OR ASSIGNED WORK AREA WHEN CLASS IS SCHEDULED TO BEGIN.* Students will be assigned at least a Restorative Project for the first offense to be completed along with missing class assignments in the Support Room; each subsequent time the severity of the consequence will get more severe and Administration will work with the student and parents to create an Attendance Contract.

UNPREARED

Unprepared is defined as a student not having the required materials to successively engage in classroom work. Teachers will attempt to help students when appropriate; however, it is the student's ultimate responsibility to be ready to succeed at M-CMS.

GUM CHEWING

Students are allowed to chew gum at M-CMS. Gum is to be chewed and disposed of appropriately. Inappropriate use will result in consequences.

VANDALISM

Any student willfully marking, defacing, damaging, or destroying property belonging to another person or the school district is referred to the proper authorities. Depending on the severity and circumstances the student may also face disciplinary and legal actions and be required to make restitution. For this reason all staff shall confiscate permanent markers. **PERMANENT MARKERS (SHARPIES, ETC.) ARE NOT ALLOWED FOR ANY REASON!** The consequence for having a permanent marker can range from Lunch Detention or other more severe consequences.

IMPORTANT STUDENT AND FAMILY INFORMATION

CONTACT DIRECTORY

Superintendent of Schools	Mrs. Risha VanderWey	565-7282 ext. 1115
M-CMS Principal	Mr. Drew Pearson	565-7824 ext. 3113
Secretary to the Principal	Mrs. Kristy Aiken	565-7824 ext. 3112
Assistant Principal	Ms. Beth Benavidez	565-7824 ext. 3111
Secretary to the Assistant Principal	Mrs. Carrie Comisky	565-7824 ext. 3142
Assistant Principal/Athletic Director	Mr. Matthew Holmes	565-7824 ext. 3126
Secretary to the Athletic Director	Ms. Joni Anderson	565-7824 ext. 3127
Counselor 8th	Mrs. Robyne Cote	565-7824 ext. 3140
Counselor 7th	Ms. Carrie Schneider	565-7824 ext. 3115
Counselor 6th	Mrs. Logan Worley	565-7824 ext. 3118
Guidance Secretary/Registrar	Mrs. Sarah Fox	565-7824 ext. 3114
Nurse	Mrs. Cami Oster	5657-824 ext. 3116
Media Specialist	Mrs. Edsy Collins-Randels	565-7824 ext. 3232
School Resource Officer	Officer Jerry Sam	565-7824 ext. 3129
M-CMS Fax		565-5120

ACCESS TO RECORDS

In accordance with Colorado state law parents/guardians are guaranteed the right to access their student's school records and may do so by contacting the counseling office or administration. Montezuma-Cortez School District RE-1 utilizes PowerSchool to collect and organize student's academic, attendance, and discipline data. This program can be accessed by parents and guardians via our school district's website, www.cortez.k12.co.us. Parents and Guardians will need an individual username and password, which can be obtained through M-CMS's main office.

ANIMALS

Animals are not allowed at school. An administrator may approve exceptions for special projects.

ANNOUNCEMENTS

Morning announcements will be made each morning; students will be informed of upcoming events along with other important information.

AREAS OFF LIMITS

M-CMS is a closed campus. Students shall not be on school grounds until 15 minutes before the first bell unless they are enrolled in a sports program or before-school activity. If a teacher requests that a student come to his/her classroom prior to this time, the student must have a pass signed by the teacher. Students are asked to leave the campus by 4:15pm unless involved in sports or other activities. No students are allowed into the pod areas after 4:15pm unless supervised by a staff member. The campus is not supervised before 8:20am and after 4:15pm.

BICYCLES, SKATEBOARDS, HOVERBOARDS, ETC.

Students are NOT PERMITTED to ride skateboards, hoverboards, roller skates, roller blades, or bicycles in the recess area at any time. This is the area designated by the white lines. Student Bicycle racks are located on the southwest side of the building for securing bicycles during school hours. No shoes containing wheels may be worn to school. M-CMS is not responsible for lost or stolen property.

CAMERAS

Montezuma-Cortez Middle School has many surveillance cameras throughout the campus. They are used to ensure the safety of Montezuma-Cortez Middle School's staff and students.

CHECK IN/CHECK OUT PROCEDURES

Students and/or parents must check-in at the security office when a student arrives late to school. Students are expected to be in their classrooms before class begins at 8:50am. The student checkout sheet is located in the security office. Any parent coming to visit for any reason must sign in at the security office and have a valid pass displayed at all times as they move through school. **Only parents, legal guardians or emergency contact individuals may remove students from campus and MUST PERSONALLY SIGN THE STUDENT OUT OF SCHOOL. Students may not get verbal permission over the phone to leave campus or be excused from classes to attend other activities at the middle school.**

CLOSED CAMPUS

Montezuma- Cortez Middle School is a closed campus. Students are not to leave campus unless checked out through the security office by a parent, legal guardian, or emergency contact individuals. Students who ride the bus may not leave campus after exiting the bus or before getting on the bus before returning home. any student who is off campus during the school day without being properly checked out will be considered truant.

DRINKS

Water is the only drink allowed on the pod. Soft drinks and energy drinks of any kind are discouraged and will not be allowed at any time during the school day. These types of drinks will be discarded, if opened or placed in the office for pick up at the end of the day.

DELIVERIES TO STUDENTS

Flowers or packages will not be delivered to students during class. The student will be notified when there is an item in the office and can be retrieved after school. **NO OUTSIDE FOOD OR BEVERAGES (SONIC, McDONALD'S, ETC.) WILL BE ACCEPTED FOR DELIVERY TO STUDENTS.**

DRUG ALERT DOGS

Periodically, M-CMS will utilize drug/contraband sniffing dogs to ensure a safe and a drug free school zone. The dog's handlers access any and all school areas and classrooms. If contraband is found parents and police are notified and charges are filed.

EATING/DRINKING IN CLASSROOMS

Food and/or drinks in the classroom or hallway are not allowed unless tied to an educational objective.

EMERGENCY PLAN

Montezuma-Cortez Middle School has developed an emergency preparedness plan that is executed in a sequential manner according to the type of emergency. This emergency plan contains two levels of alert in the event that emergency situations arise at school, LockDown and LockOut. During this level of alert, classrooms, inside doors and outside doors are secured. The second level of alert dictates that students are held in classrooms with no interruption to the educational process. Staff and administration are assigned specific responsibilities for the purpose of maintaining the safety of all students. Students are trained on the procedures and drills that take place during the school year to practice them.

FIRE DRILL

Students will remain in seats quietly listening for a report on the School Safe radios, then everyone will exit the building in an orderly fashion.

HALL PASSES

All students not in their regular assigned classroom MUST have a hall pass indicating day, time of departure, destination, and a teacher's signature.

HONOR ROLL

The Honor Roll at Montezuma-Cortez Middle School is made up of students maintaining a 3.0 or higher grade point average during each nine-week grading period. This list is submitted to the Cortez newspaper for publication and is available in the counseling office. Any student making a 4.0 or higher grade point average is considered a "Straight A" student.

IMMUNIZATION/STUDENT HEALTH

Students transferring either to or from another school district must have a copy of their immunization record in order to enroll. Providing written verification of immunization to school officials prior to enrolling is a Colorado State Law and no exceptions are permissible. Also, parents are encouraged to have physical and dental examinations for their school-aged child before entering school and again before the 4th, 7th, and 10th grades. Parents/guardians may opt out of routine, non-emergency screenings provided by the district. Current screenings may include: hearing, vision, dental, height, and weight. Please contact your school nurse if you do not want your child to participate in these screenings.

JURISDICTION OVER STUDENTS

All officials, employees, and authorized agents of the school with responsibilities involving the supervision of students, shall stand "*in loco parentis*" (in place of the parent) with regard to students they are required to supervise at any time the responsibility of supervision exists. This authority applies whenever students are lawfully subject to the school's control, regardless of place. During such periods students shall have the duty to submit to the school's authority.

LOCKERS

Lockers are not issued to students. Students are to use a backpack to carry their school items to each class.

LOST or STOLEN ITEMS

Montezuma-Cortez Middle School is not responsible for lost or stolen property. **This includes personal property (i.e., electronic devices) as well as books or materials either assigned to or checked out by the student.**

NAME/ADDRESS/PHONE NUMBER OF STUDENT

Students must use their legal name for school records. Students may not use nicknames or assumed names. Students with hyphenated last names **MUST** use all parts of the hyphenated name. For any name changes, a legal document indicating the same must be presented to the counseling office. We must have a current and valid mailing address (and residence if P.O. Box) and a valid working phone number for contacting parents and guardians. We also must have names and phone numbers for any other contact persons in case of an emergency. Parent(s) or guardian(s) must provide the school with the names and phone numbers of any other persons who might be asked to pick up their child from M-CMS.

PASSING BETWEEN CLASSES

Since most academic classes are located close together very little time is needed in passing from one class to the next. Students should only need to use their lockers before school begins, before and after lunch, and at the end of the school day.

PARENT/ TEACHER CONFERENCE DATES

A Parent/Teacher or Student-led Conference is the bridge of communication between teachers and parents. It is extremely important we have this component to ensure the success of the student. Montezuma-Cortez Middle School schedules two (2) (See District Calendar) Parent/Teacher Conferences each year. Notification to the parent is made well in advance so parents are aware of dates and times and can make plans to attend.

PROGRESS REPORTS

Within several weeks after the start of each quarter teachers will distribute Progress Grade reports to all students. Due to the high cost of mailing, these reports are not mailed home. Students are responsible for taking their progress report home to their parents and having the bottom portion signed and returning it to the team. Progress reports may be sent more frequently when requested by parents. Additionally, parents are encouraged to contact teachers regularly about student progress.

HOMEWORK

Parents should expect approximately 60 minutes of homework per evening on most school days.

REQUEST FOR HOMEWORK

If a student is absent they should log onto their Google Classroom to find out what they missed. They can also schedule a time to meet with their teachers to go over any missing assignments or questions they may have.

SCHEDULE CHANGES

A student is scheduled into classes after school officials have thoroughly checked a student's records and previous school performances. A student's welfare is the first consideration in the event that a schedule change is requested or needed. There are no schedule changes after the quarter/semester begins except in rare cases at the discretion of the administration.

SCHOOL DANCES

The following student guidelines pertain to attendance at school-sponsored dances:

1. Students will use PBIS Reward Points to attend each dance.
2. Individuals not enrolled at Montezuma-Cortez Middle School will not be admitted to any dance.
3. Clothes exhibiting good taste and in accordance with the school dress code are to be worn unless otherwise specified by the sponsoring organization.
4. No beverages are brought inside.
5. Unruly or disrespectful students are sent out of the building if the dance is in the evening.
6. Parents are always encouraged to attend school dances.

SCHOOL PHONE

School phones are business phones and are to be used for business only. Students may bring cellphones to school but they are not to be used freely except at lunch and recess. Students may use the office phone before and after school as well as during lunch. They may also use the phone if they have a pass from their teacher.

SCHOOL PICTURES

All students are photographed in the fall of the year. These photos are used for the school yearbook. Parents are given the opportunity to order a photo package (with payment made in advance) at that time.

SOLICITATION FOR DONATIONS

At no time are students permitted to solicit support or donations for non-school fundraising.

STUDENT GRIEVANCE PROCEDURE

The constitutional rights of individuals assure their protection by due process of law; therefore, this system of constitutionally and legally sound procedures is developed with regard to the administration of discipline in the Montezuma-Cortez School District. The student will be given an opportunity to contest the facts which may lead to disciplinary action, to contest the appropriateness of the sanction imposed by a disciplinary authority, or to allege prejudice or unfairness on the part of the school district employees responsible for a disciplinary action. The following procedure will govern such grievances:

1. The student and his/her parent or guardian will first discuss the problem with the staff member involved.
2. If an acceptable solution cannot be reached, the student and his/her parent or guardian may discuss the problem with the school principal, who may involve other individuals as he/she deems necessary.
3. If the matter is not resolved, the student and his/her parent or guardian may appeal the matter to the Assistant Superintendent, who may involve other individuals as he/she deems

necessary.

4. If the matter is not resolved, the student and his/her parent or guardian may appeal the matter to the Superintendent who may involve other individuals as he/she deems necessary.
5. If this conference fails to result in a satisfactory solution, the matter may then be appealed through the Superintendent of Schools and the Board of Education to be discussed in an executive session.

The Board of Education is the final authority in all cases. Any hearing before the School Board will observe all the rights of the student and his/her parent or guardian to present the problem to the Board of Education. Notice of the hearing will be given to the student.

STUDENT INSURANCE

Parents should maintain private health insurance for their child. The School District does not insure students injured on the school grounds. Every student is given an application for student accident insurance at registration. If a child is involved in an accident, and if he/she is covered by the student accident insurance, a claim form may be requested from office personnel and must be filled out and mailed to the insurance office immediately following the accident. Students involved in extracurricular activities must show proof of having accident insurance (specifically, a policy number must be on record) prior to participation in that activity.

SUSPENDED/EXPELLED AND TRUANT STUDENTS

Truant, suspended, and expelled students may not attend school activities. Additionally, suspended and expelled students are *not allowed on district property*. Suspended students may return to school only after their parents have reviewed and signed the required remedial discipline plan with their child. Students who have been expelled or alternatively placed are not allowed on campus and may not attend any activities.

TEXTBOOKS AND LIBRARY BOOKS

Textbooks are provided free of charge for student use. All textbooks are the property of the district and must be kept in good condition. **Students are responsible for all textbooks issued to them.** If a textbook is lost or excessively damaged during the school year the student will be required to pay the price of the book before being issued another one, the cost of individual textbooks range from \$20.00 to \$65.00.

Library books are the property of Montezuma-Cortez Middle School. Students have the privilege of checking out books for their own use but are then responsible for their maintenance and return. Fees assessed for damaged or lost library books must be paid before a student is permitted to check out other materials. State law provides that educational records may be withheld until textbook and library fines have been collected.

WITHDRAWAL FROM SCHOOL

Completion of the withdrawal process of a student from M-CMS is necessary before a student can enroll in another school. Parents must initiate a withdrawal request in the Counseling Office. The parent/student obtains a withdrawal form and takes it to all teachers and departments as indicated on the form. Teachers and staff record current grades and whether textbooks, library books, and other supplies have been returned. This form also requires signatures from the parent, registrar, and a principal. This form then returns to the Counseling Office where all costs for lost, stolen, or damaged books, or other supplies, or any remaining fees and fines must be paid. Records of transferring students are released to receiving schools as a matter of normal practice. Montezuma-Cortez Middle School will not release

records to other schools without written consent from the student's parent. School transcripts and grades will not be released until all fines, fees, and/or costs are paid. In the last two weeks of school we will not withdraw students due to the school's responsibility to assess student growth and make sure all information is available for the family and the next school district the student attends.

EXTRACURRICULAR ACTIVITIES

Extracurricular Activities are an important part of helping students become well rounded and productive in the community. There are many different opportunities for all students from chess club to football and volleyball. Some of these activities have little or no cost; however, many of our varsity sports will have an activity fee of \$50.00 with football having an additional cost of \$10.00. Please check with the Activities Department to determine the activity fee for each activity. The number of participants will be limited in varsity sports, i.e. volleyball, three teams, football, two teams, basketball, three teams.

SPORTS AND ACTIVITIES ELIGIBILITY

Students must meet eligibility requirements to participate in athletics. *Eligibility is based both on academic performance and behavior.*

ACADEMIC ELIGIBILITY POLICY:

Montezuma-Montezuma-Cortez Middle School will choose to check academic eligibility weekly.

1. Beginning on the first Wednesday of each season, and **every Wednesday** subsequently, grades for each student involved in an activity or athletic program will be printed and given to each activity sponsor and/or coach. **These grades will serve as a warning to coaches** that students are failing 1 or more classes. It is the responsibility of the sponsor/coach to inform their students about each of their grades.
2. On the second Monday of each season and **every Monday** subsequently, the grades of each student involved in an activity or athletic program will again be printed, and given to each activity sponsor and/or coach. **If, on this grade report, a student has 1 or more F's, that student will be ineligible to participate in any school sponsored extracurricular activity or athletic event until grades are checked again on the following Monday. Students are still required to attend all mandatory practices and team events.** There will be no exceptions to this requirement, unless a valid human error or unforeseen circumstance takes place, which will be considered on a case by case basis.
3. If the F(s) is removed from the student's grade report by the following Wednesday grade report, that student will once again be eligible to participate; however, if said student still has an F on their report card, they will continue to be ineligible.
4. Attendance guidelines are still applicable for school and practice for ineligible students.

BEHAVIORAL ELIGIBILITY POLICY:

Montezuma-Montezuma-Cortez Middle School will monitor behavioral eligibility daily.

1. Students are expected to maintain behavioral standards as outlined in the students handbook at all times while participating in school activities or athletics. This includes, before, during and after practices or games while on school property, on the bus to and from practices or games, and at all points while on trips for school events or competitions.
2. **Students assigned to a half day (4 periods) or more of Out-of-Class Detention (OCD) during the season will be ineligible to participate in the next event or competition** following the infraction.
3. **Students who are assigned Out-of-School Suspension (OSS) during the season will miss the next 40% of the season** (total number of regular season games multiplied by 0.4) following the infraction. This includes post season play (ie. If there are 10 games in the season and the student is suspended with only two games left in the regular season, they will miss the last two games, and if the team qualifies for post-season play, they would not be eligible to play in the first two games).

2021-22 ACTIVITIES AND SPORTS PROGRAM

The following sports and activities are included during the school year at Montezuma-Cortez Middle School. These sports and activities are available to students enrolled at Montezuma-Cortez Middle School. Some programs require fees and/or sports physicals.

SCHOOL SPORTS

Boys Basketball (7th and 8th)
 Girls Basketball (7th and 8th)
 Football (7th and 8th)
 Girls Volleyball (7th and 8th)
 CO-ED Wrestling (7th and 8th)
 Boys and Girls Track (6th, 7th and 8th)
 Boys and Girls Cross Country (6th, 7th and 8th)

ACTIVITIES

YearBook	Jazz Band
Tutoring	Knowledge Bowl
Blood Drives	Mentorship Program
Dances	Culture Club
Computers	Science Fair
Enrichment Classes	Student Council
Food Drives	Youth Art Month
Geography and Spelling Bee	Technology
Health Fair	Rainbow Alliance Group

USE OF VIDEO RECORDERS ON SCHOOL BUSES

The district has installed recording equipment on some school buses to monitor school transportation and will be videotaping on bus routes randomly during the school year. These buses are equipped with a video monitor box in which a video-recording device may be installed. Students are not notified when a recording device has been installed on their bus. The Transportation Director views the tapes routinely and documents evidence of student misconduct. Students found violating the district's bus conduct rules are notified and disciplinary actions are initiated under RE-1 Board's "Code of Conduct and Discipline". Videotapes are treated as protected student records under the Family Educational Rights and Privacy Act and the following guidelines apply:

- ✓ Tapes will remain in the custody of the transportation supervisor unless subpoenaed in court.

STUDENT SERVICES

CAFETERIA

Students may bring their own lunch from home and keep it in their locker until lunchtime. Ala-carte items are available and there is an accounting system allowing students to prepay for school lunches. Forms for free or reduced meals may be picked up in the cafeteria or from the counseling office. The ala-carte items range from \$.35 to \$1.50 in price whether the student qualifies for free or reduced lunch or not. Ala-carte items must be purchased with cash or from the students' lunch account. The lunch staff is not responsible for how students spend their money. There is no federal or state law mandating that a district serves a meal to a child not having sufficient funds to purchase a meal. RE-1 District policy for paid and reduced lunches allows a student to charge up to three (3) meals.

CAMPUS SECURITY

The RE-1 School Board in conjunction with the Cortez Police Department provides a full-time School Resource Officer (SRO) for M-CMS/MCHS throughout the school year. This officer can be reached at 565-7824. Additionally, both indoor and outdoor surveillance cameras are installed to aid in monitoring the campus. In specific situations Montezuma-Cortez Middle School's administration reserves the right to use a metal detecting wand for school safety.

GUIDANCE OFFICE AND COUNSELING PROGRAM

The Guidance Department includes counselors and a registrar and handles all record keeping, such as student enrollment, withdrawal, scheduling, emergency contact information, cumulative educational records, immunizations, grades, fines, and coordination of standardized testing.

The M-CMS counseling program is intended to benefit all students by working with students in a variety of ways, both individually and in groups*. Counselors present classroom guidance lessons for all students on topics related to academic achievement, personal/social development, and career development. Required curriculum on bully prevention and character education is incorporated into classroom presentations.

Counselors may help students with scheduling and academic issues, problem-solving skills, conflict resolution, or crisis intervention. Students may be referred to a counselor by parents, teachers, administrators, or may come in on their own. Unless it is an emergency students must arrange with a classroom teacher if needing to come to the guidance office during class time. Students violating the school's discipline policy may be referred to the guidance office for follow-up, such as mediation, assignment to a counseling group, development of individual plan, or referral to other resources. Follow-up is based on student need.

**Signed parent permission is required for group counseling or for any on-going personal counseling. It is not required for one-time contacts or interventions such as mediation, crisis response, or academic consultation. Please contact the Guidance Department for more information about counseling services or to request a parent permission form.*

Montezuma-Cortez School District RE-1 Tuition Rates for Charter/Online/Homeschool Students

Effective August 16, 2021

Charter/Online School Students

-Tuition rate for credit classes = \$125 per class, per semester/trimester. Tuition is paid by Charter/Online School to Montezuma-Cortez School District RE-1. No tuition will be charged for extra-curricular activities. Individual class/activity fees will be charged at regular in-district rate. Individual class/activity fees are paid by student/parent/guardian to Montezuma-Cortez School

District RE-1 tuition/fees collected and utilized at the individual school level, under the direction of the school principal.

Charter School tuition/fees will be specified in the annual purchase service agreement.

Payment for students enrolled prior to October 1st will be due by October 15th Payment for students enrolled after October 1st will be due within 30 days of enrollment

Homeschool Students -Tuition rate for credit classes = \$125 per class, per semester/trimester. Tuition is paid by student/parent/guardian to Montezuma-Cortez School District RE-1. No tuition will be charged for extra-curricular activities. Individual class/activity fees will be charged at regular in-district rate. Individual class/activity fees are paid by student/parent/guardian to Montezuma-Cortez School District RE-1. If a student is registered to attend an RE-1 school for 90 Semester hours during the annual October Count, then no tuition will be charged as the district will be eligible for state PPOR. If a student is not registered to attend an RE-1 school for 90 semester hours during the annual October Count, then all tuition charges will be applicable as the district will have missed the opportunity to collect state PPOR. Tuition/fees will be collected and utilized at the individual school level, under the direction of the school principal. Payment for students enrolled prior to October 1st will be due by October 15th. Payment for students enrolled after October 1st will be due within 30 days of enrollment

HEALTH SERVICES

HEALTH AND NURSING SERVICES

Please visit the RE-1 website at the link below for more Nursing and Health Services Information including many forms including the following:

- Health Survey Questionnaires
- Health Services Information
- Health Plan for Allergies
- Asthma Care Plan
- Medication at School Form
- Self Carry Medicine Contract
- How Sick is Too Sick information for school attendance
- Sports Physical Letter
- Immunization Information/Letters for Parents

<https://www.cortez.k12.co.us/departments/health-policies-and-documents>

First Aid/Illness: Students needing medical attention shall report to the health room or main office. Health service personnel are not always available in the building. Keep contact information up to date so we can reach you quickly if your child becomes sick or injured. Students with fever, vomiting or diarrhea should stay home until they are symptom-free for 24 hours.

Accidents at School: Anyone involved in or witnessing an accident in which injury or potential injury has occurred should seek the nurse's assistance immediately. If there is any question regarding the

condition of an accident victim, those present should leave the person stationary, stay with him or her and send someone to get the nurse.

Medications at School:

ALL MEDICATION SHALL BE SECURELY STORED IN THE MAIN OR HEALTH OFFICE.

When possible, please administer medication at home. Medication administration in the school setting is under the direction of the school registered nurse.

****Prescription Medication:** Students requiring prescription medication administration in the school setting must have a Medication Authorization Form signed by the physician and parent. The medication must be in its original pharmacy issued container.

****Over-The-Counter Medication:** Comfort medicine (Tylenol, ibuprofen, antacid tablets, calamine lotion, bacitracin, and cough drops may be given if parents have signed the “medicine permission consent” on the Health Screening Questionnaire in the registration packet.

****Emergency Medication:** Students who need to carry asthma inhalers, epi-pens, or diabetic supplies at school may do so as long as there is a Health Care Action Plan signed by a health care provider on file in the health office. Health Care Plans for Severe Allergies, Diabetes, Asthma, and Seizures are available from the school nurse, or on the district website below.

Immunization Requirements: Colorado State Immunization Requirements for School Enrollment are provided to parents annually. Non-medical (religious/personal) exemptions must be updated annually. Forms are available on-line or from your school. This school utilizes the Colorado Immunization Information System (CIIS), a confidential, secure, statewide immunization registry. You may choose to exclude your child’s shot information from CIIS at any time. Please contact your school nurse for further information.

Permission for Health Advisory/Need to Know: School nurses develop a Student Health List and/or a Health Care Action Plan from the Health Screening Questionnaire in the registration packet. All information is confidential and is shared only on a need-to-know basis. Alert your school nurse if you do not want your student’s medical information shared with appropriate school personnel.

Permission for Emergency Care: In the event of a medical emergency, the Montezuma-Cortez School Department will render emergency aid and/or transportation to a medical facility as needed. Costs incurred are at the expense of the family. Every effort will be made to contact the family in such a situation. If this practice concerns you, contact the school administrator. Please keep emergency contact information current with the school.

Screenings/Physical Exams: Parents/guardians may opt out of routine, non-emergency screenings provided by the district. Current screenings might include: hearing, vision, dental, lice, height and weight. Contact your school if you do not want your child to participate in these screenings. Parents are encouraged to have physical and dental examinations for their school-aged child before entering school and again before the 4th, 7th and 10th grades. Contact your school nurse if you do not have a health care provider and would like to arrange a physical exam for your child.

Lice: We do not exclude students from school if lice or nits are found. We do educate and support parents as they work to remove lice and nits from their students. Please contact your school nurse if you suspect your student has a lice infestation so we can help. Teach your child to use only his/own comb, brush, hair ornaments, hats and coats. Sharing these items is a common way for lice to move from one person to another. For sleep-overs, send your child with their own pillow and sleeping bag.

Student illness can affect siblings, classmates, and teachers. For privacy reasons, we do not typically send notes to all students in a classroom when a student is diagnosed with a specific illness. Here is a guide to follow for when to keep your student home with illness. Always consult your health care provider for additional information.

Symptom	Exclusion Guidelines
Cough	Exclusion is recommended if the child is experiencing severe uncontrolled coughing or sneezing, having difficulty breathing, becomes red or blue in the face, makes high-pitched whooping sounds after coughing or vomits after coughing.
Diarrhea (defined as stools that are more frequent and looser than usual)	Exclusion is recommended if any of the following conditions apply: the child has other symptoms along with the diarrhea (such as vomiting, fever, abdominal pain, jaundice, etc.) the diarrhea cannot be contained in the toilet, there is blood or mucous in the stool, or the child is in diapers.
Earache	No exclusion is necessary unless there is fluid or blood dripping from the ear
Fever (defined as a temperature over 101 F orally)	No exclusion is necessary , unless the child has symptoms in addition to the fever, such as a rash, sore throat, vomiting, diarrhea, behavior changes, stiff neck, difficulty breathing, etc.
Headache	No exclusion is necessary, unless the headache is severe and accompanied by additional symptoms like vision problems, stiff neck, or behavior change.
Mouth sores	Exclusion is recommended if the child is drooling uncontrollably
Open wounds	Open wounds must be covered at school either by clothing or bandage
Rash	Exclusion is recommended if the child has symptoms in addition to the rash such as behavior changes, fever, joint pain, or bruising not associated with injury, or if the rash is oozing or causes open wounds. The school nurse may recommend exclusion of student with rash who are not immunized for vaccine-preventable diseases.
Stomach ache /abdominal pain	Exclusion is recommended if the pain is severe, if the pain appears after an injury, or if the child had symptoms in addition to the stomach ache (such as vomiting, fever, diarrhea, jaundice, etc.)

Vomiting	Exclusion is recommended if the child has vomited more than two times in 24 hours, if the vomit appears bloody, if the child has a recent head injury, or if the child has symptoms in addition to the vomiting (such as fever, diarrhea, etc.)
----------	---

How to help your child stay healthy:

- Make sure your child has fruits, vegetables, and water in their diet and gets at least 8 hours of sleep each night to strengthen their ability to fight illness
- Teach your child to wash hands before eating, after using the bathroom and when they come home from school

How to prevent the spread of illness:

- Teach your child to cover the cough (into upper arm, not into hands), and to wash hands after sneezes or using Kleenex
- Instruct your child not to share drinking cups or containers with family members or friends.

Accident Insurance: Student accident insurance information forms are available in the front office and should be mailed directly to the insurance company. Any student who misses the initial application period, may apply at any time during the school year. These forms are available in the front office. All students involved with M-CHS sponsored athletics must have appropriate insurance coverage.

ASBESTOS MANAGEMENT

Asbestos Management plans have been formulated for every RE: 1 building. Those plans are available for review by staff, parents, and the general public at the Administration Building, 400 N Elm St, Cortez, CO, or at any of the occupied buildings.

STAFF PERSONAL SECURITY AND SAFETY

The following procedures shall be followed in instances of assault, disorderly conduct, harassment, knowingly false allegation of child abuse, or alleged criminal offense by a student directed towards a teacher or school employee. An act of a teacher or other employee shall not be considered child abuse if the act was an appropriate expression of affection or emotional support.

These same procedures shall be followed in instances of damage by a student to the personal property of a teacher or school employee occurring on school district premises.

1. The teacher or employee shall file a complaint with the building principal, the superintendent's office and the Board of Education.
2. The principal, after receipt of both of the complaints and adequate proof of the charges, shall suspend the student for three days in accordance with established procedures.
3. The superintendent shall initiate procedures for the further suspension or expulsion of the student when injury or property damage has occurred.
4. The superintendent or his designee shall report the incident to the county's district attorney or the appropriate local law enforcement agency or officer who shall then investigate the incident to determine the appropriateness of filing the criminal charges or initiating delinquency proceedings.

5. A copy of this policy shall be distributed to each student and posted in each school building.

Communication of disciplinary information

The principal or designee shall communicate discipline information concerning any student enrolled in the district to all teachers and counselors who have direct contact with the student. Any employee who is assigned a student with known serious behavior problems will be informed of the student's behavior record. Any teacher or counselor who is provided this information shall maintain its confidentiality and shall not communicate it to any other person.

LEGAL REFS: C.R.S. 19-3-304 (3.5), (4)

DISTRICT NOTIFICATIONS

ASBESTOS NOTIFICATION

Colorado Regulation No. 8 requires yearly notification of related asbestos activities that have occurred in the past year or will occur before the next notification. All Montezuma-Cortez RE-1 buildings are in compliance with these regulations.

The Maintenance Department checks all asbestos or presumed asbestos areas every six months. Re-inspections are conducted every 3 years by a certified inspector.

A copy of the management plan can be found in the principal's office of each school building. Asbestos management plans for all schools are also kept in the maintenance building.

The re-training of custodians and maintenance personnel for asbestos awareness is done annually. This is required as long as there is asbestos in any school building where personnel work, per Colorado Regulation No. 8 Asbestos.

ASSESSMENT:

The district administers a variety of state tests to help our teachers better understand your child's academic needs and progress. You will receive information on your child's performance (achievement and growth) on those tests including, but not limited to:

- READ Act assessments for grades K-3
- Colorado Measures of Academic Success (CMAS) for grades 3-8
- ACCESS for English language learners
- P-SAT, and SAT for High School students

Parents are encouraged to reach out to their child's teachers or the principal with any questions about these assessments or their child's performance. Parents wishing to opt out of any of these tests need to schedule an appointment with the principal to make that request.

BOARD POLICY

The Board of Education sets district policies upon recommendation from the superintendent. Many policies have a set of procedures, which are approved by the superintendent. Each policy and procedure is thoroughly reviewed by the appropriate staff before making any recommendations to the superintendent or board.

Policies adopted by the board can be found on the district website or directly from the link below. Specific policies are also available upon request from the Administrative Assistant to the Superintendent and Board of Education at 400 N. Elm St. Cortez, Colorado 81321. Additional information or support can be found by calling your school or the district administrative offices at 970-565-7282.

<https://www.cortez.k12.co.us/our-district/board-of-education/policies>

ENGLISH LANGUAGE LEARNERS

The district offers programming and supports to support English language learners in becoming proficient in English and in participating in the content of their classes. If your child is identified as an English language learner then a committee composed of your child's teacher/s, the district Title III/English as a Second Language (ESL) coordinator work together to design a Program Services Plan for your children. Your children will be provided with a Program Services Plan which:

- a. provides for an English language instructional program that will meet your child's strengths and areas of need,
- b. outlines how your child will learn English and meet age appropriate academic achievement standards,
- c. explains the method/s of instruction used in your child's program, and how these differ from the instruction received by other children in the same school in terms of content, instructional goals, and use of English and a native language in instruction,
- d. specifies the academic and language exit requirements and the expected amount of time to transition from this LEP instructional program to the regular non-LEP instructional program at the school,
- e. (only for students with disabilities) describes how this instructional program will meet the objectives of the individualized education plan (IEP) of your child,

We encourage our families with home languages other than English to be involved in their children's education. We offer translation and interpretation services as needed. Please contact Trina Lee at the district office to request translation or interpretation services if needed.

FOOD SERVICE

The district will operate school lunch and breakfast programs in its schools which shall be under the overall supervision of the Nutrition Services Director. Food services shall include lunches and breakfasts, through participation in the National School Lunch Program and the School Breakfast Program. The School Board approves the prices set for meals. Breakfast is served free to all elementary students attending schools that participate in Breakfast After the Bell programs.

All families have the opportunity to apply for the free and reduced meal program. Applications can be obtained from the school office or cafeteria at the beginning and throughout the year and submitted for eligibility consideration. Charging is not allowed for meals.

PARENT AND FAMILY ENGAGEMENT

- **Parent engagement and activities:** Parents are encouraged to participate in various school activities including volunteering in the school, attending parent and family nights and student performances.
- **Parent input into school programs:** Parents and guardians are strongly encouraged to attend meetings in order for the school to share information about the performance of the school. These opportunities include School Accountability Committee meetings to review Unified Improvement and 90-Day Plans as well as parent committees that assist in fundraising, volunteering or other activities.

Please watch for announcements on these events in your school's newsletter and website.

SCHOOL PERFORMANCE

The state provides a report card on the performance of your child's school every year. You can find information about this report card on the school's website under the Academics Tab under School Performance. Parents and families are also encouraged to talk with their child's teachers regularly and attend parent teacher conferences to learn about their child's progress.

TEACHER QUALIFICATIONS

Parents and guardians are entitled to information regarding the qualifications of the teachers in their school. If desired, please call your school's office and ask for an appointment with your principal to talk about the qualifications of your child's teacher or paraprofessional.

More information is available at: <https://www.cde.state.co.us/fedprograms/essaeducator>

School Bus Safety Rules:

1. **Leave home early enough to arrive at your bus stop on time.**
Be at the school bus stop **5** minutes before the scheduled pick-up time and stay there.
RESPECT private property at the stop location.
2. **Wait for your bus in a safe place (well off the roadway)**
Behave correctly as you wait in the designated area and never play in the road. **NEVER** rush toward a moving bus. **Never** approach from the back of the bus to load.
3. **Enter your bus in an orderly manner. Take your seat promptly.**
When the driver opens the door, get on immediately and go directly to your seat.
4. **Seats may be assigned at the discretion of the driver.**
5. **Follow the instructions of your school bus driver.**
Always be cooperative with your driver and follow the rules of the bus. It will be at the discretion of each driver whether they will permit food or drinks.
*The following are **not** allowed on the school bus: **Animals (living or otherwise), glass containers, items that might take up a seat of another rider and NO skateboards.***
6. **Bullying of any kind is not permitted and will be considered a major infraction. The bus may be equipped with video surveillance.**

7. Remain in your seat while your bus is in motion.

Standing, kneeling on the seats, or facing the rear of the bus are unsafe riding positions and **not** allowed. The correct and safest position is **seated facing forward** with your back against the seat back cushion. Changing seats while the bus is in motion is **NOT** permitted. This is a safety issue.

8. Keep your body parts inside the bus at all times. Throwing objects in or out of the bus is not permitted.

Serious injury could result from being struck by an object.

9. Keep the aisles clear. Vandalism is not permitted and is a major infraction.

Feet, legs, arms, and bodies, as well as books, bags, lunch pails, instruments and all the other 'stuff' must be kept out of the aisle. All trash must be thrown in the trash can.

10. Remain quiet and orderly.

Always use a quiet voice. Shouting or any loud noise is **not** acceptable. A low noise level is imperative for the safest driving conditions. **Abusive language, profane or obscene language is not acceptable.**

11. Be courteous to your school bus driver and fellow passengers.

Avoid roughhousing/physical play. Pushing, grabbing, hitting, and throwing objects are dangerous and are not permitted. **Fighting or the possession of a weapon in any form, or flame/spark producing device is forbidden.** The possession or use of any tobacco product, alcohol, or drugs is also forbidden.

12. Exit in a proper manner.

Be alert to traffic as you leave the bus.

Wait for the driver's command 10 ft to the front and right of the bus before crossing the roadway.

NEVER exit through the emergency exit, unless instructed to do so by the driver.

13. There MUST be a person present to receive all kindergarten and first graders at your p.m. drop off location. Have a Happy and SAFE school year.

"Please read and discussed the bus rules with your child and agree to follow them"

<u>ADMINISTRATION</u>		<u>EXCEPTIONAL STUDENT SERVICES</u>	
Drew Pearson	Principal	Matt Johnson	6th grade ESS/Affective Needs
Beth Benavidez	Assistant Principal	Cindy Bedingfield	7th grade ESS
Matthew Holmes	Activities Director/Assistant Principal	Lex Anderson	8th grade ESS
<u>6A</u>		Chase Wesley	Life Skills I (6,7,8)
Laura DeBoer	Language Arts	Robert Moy	Life Skills II (6,7,8)
Emily Mohr	Math	Morgan Nichols	Affective Education
Mario Davidson	Science	Alyssa Vialpando	ESS Paraprofessional
Michelle Waltman	World Studies		ESS Paraprofessional
<u>6B</u>		Kathleen Whitlock	ESS Paraprofessional
Sally Monahan	Language Arts	Katy Orr	AE Paraprofessional
Cathy Cowan	Math	Neva Stephens	AE Paraprofessional
Joe Magie	Science	Laurie McGuire	Life Skills II Paraprofessional
Rita Tripp	World Studies	Billy Randall	8th grade Paraprofessional
<u>7A</u>		Melvina Charles	7th grade Resource Paraprofessional
Rhea Gillespie	Language Arts	Robert Monahan	6th grade Resource Paraprofessional
Melanee Cullinane	Math	Cindee Gapp	Support Room
Beth Howell	Science	Anna Crites	ELL Paraprofessional
Devin Wills	World Studies	<u>ENRICHMENT/ELECTIVE TEAM</u>	
<u>7B</u>		Melinda Martinez	Family & Consumer Science
Jean Bramely	Language Arts	Joey Schricte	Physical Education
Matt Keefauver	Math	Amanda Robinson	Health
Karen Hebert	Science	Marla Sitton	Vocal Music
Conner McCue	World Studies	Andrew Campo	Band
<u>8A</u>		Angela Gabardi	Theater
Lissa Lycan	Language Arts	Keri Mustoe	Technology
Autumn Hanberry	Math		Art
Kori Grose	Science	Edsy Collins-Randels	Media Center Paraprofessional
Tyson Wood	World Studies	Cory Madsen	Career and College Enrichment
<u>8B</u>			World Language
Forrest Kohere	Language Arts	Annette Nielson	6th grade Choir
Kathy Clark	Math	Julie Engel	Reading Interventionist
Brittany Lang	Science		Math Interventionist
Michael Olson	World Studies	<u>OFFICE STAFF</u>	
<u>COUNSELING SERVICES</u>		Kristy Aiken	Principal's Secretary
Logan Worley 6th	Counselor	Joni Anderson	Athletic Secretary
Carrie Schneider 7th	Counselor	Carrie Comisky	Asst. Prin. Secretary
Robyne Cote 8th	Counselor	Michelle McDaniel	Security Secretary
Sarah Fox	Registrar	<u>CUSTODIAL STAFF</u>	
Monica Slabodnick	Check/Connect Mentor	Rick Jones	
<u>NURSING</u>		Glen Kyle	
Kammi Oster, R.N.	Nurse	Ray Vialpando	
<u>SCHOOL RESOURCE OFFICERS</u>		Walter Parker	
Jerry Sam	School Resource Officer	<u>FOOD SERVICES</u>	
		Delanie Whitmer	
		Christine Borgen	
		Juanita Kee	
		Grayce Frohock	
		Clairlene Filfred	

--	--

MONTEZUMA-CORTEZ MIDDLE SCHOOL

LOWER FLOORS

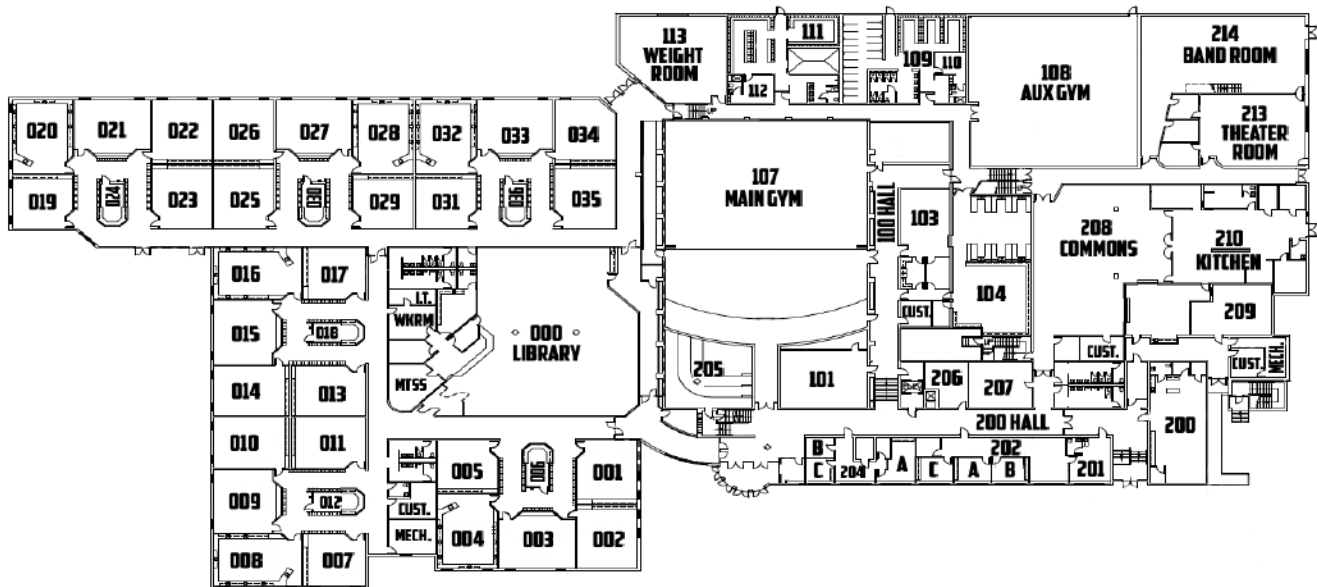

UPPER FLOORS

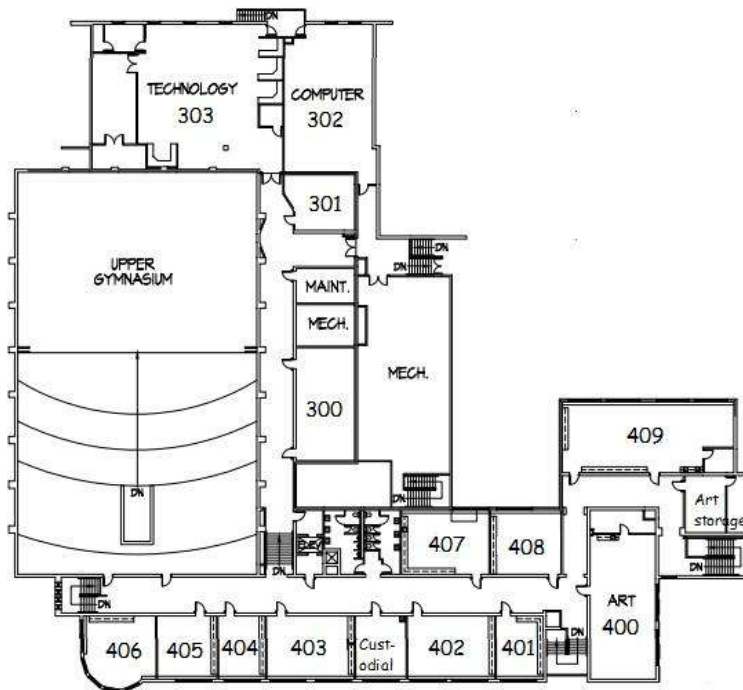

**2019/2020 M-CMS HANDBOOK
ACKNOWLEDGMENT**

Student's Name _____ **Grade** _____

Parent's Name _____
(Please Print)

Email address (Vital Information)

I have reviewed the Montezuma-Cortez Middle School Student Handbook including the school's attendance, behavior, and promotion policy. I understand that it is my responsibility to read and understand this handbook and the policies as outlined and then accept the provisions therein. A complete copy of Montezuma-Cortez RE-1 district policies is available at the central office and online at www.cortez.k12.co.us Going to the district website will also allow you to access this handbook. Once on the website, click on schools and go to the M-CMS webpage.

Signature of M-CMS Student _____ **Date** _____

Signature of Parent _____ **Date** _____